

Drawing Location: C:\Users\Sarah.Garvey\Documents\Cotswolds VIP 21006866 - Geomatics\01 DM Plans\2024\06\14_21006866_PLN_INFO_913.1\2024\06\14_21006866_PLN_INFO_913.aprx

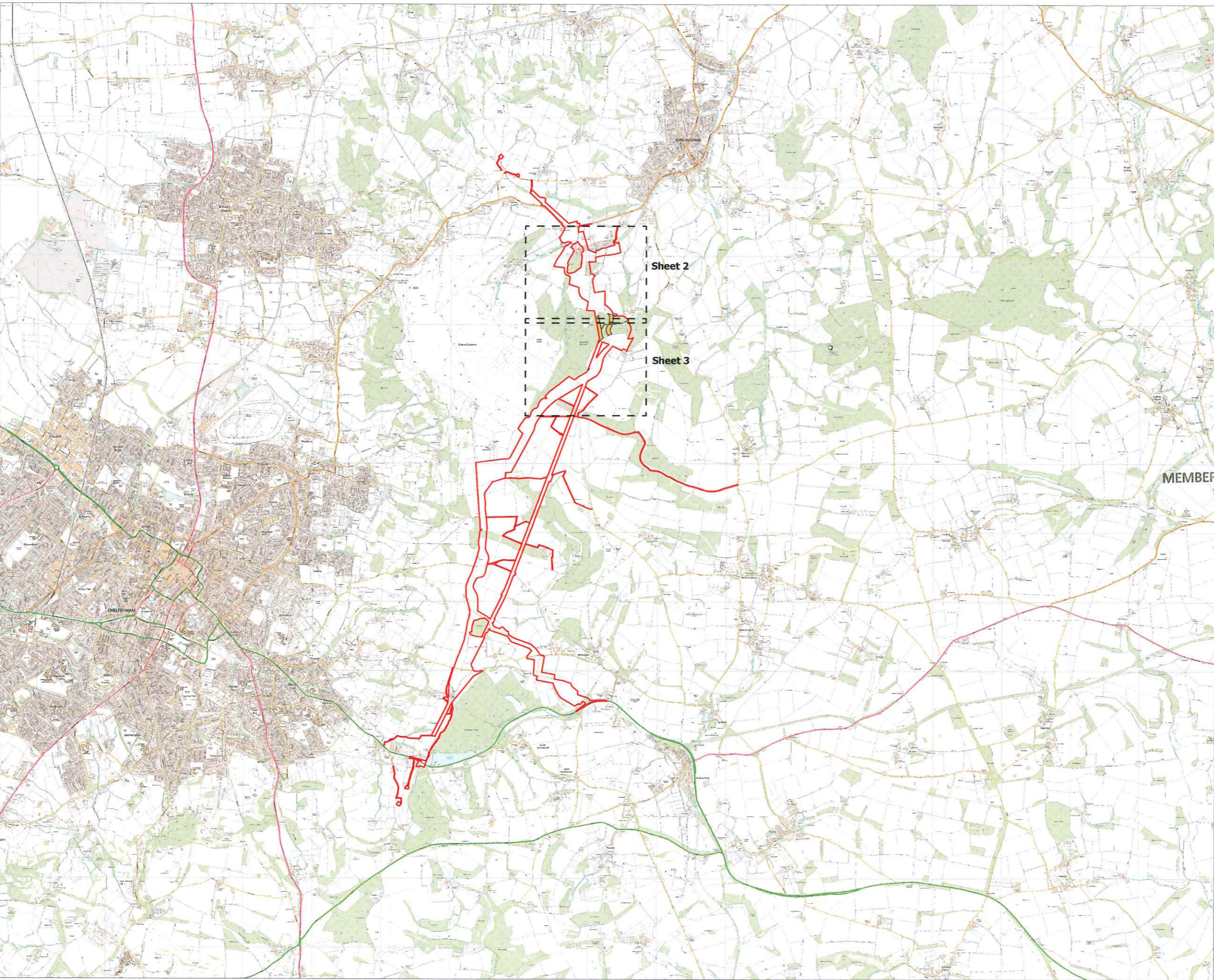

- Key:
- Order Limits
 - The Forestry Commission

Notes:

MS
08/04/2025



NGA 13036

MEMBER OF THE BOARD SEALING COMMITTEE

Coordinate System: British National Grid
Projection: Transverse Mercator
Datum: OSGB 1936

Interest:

Location:
Padcombe Bottom, Tewkesbury,
Gloucestershire, GL54 5AN

Coords: 401265, 223594

Scheme Name:
Cotswold VIP

Drawing Name:
Crown Land Map referred to in The National Grid Electricity
Transmission plc Cotswolds Visual Impact Provision
Compulsory Purchase Order 2025 - Land Plan Overview
Drawing No: 21006866_PLN_INFO_913.1_B

Rev	Date	Description
-	03.07.2024	First Issue
A	25.09.2024	Amended Plots
B	27.03.2025	Order Limits

Drawn: AM
 Approved: OK
 Sheet No: 1 of 3
 Sheet Size: A3



nationalgrid

Plan produced on behalf of National Grid Electricity Distribution.
BASED UPON THE ORDNANCE SURVEY MAP WITH THE SANCTION
OF THE CONTROLLER OF HIS MAJESTY'S OFFICE.
CROWN COPYRIGHT RESERVED. © OS LICENCE No. 100024241

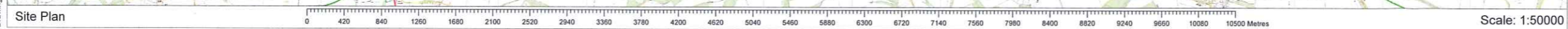

Site Plan

Drawing Location: C:\Users\Sarah.Garvey\Dalcoeur\Dalcoeur\Cotswolds VIP 21006866 - Geomatics\01 DM Plans\2024\0814_21006866_PLN_INFO_913_130240514_21006866_PLN_INFO_913.aprx

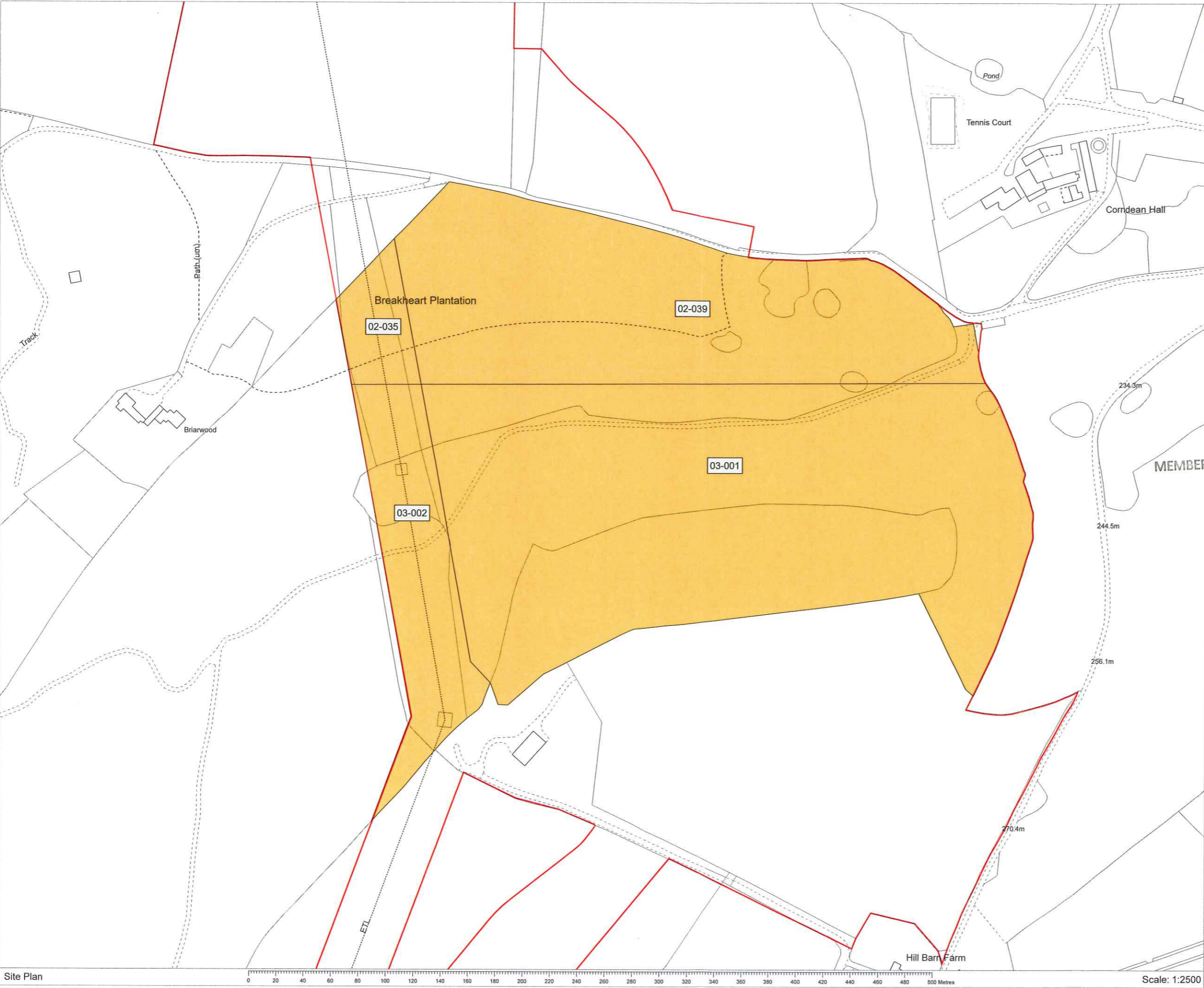

Key:
Order Limits
The Forestry Commission

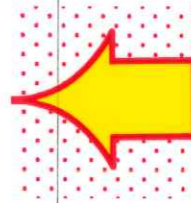

Notes:
[Signature]
08/04/2025



NGET 13036
MEMBER OF THE BOARD SEALING COMMITTEE

Coordinate System: British National Grid
Projection: Transverse Mercator
Datum: OSGB 1936

Interest:
Forestry Commission

Location:
Cheltenham Road, Winchcombe, Langley,
Tewkesbury, Gloucestershire, GL54 5BB

Coords: 401291, 225968

Scheme Name:
Cotswold VIP

Drawing Name:
Crown Land Map referred to in The National Grid Electricity
Transmission plc Cotswolds Visual Impact Provision
Compulsory Purchase Order 2025 - Land Plan 1 of 2
Drawing No: 21006866_PLN_INFO_913.2_B

Rev	Date	Description
-	03.07.2024	First Issue
A	25.09.2024	Amended Plots
B	27.03.2025	Order Limits

Drawn:	AM	
Approved:	OK	
Sheet No:	2 of 3	
Sheet Size:	A3	

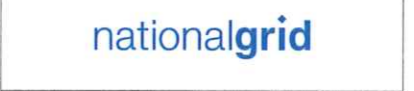

Plan produced on behalf of National Grid Electricity Distribution
BASED UPON THE ORDINANCE SURVEY MAP WITH THE SANCTION
OF THE CONTROLLER OF HM STATIONERY OFFICE
CROWN COPYRIGHT RESERVED. © OS LICENCE No. 100024241

Drawing Location: C:\Users\Sarah.Garvey\Dalour Maclaren\Cotswolds VIP 21006866 - Geomatics\01 DM Plans\2024\0614_21006866_PLN_INFO_913.aprx

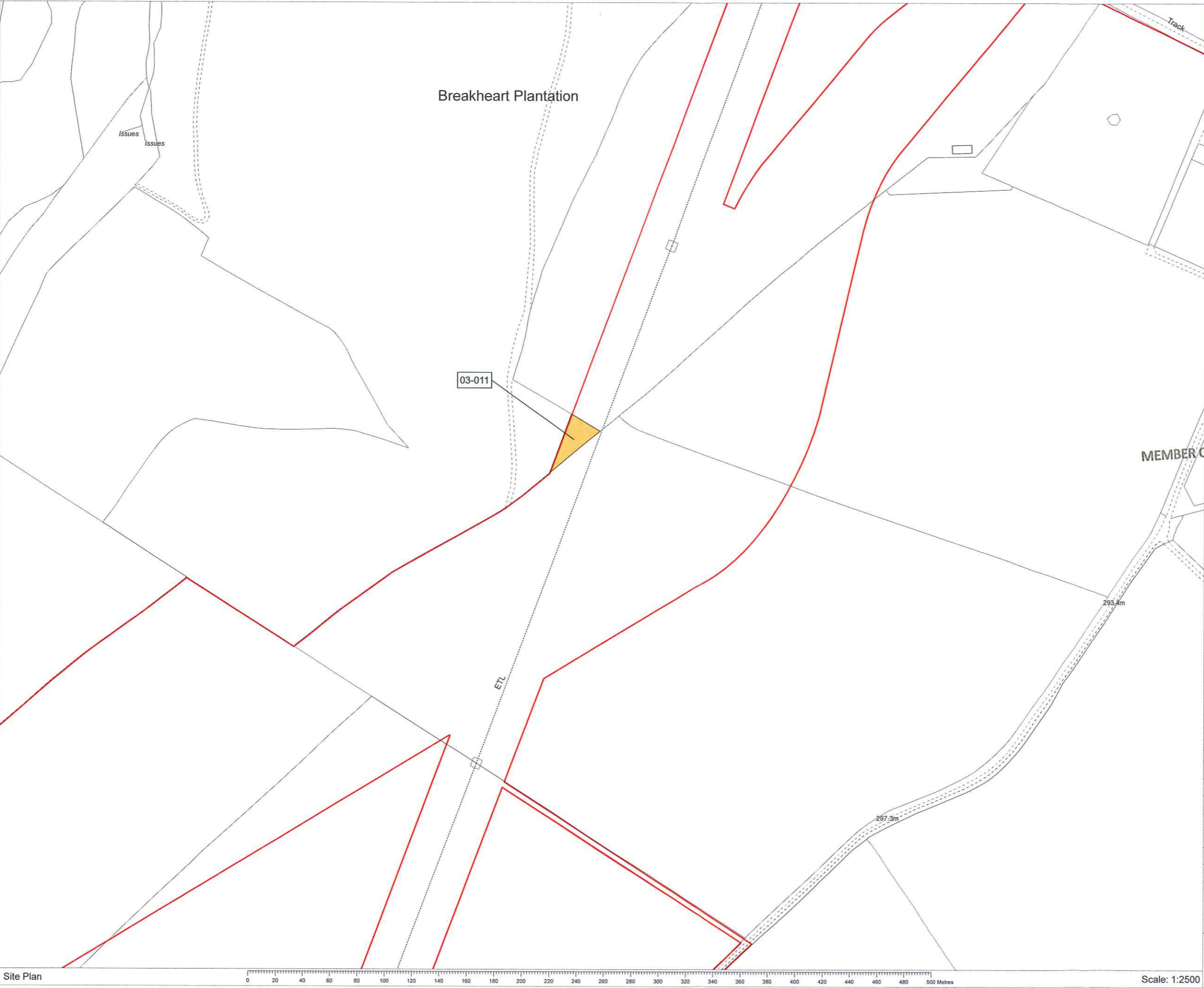

Key:
Order Limits
The Forestry Commission

Notes:
[Signature]
08/04/2025
NG 13036



MEMBER OF THE BOARD SEALING COMMITTEE

Coordinate System: British National Grid
Projection: Transverse Mercator
Datum: OSGB 1936

Interest:
Forestry Commission

Location:
Postlip Warren, Winchcombe, Tewkesbury,
Gloucestershire, GL54 5AQ

Coords: 401015, 225325

Scheme Name:
Cotswold VIP

Drawing Name:
Crown Land Map referred to in The National Grid Electricity
Transmission plc Cotswolds Visual Impact Provision
Compulsory Purchase Order 2025 - Land Plan 2 of 2
Drawing No: 21006866_PLN_INFO_913.3_B

Rev	Date	Description
-	03.07.2024	First Issue
A	25.09.2024	Amended Plots
B	27.03.2025	Order Limits

Drawn:	AM	
Approved:	OK	
Sheet No:	3 of 3	
Sheet Size:	A3	



Plan produced on behalf of National Grid Electricity Distribution
BASED UPON THE ORDINANCE SURVEY MAP WITH THE SANCTION
OF THE CONTROLLER OF HM STATIONERY OFFICE
CROWN COPYRIGHT RESERVED. © OS LICENCE No. 100024241