



Dated 14 February ~~2024~~ 2025

**THE NATIONAL GRID ELECTRICITY TRANSMISSION (HARKER ENERGY
ENABLEMENT PROJECT) COMPULSORY PURCHASE ORDER 2023**

**GENERAL VESTING
DECLARATION 4**

THE NATIONAL GRID ELECTRICITY TRANSMISSION (HARKER ENERGY ENABLEMENT PROJECT) COMPULSORY PURCHASE ORDER 2023

This General Vesting Declaration is executed on the 14 day of February ~~2024~~ ²⁰²⁵ by National Grid Electricity Transmission plc ("the **Authority**")

Whereas

- (A) On 1 August 2024 an order entitled The National Grid Electricity Transmission (Harker Energy Enablement Project) Compulsory Purchase Order 2023 ("the **Order**") was confirmed with modifications by The Secretary of State for Energy Security and Net Zero under the powers conferred on them by the Electricity Act 1989 authorising the Authority to acquire land (being the "New Rights" as defined in Schedule 1 and as detailed in column 5 of Schedule 2 hereto) specified and described in columns 1, 2, 3 and 4 of Schedule 2.
- (B) Notice of the confirmation of the Order with modifications was first published in accordance with section 15 of the Acquisition of Land Act 1981 ("the 1981 Act") on 19 August 2024.
- (C) That notice included the statement and form prescribed under section 15(4)(e) and (f) of the 1981 Act.

NOW THIS DEED WITNESSETH that, in exercise of the powers conferred on them by section 4 of the Compulsory Purchase (Vesting Declarations) Act 1981 ("the Act") the Authority hereby declares-

- 1) Save in respect of the interests of Excluded Persons, the land (being the New Rights) respectively specified and described in columns 1, 2, 3 and 4 of Schedule 2 (being part of the land authorised to be acquired by the Order) and more particularly shaded blue on the plans annexed hereto, together with the right to enter and take possession of the land for the purpose of exercising the New Rights, shall vest in the Authority for the benefit of the Authority's Undertaking as from the end of the period of 3 months from the date on which the service of notice required by section 6 of the Act is completed (the **Vesting Date**).
- 2) Each New Right vested by the declaration shall be exercisable at all times by the Authority, as well as its successors in title, lessees, licensees, assigns and those deriving title from them all, and all persons authorised by any of the aforementioned.
- 3) For the purposes of section 2(2) of the Act, the specified period in relation to the land comprised in the declaration is one year and one day.
- 4) The capitalised terms in this declaration and in Schedule 2 of this declaration shall have the meanings assigned to them in Schedule 1.

Executed as a Deed by the Authority on the day and year above written.

FIRST SCHEDULE

Definitions

Term	Definition
Overhead Line Rights	<p>All rights necessary at all times for the purposes of or incidental to the construction, retention, use, operation, protection, maintenance, surveying, testing, repair, renewal, replacement, commissioning and removal and decommissioning of the overhead electricity lines and associated infrastructure, including rights to:</p> <ul style="list-style-type: none"> (a) enter and remain on the land and adjoining land with or without personnel, vehicles, plant, machinery, apparatus and equipment including scaffolding, materials and personnel for such purposes; (b) take all necessary rights of support for the electric lines; (c) install and remove protection measures for third party structures/assets, including scaffolding; (d) prevent or restrict access to the land and adjoining land while works are being carried out; (e) test and commission the electric lines and to remedy initial faults and defects in them at any time; (f) enter the land and carry out surveys and investigations, including aerial surveys (including the right to fly an unmanned aircraft over the land and to enter and retrieve and recover any such unmanned aircraft from the land); (g) carry out archaeological works and surveys, environmental and/or ecological mitigation; (h) carry out works required or permitted by a planning permission and/or consent or licences; (i) erect and remove fencing; (j) store and stockpile and where necessary use, manage and process plant, machinery, apparatus, and materials (including excavated material) and/or equipment; (k) construct, lay down, use and remove access roads including any necessary temporary bridging, culverting or diversion of water courses and drains and modifying road verges and junctions; (l) carry out de-watering and drainage works and install, alter, reinstate or remove land drainage systems; (m) discharge water into existing drains and watercourses;

	<ul style="list-style-type: none"> (n) protect and prevent damage to or interference with the operation and maintenance of the electric lines and construction of the same; (o) fell, trim or lop trees, shrubs, hedges and bushes and to clear and remove any and all vegetation which may damage, obstruct or interfere with these Overhead Line Rights or access to the electric lines; (p) prevent and remove any works on or use of the land that would prevent the works, access to or the operation and maintenance of the electric lines; (q) erect, create, use and remove hoarding, welfare facilities including portable toilets, portable cabins and offices, security cameras, parking of vehicles and electricity generators; (r) install, use and remove artificial lighting; (s) install, use, alter, divert and remove services and utilities; (t) prevent changes to the use, or level of the surface of, the land; (u) make good any damage caused in connection with the exercise of these Overhead Line Rights; and (v) carry out any activities ancillary or incidental thereto. <p>and rights to prevent any works on or use of the land that would prevent the exercise of the aforementioned rights.</p>
Access Rights	<p>All rights necessary to access the land at all times with or without vehicles, plant, machinery, apparatus, equipment (including without limitation scaffolding), materials and personnel, to exercise the Overhead Line Rights, the Cabling Rights, the Construction Compound Rights and/or the Earthing Rights and for purposes of or incidental to constructing installing repairing replacing commissioning decommissioning altering and inspecting the substation and associated infrastructure including rights to:</p> <ul style="list-style-type: none"> (a) carry out works to facilitate such access including to construct, lay down, use and remove access roads including any necessary bridging, culverting or diversion of water courses and drains, modifying road verges and junctions and installing, using, altering, diverting, and removing services and utilities and erecting and removing of any necessary fencing, safety and security measures; (b) fell, trim or lop trees, shrubs, hedges and bushes and to clear and remove any and all vegetation which may damage, obstruct or interfere with these rights;

	<ul style="list-style-type: none"> (c) prevent and remove any works or use of the land which may interfere with or obstruct such access or the exercise of these rights; (d) make good any damage caused in connection with the exercise of these rights; and (e) park any vehicles on the land; (f) prevent or restrict access to the land and adjoining land while works are being carried out; (g) carry out any activities ancillary or incidental thereto.
<p>Construction Compound Rights</p>	<p>All rights necessary for the purposes of or incidental to the establishment, use and removal of works compounds associated with the construction and commissioning of the electric cables and/or the construction, commissioning and decommissioning of the electric lines, including to:</p> <ul style="list-style-type: none"> (a) erect, create, use and remove a works compound which may include hardstanding, portable cabins and offices, security measures and welfare facilities including portable toilets and electricity generators; (b) store, stockpile and where necessary use, manage and process plant, machinery, apparatus, materials (including excavated material) and/or equipment; (c) access and remain on the compound area with or without vehicles, personnel and plant, machinery, apparatus, equipment and materials for such purposes; (d) fence, erect hoardings or signage or otherwise secure the compound; (e) carry out de-watering and drainage works and install, alter or reinstate land, drainage systems; (f) discharge water into existing drains and watercourses; (g) install, use and remove artificial lighting; (h) park vehicles; (i) protect and prevent damage to or interference with the exercise of the Construction Compound Rights including the operation and maintenance of any works constructed pursuant to these Construction Compound Rights; (j) fell, trim or lop trees, shrubs, hedges and bushes and to clear and remove any and all vegetation which may damage, obstruct or interfere with the exercise of these Construction Compound Rights;

	<ul style="list-style-type: none"> (k) install, use, alter, divert and remove services and utilities; (l) the right to erect repair reinstate and remove temporary scaffolding; (m) carry out archaeological environmental and/or ecological mitigation measures (n) make good any damage caused in connection with the exercise of these Construction Compound Rights; and (o) carry out any activities ancillary or incidental thereto
<p>Cabling Rights</p>	<p>All rights necessary at all times for the purposes of or incidental to the construction, retention, use, operation, protection, maintenance, surveying, testing, repair, renewal, replacement, commissioning and removal and decommissioning of the electric cables and associated infrastructure, including rights to:</p> <ul style="list-style-type: none"> (a) access the land and adjoining land with or without vehicles, personnel and plant, machinery, apparatus, equipment and materials for such purposes; (b) construct and install the electric cables in, on, under or over the land, including using trenchless techniques such as horizontal directional drilling; (c) test and commission the electric cables installed in, on, under or over the land and to remedy faults and defects in it; (d) carry out de-watering and drainage works and install, alter, reinstate or remove land drainage systems (e) enter the land and carry out surveys and investigations, including aerial surveys (including the right to fly an unmanned aircraft over the land and to enter and retrieve and recover any such unmanned aircraft from the land); (f) protect and prevent damage to or interference with the electric cables including its construction, operation and maintenance; (g) fell, trim or lop trees, shrubs, hedges and bushes and to clear and remove any and all vegetation which may damage, obstruct or interfere with the electric cables and the exercise of the Cabling Rights; (h) prevent and remove any works on or use of the land that would prevent access to or the operation and maintenance of the electric cables and the exercise of the Cabling Rights;

	<ul style="list-style-type: none"> (i) prevent changes to the use, or level of the surface of, the land; (j) make good any damage caused in connection with the exercise of these Cabling Rights; (k) rights of support for the electric cables; and (l) carry out archaeological works and environmental and/or ecological mitigation; (m) carry out works required or permitted by a planning permission and/or consent or licences; (n) erect and remove fencing; (o) store and stockpile and where necessary use, manage and process plant, machinery, apparatus, and materials (including excavated material) and/or equipment; (p) construct, lay down, use and remove access roads including any necessary temporary bridging, culverting or diversion of water courses and drains, modifying road verges and junctions; (q) discharge water into existing drains and watercourses; (r) prevent and remove any works on or use of the land that may interfere with or obstruct the exercise of the electric cables (s) install, use and remove artificial lighting; (t) install, use, alter, divert and remove services and utilities; (u) carry out any activities ancillary or incidental thereto.
Earthing Rights	All rights necessary to access and remain on the land with or without vehicles, personnel and plant, machinery, apparatus, equipment and materials to install, retain, replace and remove safety devices upon electricity lines located on the land.
Electric Cables	the underground cables (including wires, earth wires, fibre optic cables and other communication cables, pipes, coatings and ducts), connections, cable draw pits, cable joints, cable marker posts, cable terminals, earth bonding and tape, drains, culverts, fibre optic pits, inspection boxes, trenches, marking bands, protective boards or tiles, jointing pits, link boxes, manholes, monitoring equipment, apparatus, conductors, supports, plant, equipment, pillars, warning tape, sheaths and other underground or overground equipment and apparatus associated with or ancillary to such underground cable

Electric Lines	the electric lines and conductors (including wires, earth wires, fibre optic cables and other communication cables, pipes, coatings, ducts and connections) for transmitting and/or distributing electricity at such voltage as the Authority or other licensed operators may from time to time require for the purposes of its or their operations together with the towers (if any) for supporting the same together with such equipment and apparatus associated with or ancillary to such electric lines and conductors
Excluded Persons	those persons, companies and firms listed at column 6 of Schedule 2
Plot	A plot of land described in the second column of Schedule 2 shown on the plan identified in Column 1 and numbered with the plot number and coloured blue.
New Rights	the Overhead Line Rights, the Access Rights, the Construction Compound Rights, the Cabling Rights and the Earthing Rights acquired in relation to each plot as specified in Column 5 of Schedule 2 hereto
Authority's Undertaking	The Authority's undertaking for the distribution of electricity including (without limitation) such land and hereditaments forming part of that undertaking as are accommodated by the New Rights.

SECOND SCHEDULE

Column 1	Column 2	Column 3	Column 4	Column 5	Column 6
Plan Reference	Plot Number	Description of Plot	Title Number(s)	New Rights	Excluded Persons
General Vesting Declaration No. 4 Sheet 1 of 8	001	75.00 square metres of agricultural land lying to the west of Scotsdike and to the south west of Todhillwood Cottages in the Parish of Kirkandrews	Unregistered	Access Rights	
General Vesting Declaration No. 4 Sheet 1, 2, and 3 of 8	002	11005.59 square metres of private agricultural access road, access splay, hardstanding, hedgerow, agricultural land and electricity lines lying to the north of Glingerbank Lodge and to the south of Scotsdike in the Parish of Kirkandrews	Unregistered	Access Rights	
General Vesting Declaration No. 4 Sheet 3, 4, and 5 of 8	003	15626.70 square metres of agricultural land lying to the south east of Glingerburn Bungalow and to the north west of Glinger Cottage in the Parish of Kirkandrews	Unregistered	Construction Compound Rights	
General Vesting Declaration No. 4 Sheet 1, 2, 3, 4 and 6 of 8	004	102578.59 square metres of agricultural land, woodland, stream (Glinger Burn), hedgerows, electricity pylons and access paths lying to the south west of Scotsdike and south east of Glenzierfoot in the Parish of Kirkandrews	Unregistered	Overhead Line Rights	
General Vesting Declaration No.	005	20896.57 square metres of agricultural land and hedgerow lying	Unregistered	Construction Compound Rights	

4 Sheet 3, 4 and 5 of 8		to the south east of Glingerburn Bungalow and to the west of Glinger Cottage in the Parish of Kirkandrews			
General Vesting Declaration No. 4 Sheet 5 of 8	006	1746.03 square metres of agricultural land and agricultural access track lying to the west of Dykeside Cottage and south west of Glinger Cottage in the Parish of Kirkandrews	Unregistered	Access Rights	
General Vesting Declaration No. 4 Sheet 5 and 6 of 8	007	2365.46 square metres of agricultural land, woodland, hedgerow and access path lying to the west of Dykeside Cottage and south of Glinger Cottage in the Parish of Kirkandrews	Unregistered	Access Rights	
General Vesting Declaration No. 4 Sheet 6 of 8	009	695.24 square metres of dense tree coverage and electricity pylon lying to the east of Old Schoolhouse and west of Glingerbank Cottages in the Parish of Kirkandrews	CU138913	Overhead Line Rights	
General Vesting Declaration No. 4 Sheet 6 and 7 of 8	010	15659.71 square metres of agricultural land, hedgerow and electricity pylons lying to the south west of Glinger Cottage and to the west of Glingerbank Lodge in the Parish of Kirkandrews	CU263700	Overhead Line Rights	
General Vesting Declaration No. 4 Sheet 6 of 8	011	1091.64 square metres of agricultural land lying to the west of Glinger Mill and south east of Old Schoolhouse in the Parish of Kirkandrews	CU263700	Access Rights	
General Vesting Declaration No. 4 Sheet 7 of 8	012	2056.65 square metres of agricultural land, hedgerow and agricultural field access lying to the south of Batenbush and south east	Unregistered	Access Rights	

		of Old Schoolhouse in the Parish of Kirkandrews			
General Vesting Declaration No. 4 Sheet 6, 7, and 8 of 8	013	37503.22 square metres of agricultural land, hedgerows, electricity pylons and agricultural access track lying to the south west of Batenbush and south east of Old Schoolhouse in the Parish of Kirkandrews	Unregistered	Overhead Line Rights	
General Vesting Declaration No. 4 Sheet 7 and 8 of 8	015	1149.76 square metres of agricultural land, hedgerow and agricultural field access lying to the south of Batenbush and north west of Crofthead Cottages in the Parish of Kirkandrews	Unregistered	Access Rights	
General Vesting Declaration No. 4 Sheet 8 of 8	016	303.92 square metres of agricultural land lying to the west of Crofthead Cottages and to the south of Batenbush in the Parish of Kirkandrews	CU136452	Access Rights	
General Vesting Declaration No. 4 Sheet 8 of 8	017	7033.16 square metres of agricultural land, hedgerow and electricity pylons lying to the west of Crofthead Cottages and to the south of Batenbush in the Parish of Kirkandrews	CU136452	Overhead Line Rights	
General Vesting Declaration No. 4 Sheet 8 of 8	024	556.24 square metres of agricultural land, hedgerow and agricultural field access lying to the east of Oakbank and west of Crofthead Cottages in the Parish of Kirkandrews	CU136452	Overhead Line Rights	
General Vesting Declaration No. 4 Sheet 3, 4, and 5 of 8	226	26996.63 square metres of agricultural land, woodland, stream (Glinger Burn), hedgerows, electricity pylons and access paths lying to the south west of Scotsdike	Unregistered	Overhead Line Rights	

		and east of Glingerburn Bungalow in the Parish of Kirkandrews			
General Vesting Declaration No. 4 Sheet 4 of 8	236	1239.40 square metres of agricultural land and hedgerow lying to the east of Daffiestonrigg and southwest of Glingerburn Bungalow in the Parish of Kirkandrews	Unregistered	Access Rights	
General Vesting Declaration No. 4 Sheet 3 and 4 of 8	237	149.74 square metres of agricultural land lying to the south of Glingerburn Bungalow and north east of Daffiestonrigg in the Parish of Kirkandrews	Unregistered	Access Rights	
General Vesting Declaration No. 4 Sheet 3, 4, and 5 of 8	239	1207.85 square metres of private agricultural access, hedgerow, agricultural land and verge lying to the south of Glingerburn Bungalow and north east of Daffiestonrigg in the Parish of Kirkandrews	Unregistered	Access Rights	

The COMMON SEAL of
**NATIONAL GRID ELECTRICITY
TRANSMISSION PLC** was hereunto affixed in
the presence of:

Authorised Signatory
Member of the Board Sealing Committee

)
)
)
)
)
)
.....
Juan Lobo
NET 12186



Plans

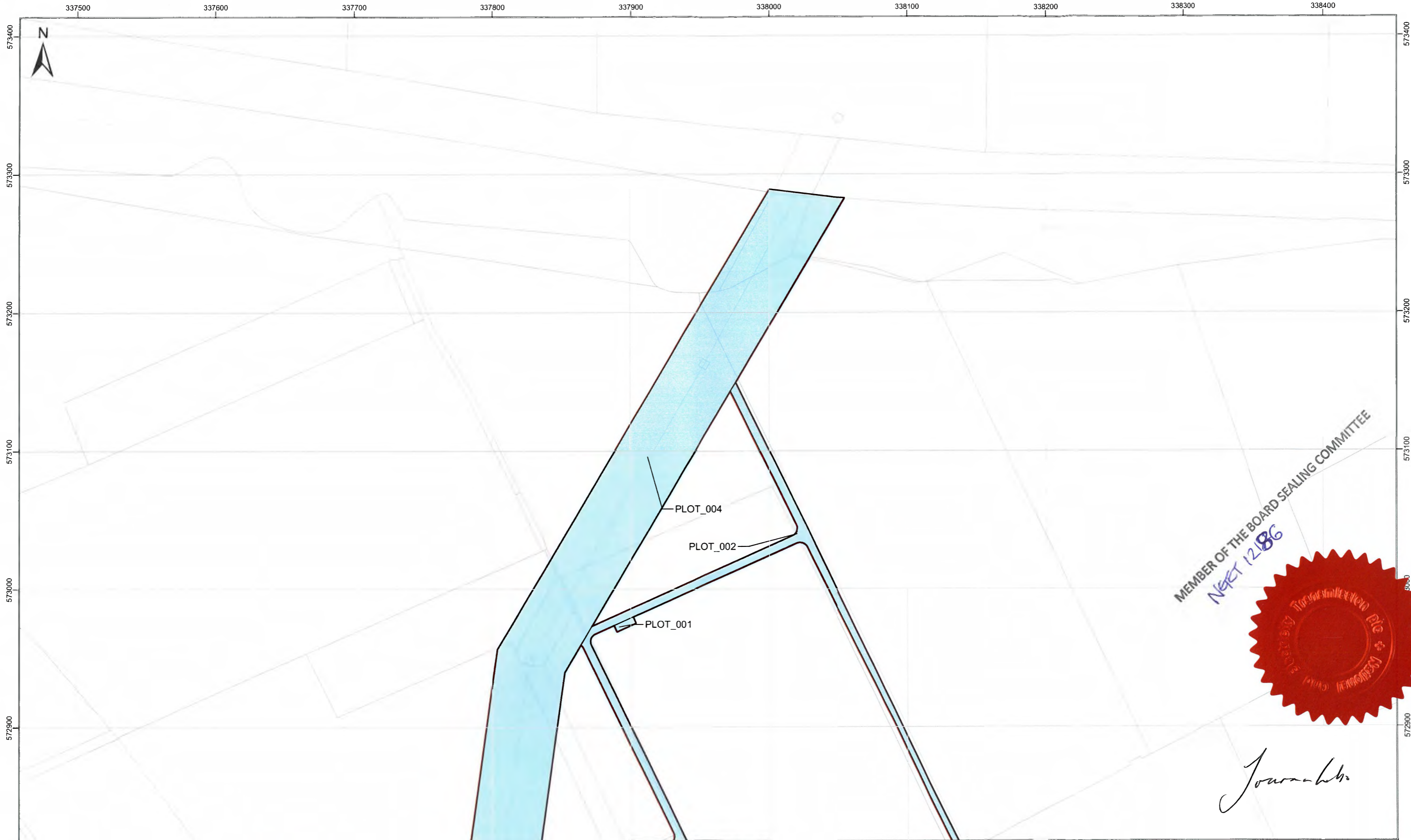

MEMBER OF THE BOARD SEALING COMMITTEE
 NGET 12/86



Journe

Client **nationalgrid**

Project
**THE NATIONAL GRID ELECTRICITY TRANSMISSION
 (HARKER ENERGY ENABLEMENT PROJECT)
 COMPULSORY PURCHASE ORDER 2023**

**GENERAL VESTING DECLARATION NO. 4
 SHEET 1 OF 8**

Project Number 534746

Order Boundary
 Land Being Acquired
 Rights Being Acquired

© Crown copyright and database rights 2024 OS 100024241. You are permitted to use this data solely to enable you to respond to, or interact with, the organisation that provided you with the data. You are not permitted to copy, sub-license, distribute or sell any of this data to third parties in any form.

0 20 40 60 80 100 120 140 160
 Meters

Longtown

Contains OS data © Crown Copyright and database right 2020

The common seal of National Grid Electricity Transmission plc was affixed on the _____ day of _____ 2024 in the presence of _____

(Member of the Board Sealing Committee and Authorised Signatory)

Dated

BK Bruton Knowles

Olympus House
 Olympus Park
 Quedgeley
 Gloucester
 GL2 4NF
 Phone: 01452 880000

MAP CENTRE: 337956E 573116N

SCALE: 1:2,500 PAPER SIZE: A3

DRAWN: DLG CHECKED: CR

VERSION: 1 DATE: 23/10/2024

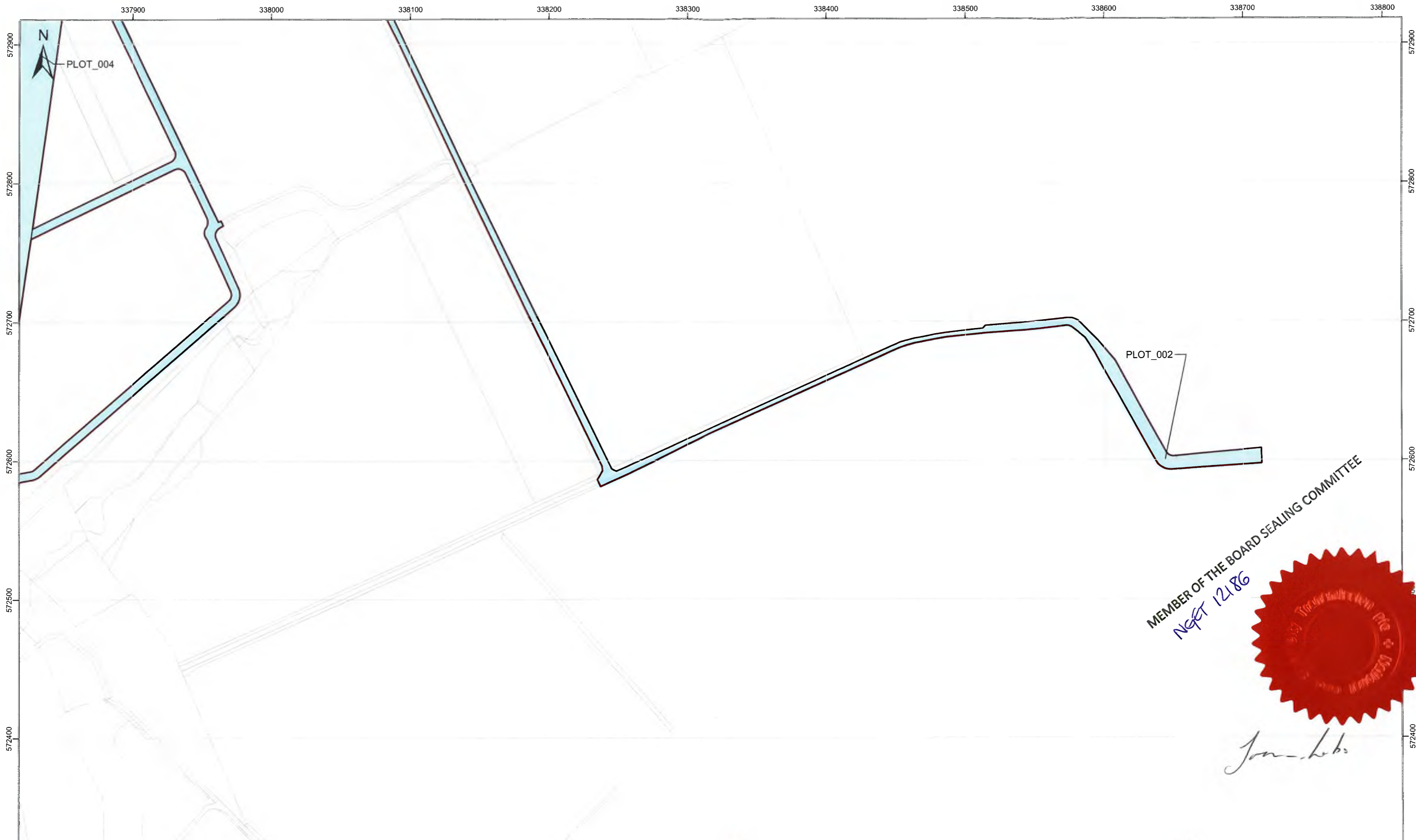

MEMBER OF THE BOARD SEALING COMMITTEE
 NGET 12186



Jon Lebo

Client
nationalgrid

Project
 THE NATIONAL GRID ELECTRICITY TRANSMISSION
 (HARKER ENERGY ENABLEMENT PROJECT)
 COMPULSORY PURCHASE ORDER 2023

GENERAL VESTING DECLARATION NO. 4
 SHEET 2 OF 8

Project Number 534746

Order Boundary
 Land Being Acquired
 Rights Being Acquired

© Crown copyright and database rights 2024 OS 100024241. You are permitted to use this data solely to enable you to respond to, or interact with, the organisation that provided you with the data. You are not permitted to copy, sub-license, distribute or sell any of this data to third parties in any form.

0 20 40 60 80 100 120 140 160
 Meters

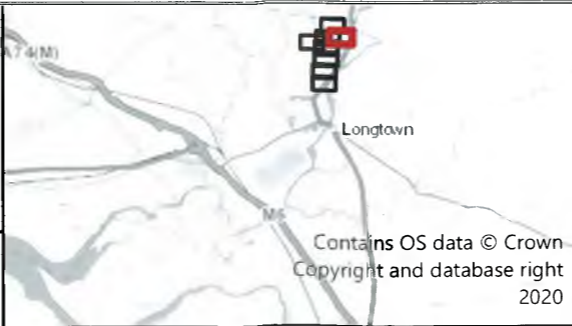

The common seal of National Grid Electricity Transmission plc was affixed on the _____ day of _____ 2024 in the presence of _____

 (Member of the Board Sealing Committee and Authorised Signatory)

Dated

BK Bruton Knowles
 Olympus House
 Olympus Park
 Quedgeley
 Gloucester
 GL2 4NF
 Phone: 01452 880000

MAP CENTRE: 338316E 572620N

SCALE: 1:2,500 PAPER SIZE: A3

DRAWN: DLG CHECKED: CR

VERSION: 1 DATE: 23/10/2024



MEMBER OF THE BOARD SEALING COMMITTEE
 NGET 12186



Joan Leho

Client
nationalgrid

Project
 THE NATIONAL GRID ELECTRICITY TRANSMISSION
 (HARKER ENERGY ENABLEMENT PROJECT)
 COMPULSORY PURCHASE ORDER 2023

GENERAL VESTING DECLARATION NO. 4
 SHEET 3 OF 8

Project Number 534746

Order Boundary
 Land Being Acquired
 Rights Being Acquired

© Crown copyright and database rights 2024 OS 100024241. You are permitted to use this data solely to enable you to respond to, or interact with, the organisation that provided you with the data. You are not permitted to copy, sub-license, distribute or sell any of this data to third parties in any form.

0 20 40 60 80 100 120 140 160
 Meters

Contains OS data © Crown Copyright and database right 2020

The common seal of National Grid Electricity Transmission plc was affixed on the _____ day of _____ 2024 in the presence of _____ (Member of the Board Sealing Committee and Authorised Signatory) Dated

BK Bruton Knowles
 Olympus House
 Olympus Park
 Quedgeley
 Gloucester
 GL2 4NF
 Phone: 01452 880000

MAP CENTRE: 337753E 572591N

SCALE: 1:2,500 PAPER SIZE: A3

DRAWN: DLG CHECKED: CR

VERSION: 1 DATE: 23/10/2024

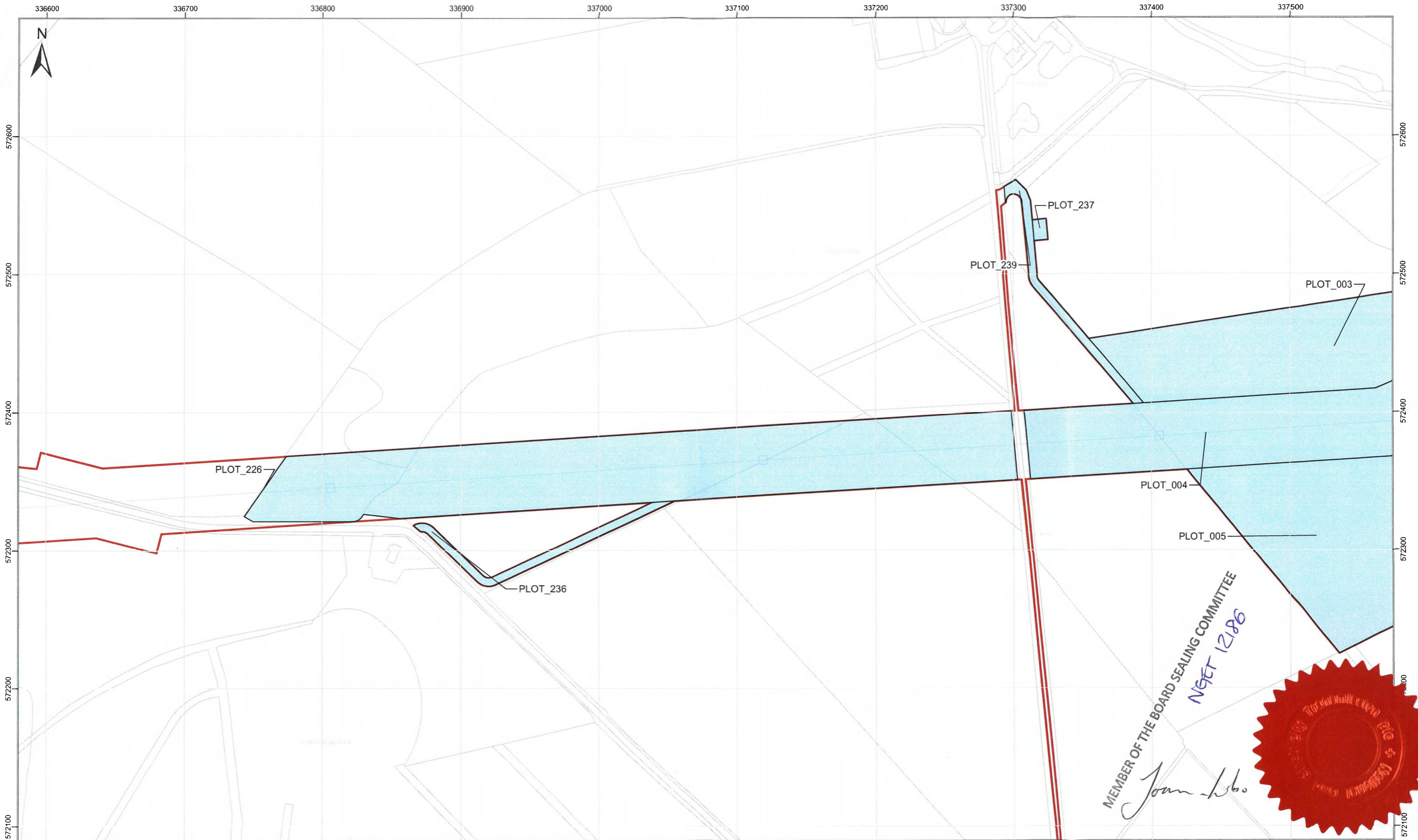

MEMBER OF THE BOARD SEALING COMMITTEE
NGET 12/26
Joan Lobo



Client	nationalgrid
Project	THE NATIONAL GRID ELECTRICITY TRANSMISSION (HARKER ENERGY ENABLEMENT PROJECT) COMPULSORY PURCHASE ORDER 2023
	GENERAL VESTING DECLARATION NO. 4 SHEET 4 OF 8
Project Number	534746

Order Boundary
 Land Being Acquired
 Rights Being Acquired

© Crown copyright and database rights 2024 OS 100024241. You are permitted to use this data solely to enable you to respond to, or interact with, the organisation that provided you with the data. You are not permitted to copy, sub-license, distribute or sell any of this data to third parties in any form.

0 20 40 60 80 100 120 140 160
 Meters

Contains OS data © Crown Copyright and database right 2020

The common seal of National Grid Electricity Transmission plc was affixed on the _____ day of _____ 2024 in the presence of _____

 (Member of the Board Sealing Committee and Authorised Signatory)
 Dated

BK Bruton Knowles		Olympus House Olympus Park Quedgeley Gloucester GL2 4NF Phone: 01452 880000	
MAP CENTRE: 337077E 572387N			
SCALE:	1:2,500	PAPER SIZE:	A3
DRAWN:	DLG	CHECKED:	CR
VERSION:	1	DATE:	23/10/2024

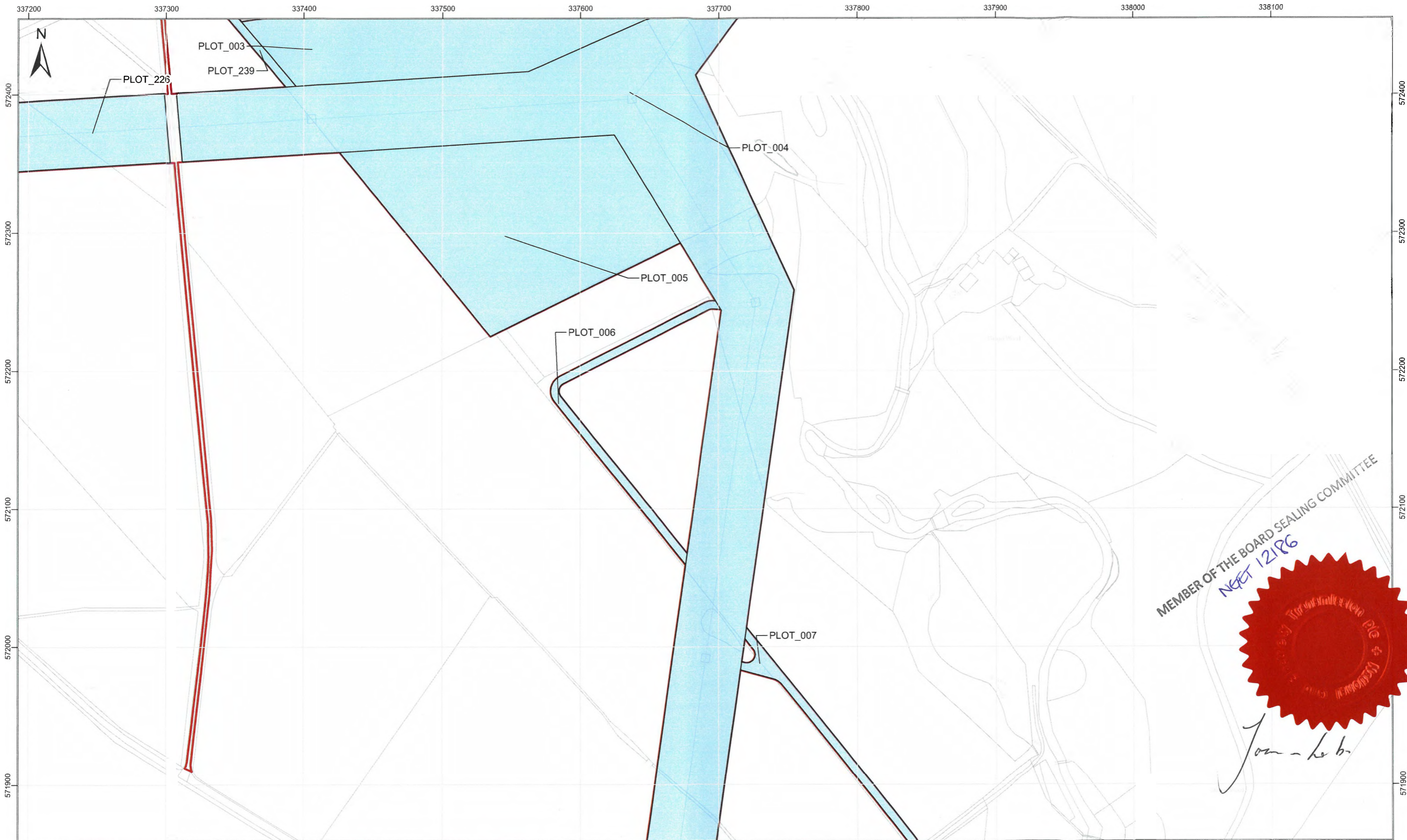

MEMBER OF THE BOARD SEALING COMMITTEE
 NGET 12186



Tom - Le b.

Client
nationalgrid

Project
 THE NATIONAL GRID ELECTRICITY TRANSMISSION
 (HARKER ENERGY ENABLEMENT PROJECT)
 COMPULSORY PURCHASE ORDER 2023

GENERAL VESTING DECLARATION NO. 4
 SHEET 5 OF 8

Project Number 534746

■ Order Boundary
 Land Being Acquired
 Rights Being Acquired

© Crown copyright and database rights 2024 OS 100024241. You are permitted to use this data solely to enable you to respond to, or interact with, the organisation that provided you with the data. You are not permitted to copy, sub-license, distribute or sell any of this data to third parties in any form.

0 20 40 60 80 100 120 140 160
 Meters

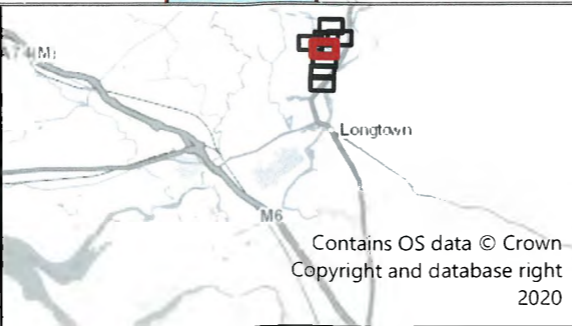

The common seal of National Grid Electricity Transmission plc was affixed on the _____ day of _____ 2024 in the presence of _____

 (Member of the Board Sealing Committee and Authorised Signatory)

Dated

BK Bruton Knowles

Olympus House
 Olympus Park
 Quedgeley
 Gloucester
 GL2 4NF
 Phone: 01452 880000

MAP CENTRE: 337690E 572157N

SCALE: 1:2,500 PAPER SIZE: A3

DRAWN: DLG CHECKED: CR

VERSION: 1 DATE: 23/10/2024



MEMBER OF THE BOARD SEALING COMMITTEE
NET 12186



James Loh

Client
nationalgrid

Project
THE NATIONAL GRID ELECTRICITY TRANSMISSION (HARKER ENERGY ENABLEMENT PROJECT) COMPULSORY PURCHASE ORDER 2023

GENERAL VESTING DECLARATION NO. 4
 SHEET 6 OF 8

Project Number 534746

Order Boundary
 Land Being Acquired
 Rights Being Acquired

© Crown copyright and database rights 2024 OS 100024241. You are permitted to use this data solely to enable you to respond to, or interact with, the organisation that provided you with the data. You are not permitted to copy, sub-license, distribute or sell any of this data to third parties in any form.

0 20 40 60 80 100 120 140 160
 Meters

Longtown

Contains OS data © Crown Copyright and database right 2020

The common seal of National Grid Electricity Transmission plc was affixed on the _____ day of _____ 2024 in the presence of _____

(Member of the Board Sealing Committee and Authorised Signatory)

Dated

BK Bruton Knowles

Olympus House
 Olympus Park
 Quedgeley
 Gloucester
 GL2 4NF
 Phone: 01452 880000

MAP CENTRE: 337670E 571660N

SCALE: 1:2,500 PAPER SIZE: A3

DRAWN: DLG CHECKED: CR

VERSION: 1 DATE: 23/10/2024



MEMBER OF THE BOARD SEALING COMMITTEE
 NG 12/86



Client
nationalgrid

Project
 THE NATIONAL GRID ELECTRICITY TRANSMISSION
 (HARKER ENERGY ENABLEMENT PROJECT)
 COMPULSORY PURCHASE ORDER 2023

GENERAL VESTING DECLARATION NO. 4
 SHEET 7 OF 8

Project Number 534746

Order Boundary
 Land Being Acquired
 Rights Being Acquired

© Crown copyright and database rights 2024 OS 100024241. You are permitted to use this data solely to enable you to respond to, or interact with, the organisation that provided you with the data. You are not permitted to copy, sub-license, distribute or sell any of this data to third parties in any form.

0 20 40 60 80 100 120 140 160
 Meters

Longtown

M6

Contains OS data © Crown Copyright and database right 2020

The common seal of National Grid Electricity Transmission plc was affixed on the _____ day of _____ 2024 in the presence of _____

(Member of the Board Sealing Committee and Authorised Signatory)

Dated

BK Bruton Knowles

Olympus House
 Olympus Park
 Quedgeley
 Gloucester
 GL2 4NF
 Phone: 01452 880000

MAP CENTRE: 337603E 571153N

SCALE: 1:2,500 PAPER SIZE: A3

DRAWN: DLG CHECKED: CR

VERSION: 1 DATE: 23/10/2024

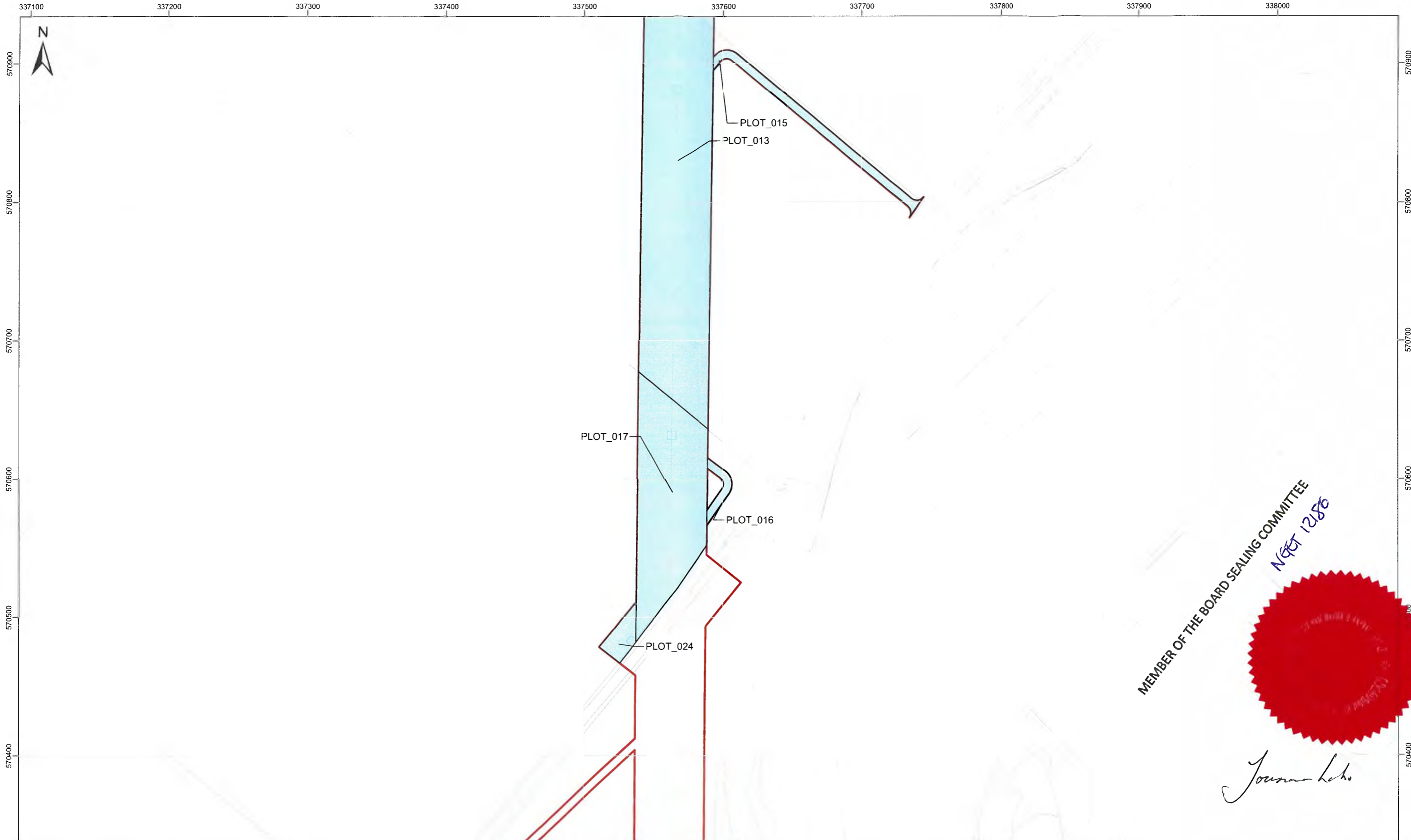

MEMBER OF THE BOARD SEALING COMMITTEE
 NGST 12186

Journa Leho

Client
nationalgrid

Project
**THE NATIONAL GRID ELECTRICITY TRANSMISSION
 (HARKER ENERGY ENABLEMENT PROJECT)
 COMPULSORY PURCHASE ORDER 2023**

**GENERAL VESTING DECLARATION NO. 4
 SHEET 8 OF 8**

Project Number 534746

Order Boundary
 Land Being Acquired
 Rights Being Acquired

© Crown copyright and database rights 2024 OS 100024241. You are permitted to use this data solely to enable you to respond to, or interact with, the organisation that provided you with the data. You are not permitted to copy, sub-license, distribute or sell any of this data to third parties in any form.

0 20 40 60 80 100 120 140 160
 Meters

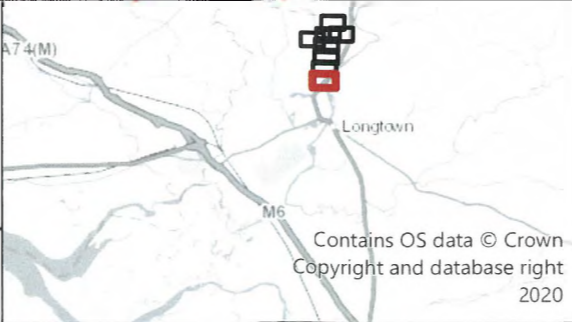

The common seal of National Grid Electricity Transmission plc was affixed on the _____ day of _____ 2024 in the presence of _____

(Member of the Board Sealing Committee and Authorised Signatory)

Dated

BK Bruton Knowles

Olympus House
 Olympus Park
 Quedgeley
 Gloucester
 GL2 4NF
 Phone: 01452 880000

MAP CENTRE: 337589E 570636N

SCALE: 1:2,500 PAPER SIZE: A3

DRAWN: DLG CHECKED: CR

VERSION: 1 DATE: 23/10/2024