

Map Centre 566161E 174985N m

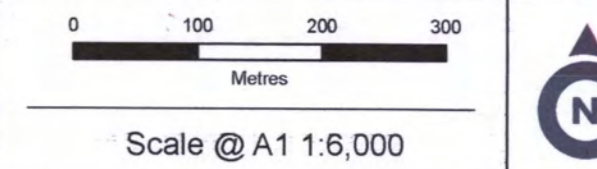

Scale @ A1 1:6,000

**Client:**  
nationalgrid  
1-3 Strand, London, WC2N 3EH  
T +44 (0)2070450000  
https://www.nationalgrid.com

**Project:**  
Grain to Tilbury

**Title:**  
MAP REFERRED TO IN THE  
NATIONAL GRID ELECTRICITY  
TRANSMISSION PLC  
(GRAIN TO TILBURY) COMPULSORY  
PURCHASE ORDER 2024

**Sheet:**  
Key Plan

**Legend:**  
Sheet Frames  
Order Land Boundary

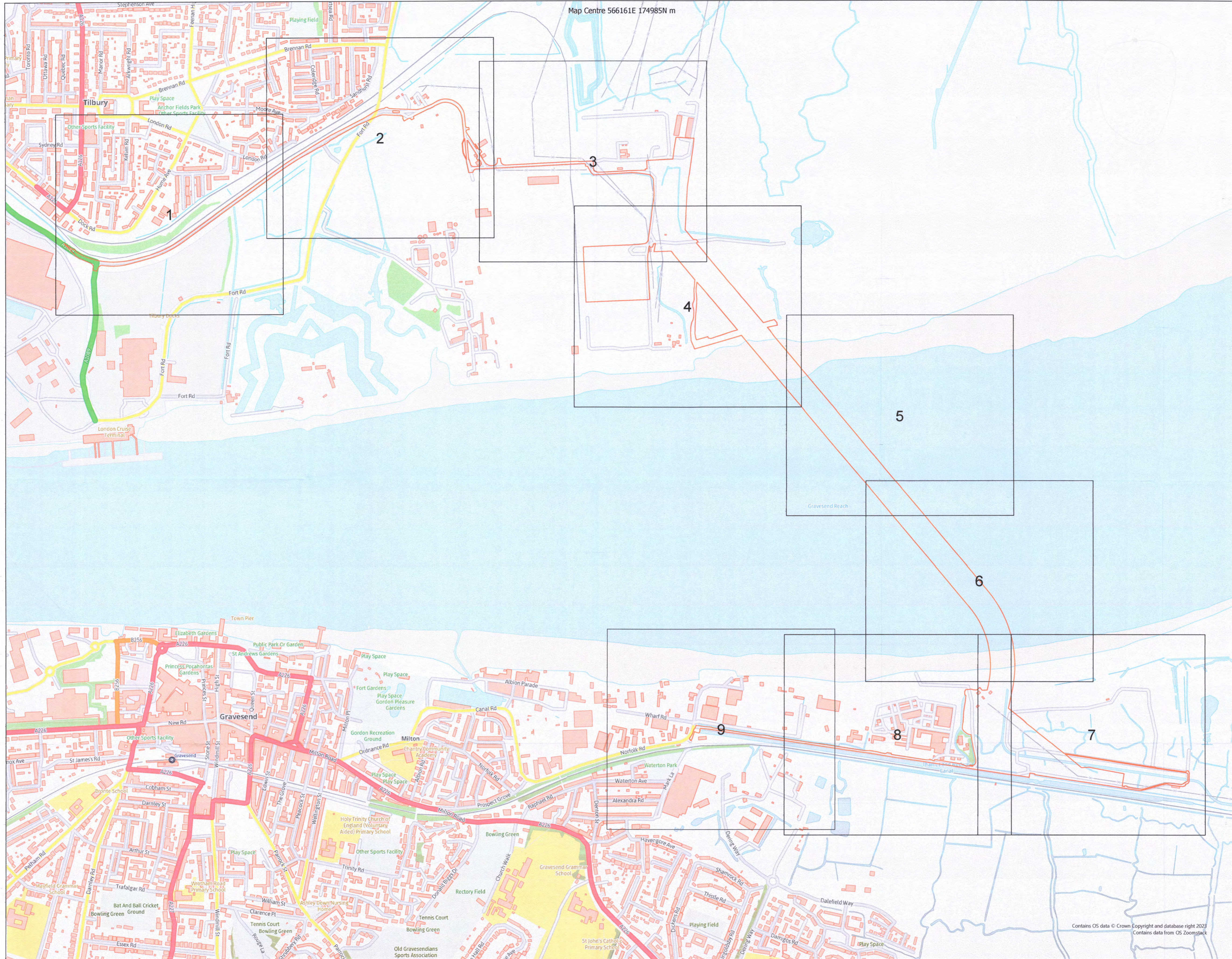

**NOTES**  
1. ALL DIMENSIONS ARE IN METRES UNLESS STATED OTHERWISE.  
2. DO NOT SCALE FROM THIS DRAWING. USE ONLY PRINTED DIMENSIONS.  
3. ALL EASEMENTS, SERVITUDES AND PRIVATE RIGHTS ARE PROPOSED TO BE EXTINGUISHED ON LAND THAT IS TO BE ACQUIRED, UNLESS STATED OTHERWISE IN THE CPO SCHEDULE.  
4. THIS DRAWING IS TO BE READ IN CONJUNCTION WITH ALL OTHER PLANS AND DOCUMENTATION, IN PARTICULAR THE WORKS PLANS AND THE CPO SCHEDULE.

THIS DOCUMENT HAS BEEN PREPARED PURSUANT TO AND SUBJECT TO THE TERMS OF CARTER JONAS' APPOINTMENT BY ITS CLIENT. CARTER JONAS ACCEPTS NO LIABILITY FOR ANY USE OF THIS DOCUMENT OTHER THAN BY ITS ORIGINAL CLIENT OR FOLLOWING CARTER JONAS' EXPRESS AGREEMENT TO SUCH USE, AND ONLY FOR THE PURPOSES FOR WHICH IT WAS PREPARED AND PROVIDED.

Drawn By: RL Date: 01/11/2024  
Checked By: AP Dwg no: J0077128-24-07



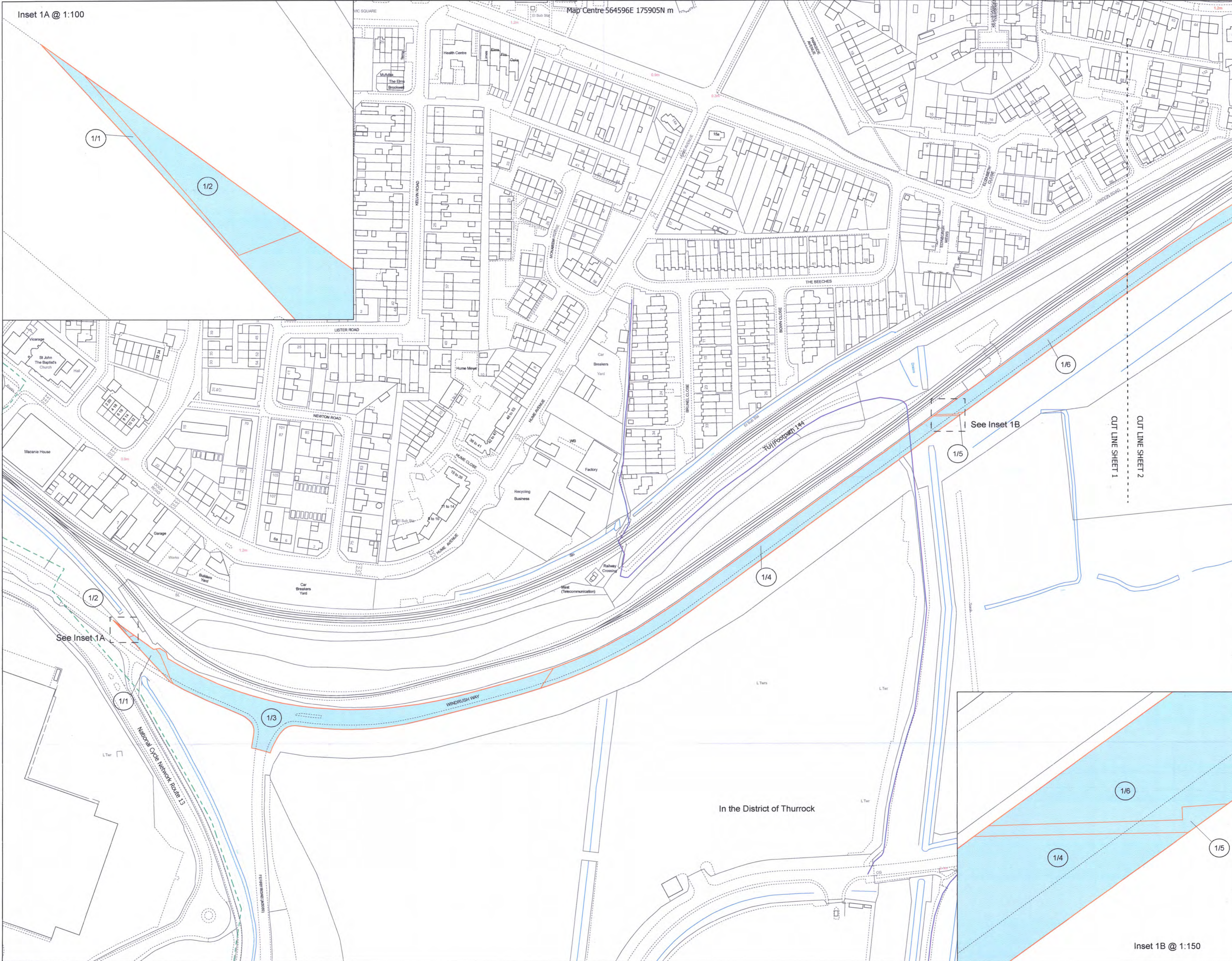

Inset 1A @ 1:100

Map Centre 564596E 175905N m

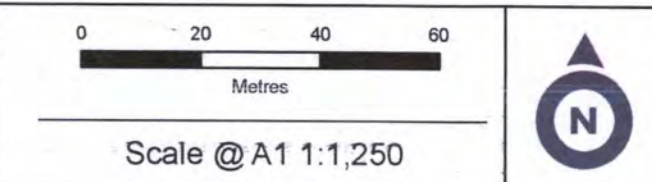

Scale @ A1 1:1,250

**Carter Jonas** 1 Chapel Place, London, W1G 0BG  
E: land.referring@carterjonas.co.uk  
carterjonas.co.uk

**Client:**  
**nationalgrid** 1-3 Strand, London, WC2N 5EH  
T: +44 (0)207043000  
https://www.nationalgrid.com

**Project:**  
Grain to Tilbury

**Title:**  
MAP REFERRED TO IN THE  
NATIONAL GRID ELECTRICITY  
TRANSMISSION PLC  
(GRAIN TO TILBURY) COMPULSORY  
PURCHASE ORDER 2024

**Sheet:**  
1 of 9

- Legend:**
- Order Land Boundary
  - New Rights to be Acquired
  - Land to be Acquired
  - Area not within the Order Land
  - Sheet Cut Line
  - Public Rights of Way
  - National Cycle Network



The COMMON SEAL of NATIONAL GRID ELECTRICITY TRANSMISSION PLC was hereunto affixed on the 14 day of November 2024 in the presence of:

*[Signature]*  
MEMBER OF THE BOARD SEALING COMMITTEE  
NGT 12/93

Authorised Signatory  
Member of the Board Sealing Committee

- NOTES**
1. ALL DIMENSIONS ARE IN METRES UNLESS STATED OTHERWISE.
  2. DO NOT SCALE FROM THIS DRAWING, USE ONLY PRINTED DIMENSIONS.
  3. ALL EASEMENTS, SERVITUDES AND PRIVATE RIGHTS ARE PROPOSED TO BE EXTINGUISHED ON LAND THAT IS TO BE ACQUIRED, UNLESS STATED OTHERWISE IN THE CPO SCHEDULE.
  4. THIS DRAWING IS TO BE READ IN CONJUNCTION WITH ALL OTHER PLANS AND DOCUMENTATION, IN PARTICULAR THE WORKS PLANS AND THE CPO SCHEDULE.

THIS DOCUMENT HAS BEEN PREPARED PURSUANT TO AND SUBJECT TO THE TERMS OF CARTER JONAS' APPOINTMENT BY ITS CLIENT. CARTER JONAS ACCEPTS NO LIABILITY FOR ANY USE OF THIS DOCUMENT OTHER THAN BY ITS ORIGINAL CLIENT OR FOLLOWING CARTER JONAS' EXPRESS AGREEMENT TO SUCH USE, AND ONLY FOR THE PURPOSES FOR WHICH IT WAS PREPARED AND PROVIDED.

Drawn By: RL Date: 06/11/2024  
Checked By: AP Dwg no: J0077128-24-08

In the District of Thurrock

Inset 1B @ 1:150



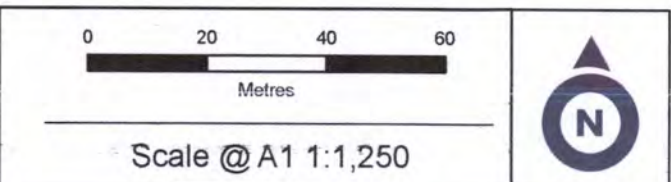
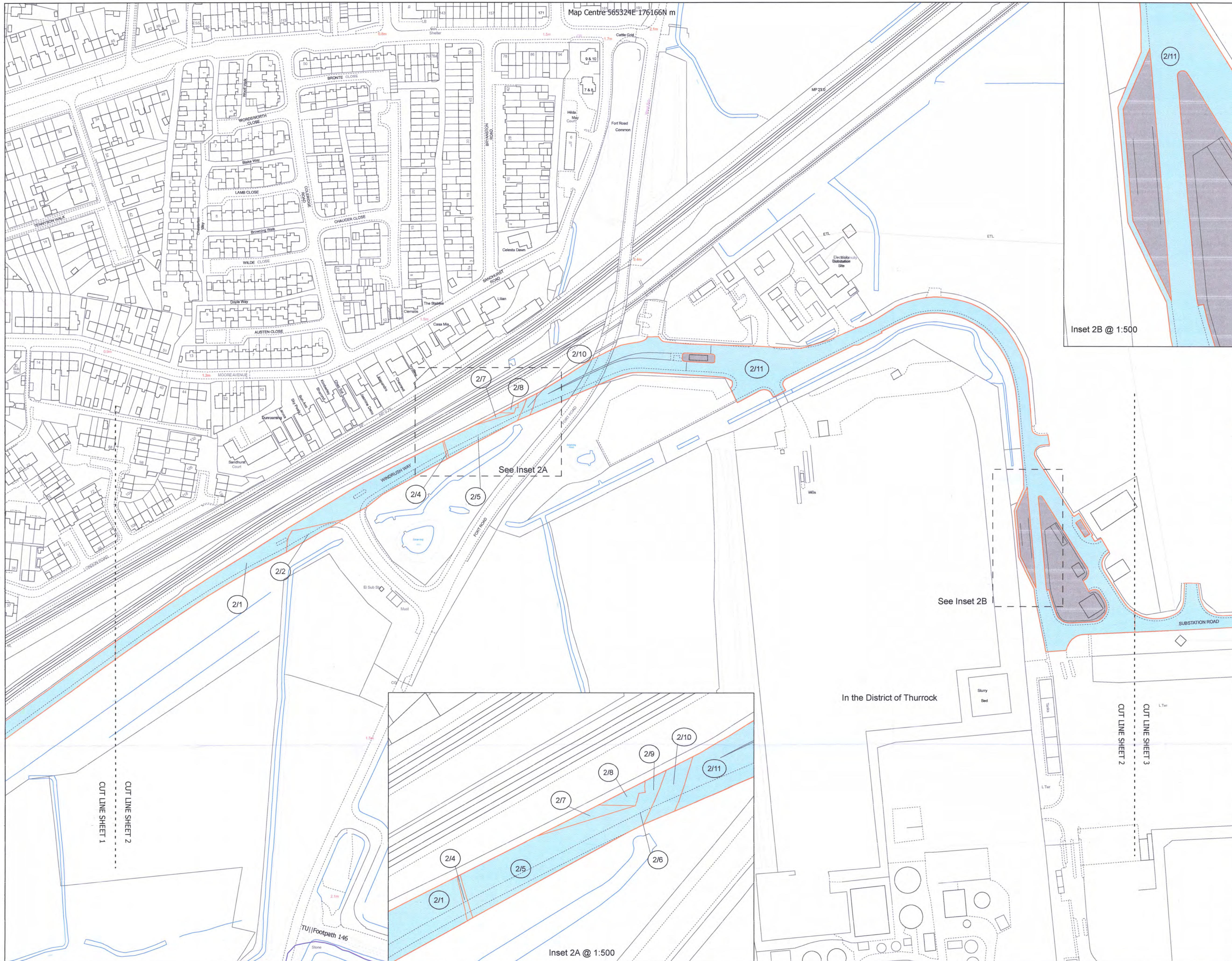

**Carter Jonas**  
 1 Chapel Place, London, WC2N 8EH  
 E: land.referring@carterjonas.co.uk  
 carterjonas.co.uk

**Client:**  
**nationalgrid**  
 1-3 Strand, London, WC2N 8EH  
 T: +44 (0)207043000  
 https://www.nationalgrid.com

**Project:**  
 Grain to Tilbury

**Title:**  
 MAP REFERRED TO IN THE  
 NATIONAL GRID ELECTRICITY  
 TRANSMISSION PLC  
 (GRAIN TO TILBURY) COMPULSORY  
 PURCHASE ORDER 2024

**Sheet:**  
 2 of 9

- Legend:**
- Order Land Boundary
  - New Rights to be Acquired
  - Land to be Acquired
  - Area not within the Order Land
  - Sheet Cut Line
  - Public Rights of Way
  - National Cycle Network



The COMMON SEAL of NATIONAL GRID ELECTRICITY TRANSMISSION PLC was hereto affixed on the 14 day of November 2024 in the presence of:

12/1/24  
 MEMBER OF THE BOARD SEALING COMMITTEE  

Authorised Signatory  
 Member of the Board Sealing Committee

- NOTES**
1. ALL DIMENSIONS ARE IN METRES UNLESS STATED OTHERWISE.
  2. DO NOT SCALE FROM THIS DRAWING, USE ONLY PRINTED DIMENSIONS.
  3. ALL EASEMENTS, SERVITUDES AND PRIVATE RIGHTS ARE PROPOSED TO BE EXTINGUISHED ON LAND THAT IS TO BE ACQUIRED, UNLESS STATED OTHERWISE IN THE CPO SCHEDULE.
  4. THIS DRAWING IS TO BE READ IN CONJUNCTION WITH ALL OTHER PLANS AND DOCUMENTATION, IN PARTICULAR THE WORKS PLANS AND THE CPO SCHEDULE.

THIS DOCUMENT HAS BEEN PREPARED PURSUANT TO AND SUBJECT TO THE TERMS OF CARTER JONAS' APPOINTMENT BY ITS CLIENT.  
 CARTER JONAS ACCEPTS NO LIABILITY FOR ANY USE OF THIS DOCUMENT OTHER THAN BY ITS ORIGINAL CLIENT OR FOLLOWING CARTER JONAS' EXPRESS AGREEMENT TO SUCH USE, AND ONLY FOR THE PURPOSES FOR WHICH IT WAS PREPARED AND PROVIDED.

Drawn By: RL Date: 06/11/2024  
 Checked By: AP Dwg no: J0077128-24-08

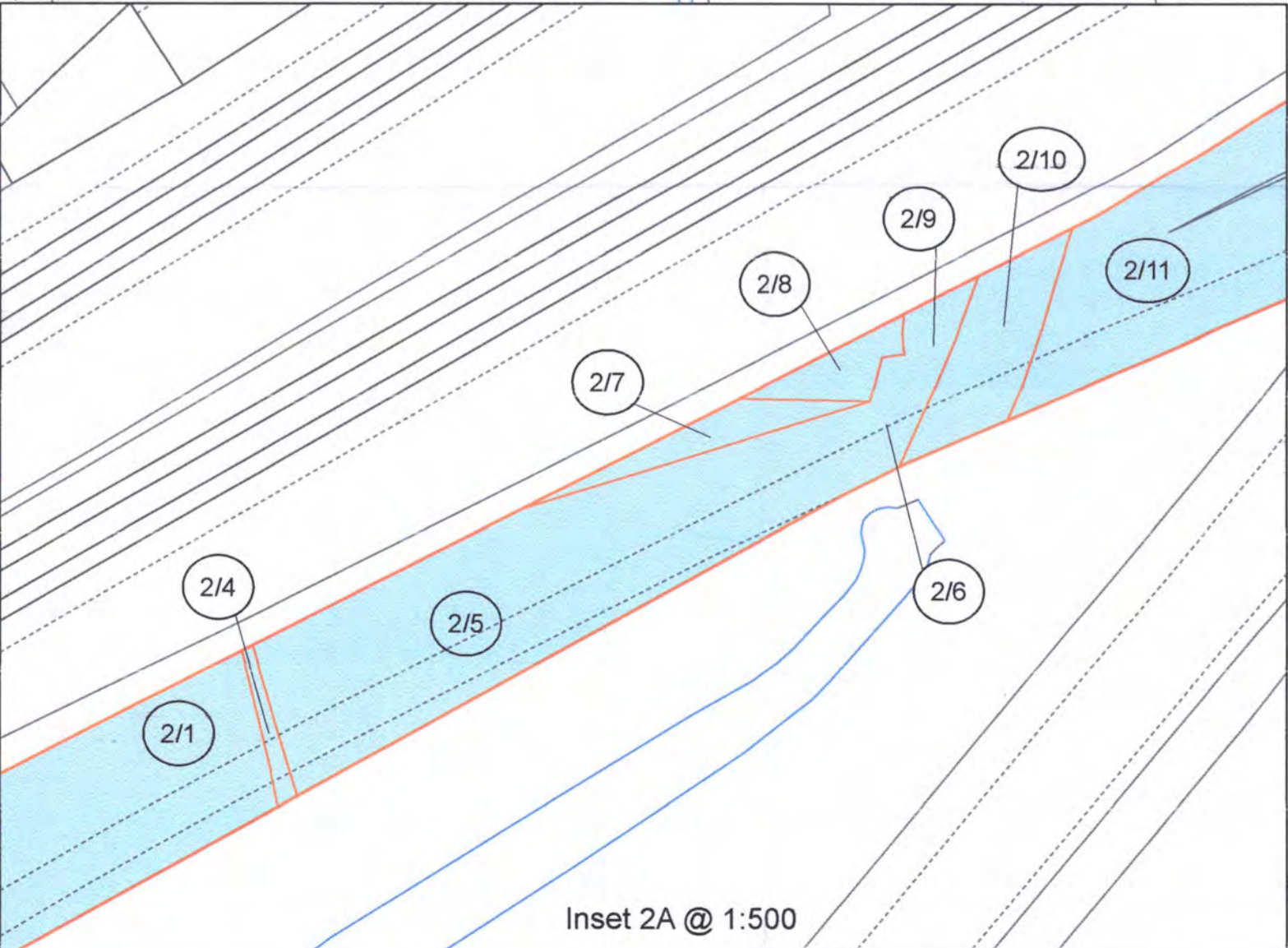
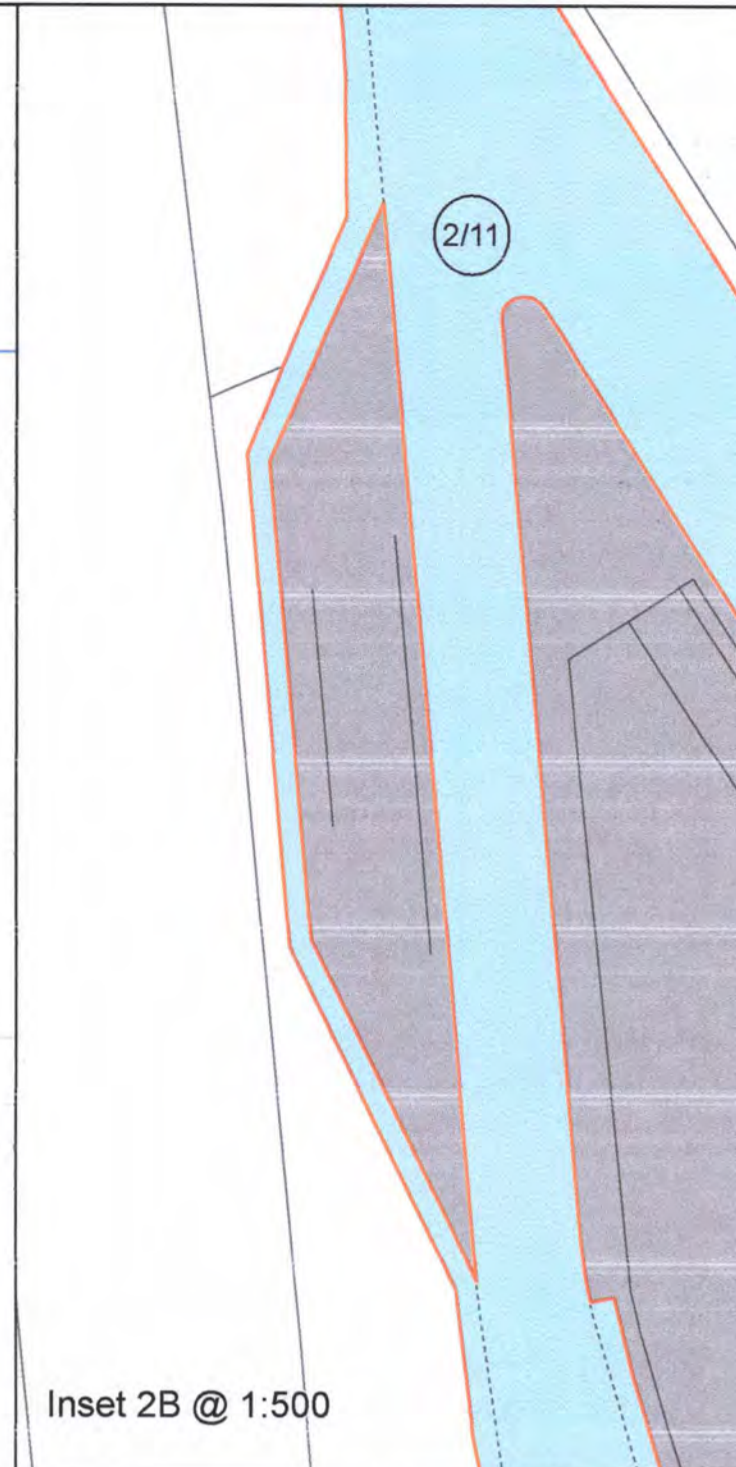



Map Centre 566060E 176084N m

0 20 40 60  
Metres



Scale @ A1 1:1,250

**Carter Jonas** 1 Chapel Place, London, W1G 0BS  
E: land.referring@carterjonas.co.uk  
carterjonas.co.uk

**Client:**  
**nationalgrid** 1-3 Strand, London, WC2N 5EH  
T: +44 (0)207043000  
https://www.nationalgrid.com

**Project:**  
Grain to Tilbury

**Title:**  
MAP REFERRED TO IN THE  
NATIONAL GRID ELECTRICITY  
TRANSMISSION PLC  
(GRAIN TO TILBURY) COMPULSORY  
PURCHASE ORDER 2024

**Sheet:**  
3 of 9

- Legend:**
- Order Land Boundary
  - New Rights to be Acquired
  - Land to be Acquired
  - Area not within the Order Land
  - Sheet Cut Line
  - Public Rights of Way
  - National Cycle Network



The COMMON SEAL of NATIONAL GRID ELECTRICITY TRANSMISSION PLC was hereunto affixed on the 14 day of November 2024 in the presence of:

NSGT 12/97  
MEMBER OF THE BOARD SEALING COMMITTEE

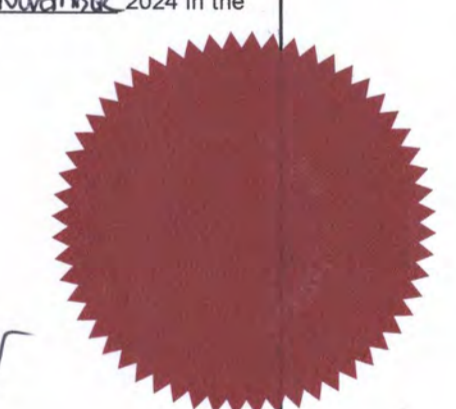

Authorised Signatory  
Member of the Board Sealing Committee

- NOTES**
1. ALL DIMENSIONS ARE IN METRES UNLESS STATED OTHERWISE.
  2. DO NOT SCALE FROM THIS DRAWING, USE ONLY PRINTED DIMENSIONS.
  3. ALL EASEMENTS, SERVITUDES AND PRIVATE RIGHTS ARE PROPOSED TO BE EXTINGUISHED ON LAND THAT IS TO BE ACQUIRED, UNLESS STATED OTHERWISE IN THE CPO SCHEDULE.
  4. THIS DRAWING IS TO BE READ IN CONJUNCTION WITH ALL OTHER PLANS AND DOCUMENTATION, IN PARTICULAR THE WORKS PLANS AND THE CPO SCHEDULE.

THIS DOCUMENT HAS BEEN PREPARED PURSUANT TO AND SUBJECT TO THE TERMS OF CARTER JONAS' APPOINTMENT BY ITS CLIENT. CARTER JONAS ACCEPTS NO LIABILITY FOR ANY USE OF THIS DOCUMENT OTHER THAN BY ITS ORIGINAL CLIENT OR FOLLOWING CARTER JONAS' EXPRESS AGREEMENT TO SUCH USE, AND ONLY FOR THE PURPOSES FOR WHICH IT WAS PREPARED AND PROVIDED.

Drawn By: RL Date: 06/11/2024

Checked By: AP Dwg no: J0077128-24-08

Inset 3A @ 1:20

Inset 3C @ 1:500

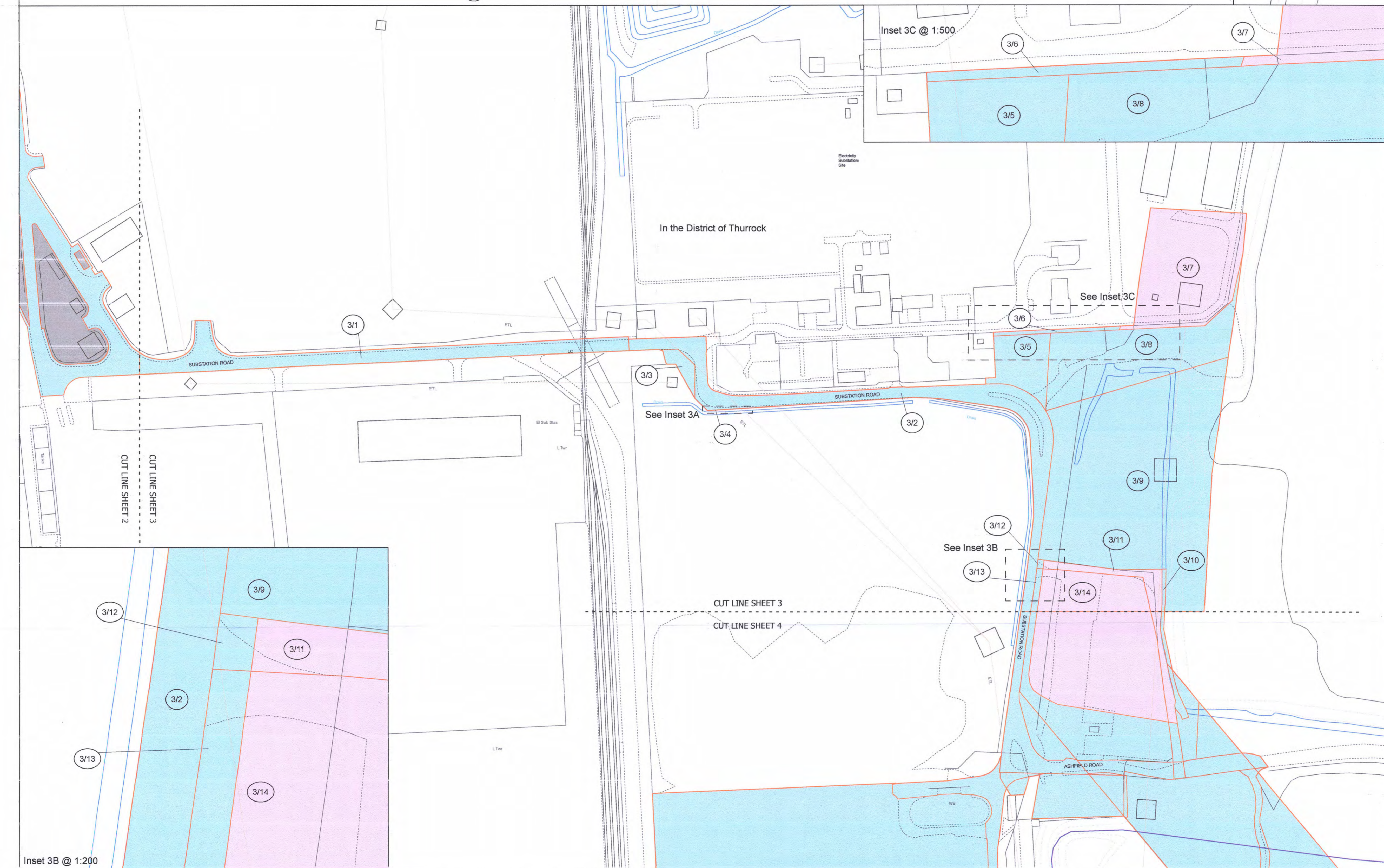

Inset 3B @ 1:200



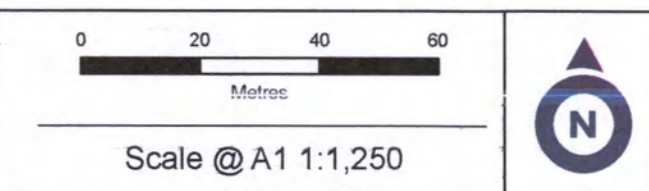
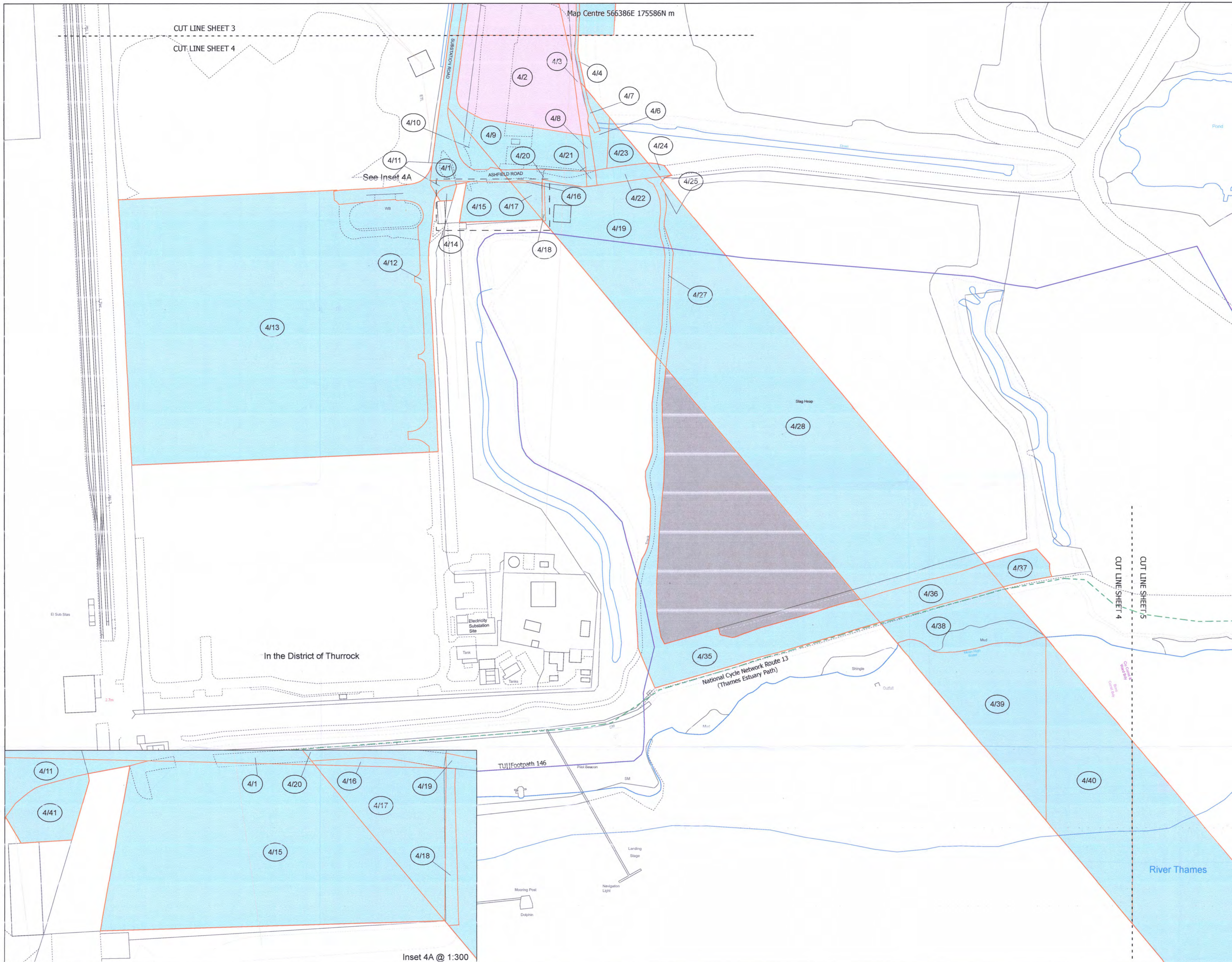

**Carter Jonas** 1 Chapel Place, London, W1G 0BQ  
 E: land.referrals@carterjonas.co.uk  
 carterjonas.co.uk

**Client:**  
**nationalgrid** 1-3 Strand, London, WC2N 6EH  
 T: +44 (0)2070430000  
 https://www.nationalgrid.com

**Project:**  
 Grain to Tilbury

**Title:**  
 MAP REFERRED TO IN THE  
 NATIONAL GRID ELECTRICITY  
 TRANSMISSION PLC  
 (GRAIN TO TILBURY) COMPULSORY  
 PURCHASE ORDER 2024

**Sheet:**  
 4 of 9

- Legend:**
- Order Land Boundary
  - New Rights to be Acquired
  - Land to be Acquired
  - Area not within the Order Land
  - Sheet Cut Line
  - Public Rights of Way
  - National Cycle Network

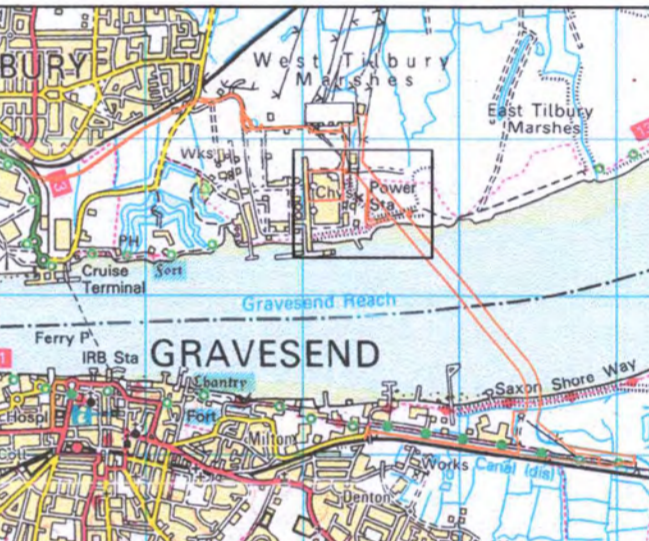

The COMMON SEAL of NATIONAL GRID ELECTRICITY TRANSMISSION PLC was hereunto affixed on the 14 day of November 2024 in the presence of:

*[Signature]*  
 MEMBER OF THE BOARD SEALING COMMITTEE  
 NGET 12/97

Authorised Signatory  
 Member of the Board Sealing Committee

- NOTES**
1. ALL DIMENSIONS ARE IN METRES UNLESS STATED OTHERWISE.
  2. DO NOT SCALE FROM THIS DRAWING, USE ONLY PRINTED DIMENSIONS.
  3. ALL EASEMENTS, SERVITUDES AND PRIVATE RIGHTS ARE PROPOSED TO BE EXTINGUISHED ON LAND THAT IS TO BE ACQUIRED, UNLESS STATED OTHERWISE IN THE CPO SCHEDULE.
  4. THIS DRAWING IS TO BE READ IN CONJUNCTION WITH ALL OTHER PLANS AND DOCUMENTATION, IN PARTICULAR THE WORKS PLANS AND THE CPO SCHEDULE.

THIS DOCUMENT HAS BEEN PREPARED PURSUANT TO AND SUBJECT TO THE TERMS OF CARTER JONAS' APPOINTMENT BY ITS CLIENT.  
 CARTER JONAS ACCEPTS NO LIABILITY FOR ANY USE OF THIS DOCUMENT OTHER THAN BY ITS ORIGINAL CLIENT OR FOLLOWING CARTER JONAS' EXPRESS AGREEMENT TO SUCH USE, AND ONLY FOR THE PURPOSES FOR WHICH IT WAS PREPARED AND PROVIDED.

Drawn By: RL Date: 06/11/2024  
 Checked By: AP Dwg no: J0077128-24-08

Inset 4A @ 1:300



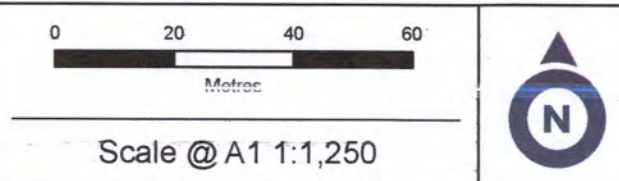
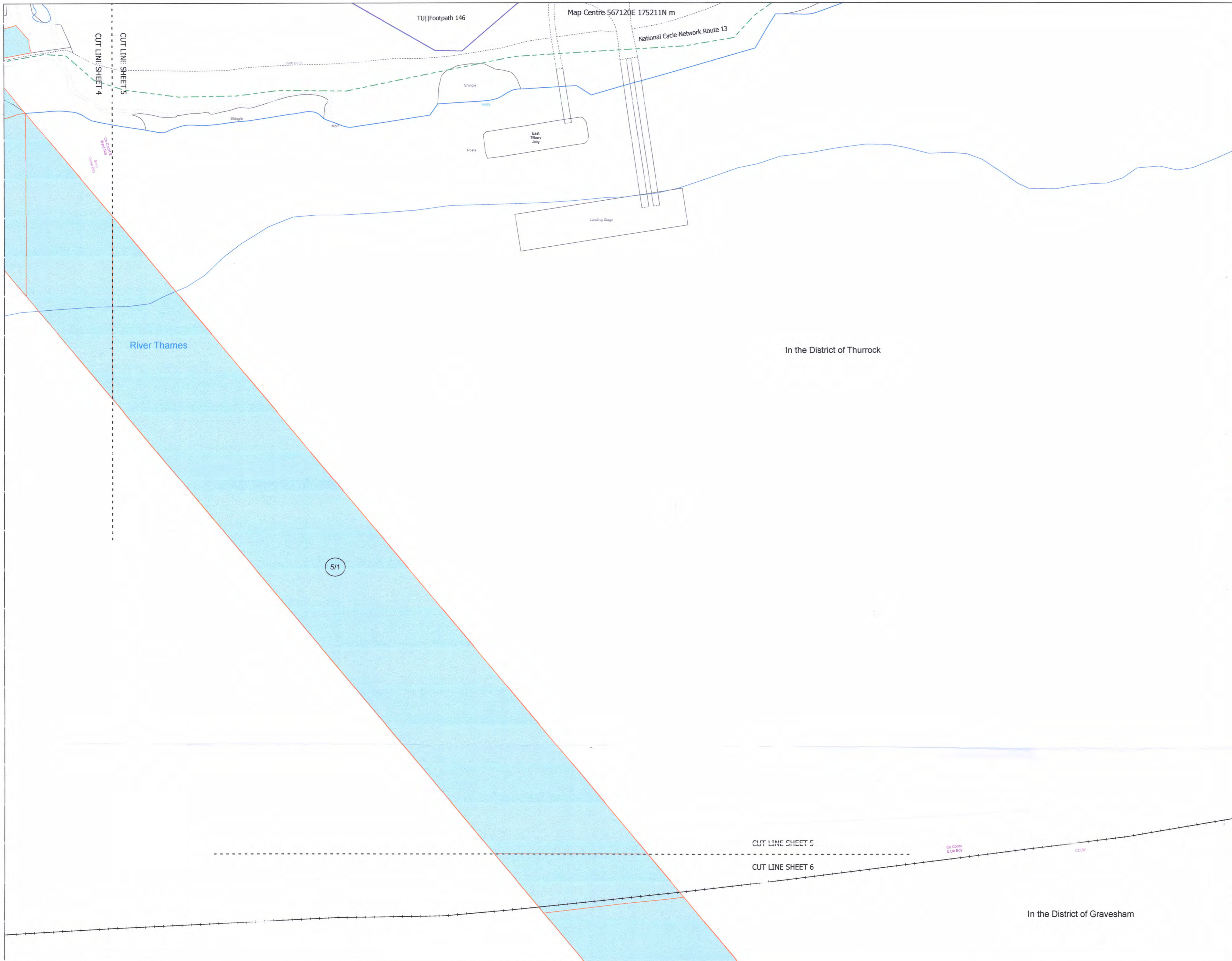

Carter Jonas  
 1 Chapel Place, London, W1G 0BQ  
 E: land.referenc@carterjonas.co.uk  
 T: +44 (0)207043000  
 www.carterjonas.co.uk

**Client:**  
 nationalgrid  
 1-3 Strand, London, WC2N 0EH  
 T: +44 (0)207043000  
 https://www.nationalgrid.com

**Project:**  
 Grain to Tilbury

**Title:**  
 MAP REFERRED TO IN THE  
 NATIONAL GRID ELECTRICITY  
 TRANSMISSION PLC  
 (GRAIN TO TILBURY) COMPULSORY  
 PURCHASE ORDER 2024

**Sheet:**  
 5 of 9

- Legend:**
- Order Land Boundary
  - New Rights to be Acquired
  - Land to be Acquired
  - Area not within the Order Land
  - Sheet Cut Line
  - Public Rights of Way
  - National Cycle Network

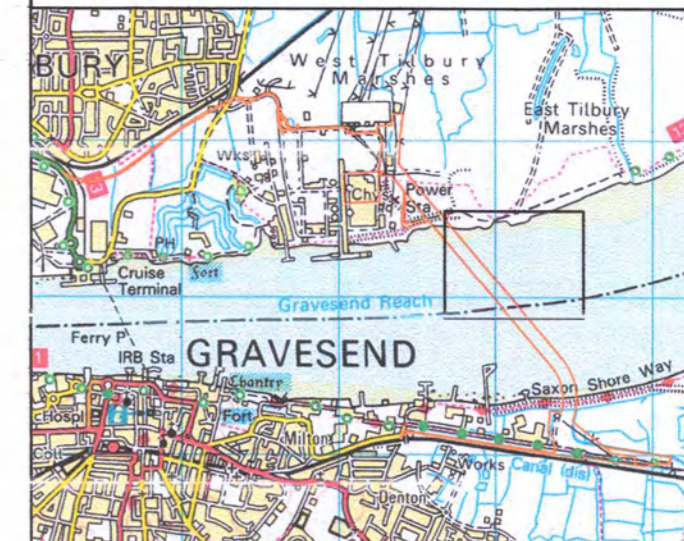

The COMMON SEAL of NATIONAL GRID ELECTRICITY TRANSMISSION PLC was hereunto affixed on the 14 day of November 2024 in the presence of:

N/EP 12/99  
 MEMBER OF THE BOARD SEALING COMMITTEE  
  

Authorised Signatory  
 Member of the Board Sealing Committee

- NOTES**
1. ALL DIMENSIONS ARE IN METRES UNLESS STATED OTHERWISE.
  2. DO NOT SCALE FROM THIS DRAWING, USE ONLY PRINTED DIMENSIONS.
  3. ALL EASEMENTS, SERVITUDES AND PRIVATE RIGHTS ARE PROPOSED TO BE EXTINGUISHED ON LAND THAT IS TO BE ACQUIRED, UNLESS STATED OTHERWISE IN THE CPO SCHEDULE.
  4. THIS DRAWING IS TO BE READ IN CONJUNCTION WITH ALL OTHER PLANS AND DOCUMENTATION, IN PARTICULAR THE WORKS PLANS AND THE CPO SCHEDULE.

THIS DOCUMENT HAS BEEN PREPARED PURSUANT TO AND SUBJECT TO THE TERMS OF CARTER JONAS APPOINTMENT BY ITS CLIENT. CARTER JONAS ACCEPTS NO LIABILITY FOR ANY USE OF THIS DOCUMENT OTHER THAN BY ITS ORIGINAL CLIENT OR FOLLOWING CARTER JONAS' EXPRESS AGREEMENT TO SUCH USE, AND ONLY FOR THE PURPOSES FOR WHICH IT WAS PREPARED AND PROVIDED.

Drawn By: RL Date: 06/11/2024  
 Checked By: AP Dwg no: J0077128-24-08



Map Centre 567393E 174642N m

In the District of Thurrock

CUT LINE SHEET 5

CUT LINE SHEET 6

6/1

6/2

6/3

In the District of Gravesham

River Thames

CUT LINE SHEET 6

CUT LINE SHEET 8

CUT LINE SHEET 6

CUT LINE SHEET 7

KTING1 (Saxon Shore Way)

KTING1 (Saxon Shore Way)

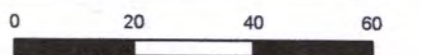

Scale @ A1 1:1,250



Carter Jonas 1 Chapel Place, London, W1G 0BG  
E: land.reference@carterjonas.co.uk  
carterjonas.co.uk

Client:  
nationalgrid 1-3 Strand, London, WC2N 6EH  
T: +44 (0)207045000  
https://www.nationalgrid.com

Project:  
Grain to Tilbury

Title:  
MAP REFERRED TO IN THE  
NATIONAL GRID ELECTRICITY  
TRANSMISSION PLC  
(GRAIN TO TILBURY) COMPULSORY  
PURCHASE ORDER 2024

Sheet:  
6 of 9

Legend:

- Order Land Boundary
- New Rights to be Acquired
- Land to be Acquired
- Area not within the Order Land
- Sheet Cut Line
- Public Rights of Way
- National Cycle Network



The COMMON SEAL of NATIONAL GRID  
ELECTRICITY TRANSMISSION PLC was hereunto  
affixed on the 14 day of November 2024 in the  
presence of:

*[Signature]*  
MEMBER OF THE BOARD SEALING COMMITTEE  
14/11/24



Authorised Signatory  
Member of the Board Sealing Committee

- NOTES
1. ALL DIMENSIONS ARE IN METRES UNLESS STATED OTHERWISE.
  2. DO NOT SCALE FROM THIS DRAWING, USE ONLY PRINTED DIMENSIONS.
  3. ALL EASEMENTS, SERVITUDES AND PRIVATE RIGHTS ARE PROPOSED TO BE EXTINGUISHED ON LAND THAT IS TO BE ACQUIRED, UNLESS STATED OTHERWISE IN THE CPO SCHEDULE.
  4. THIS DRAWING IS TO BE READ IN CONJUNCTION WITH ALL OTHER PLANS AND DOCUMENTATION, IN PARTICULAR THE WORKS PLANS AND THE CPO SCHEDULE.

THIS DOCUMENT HAS BEEN PREPARED PURSUANT TO AND SUBJECT TO THE TERMS OF CARTER JONAS APPOINTMENT BY ITS CLIENT.  
CARTER JONAS ACCEPTS NO LIABILITY FOR ANY USE OF THIS DOCUMENT OTHER THAN BY ITS ORIGINAL CLIENT OR FOLLOWING CARTER JONAS' EXPRESS AGREEMENT TO SUCH USE, AND ONLY FOR THE PURPOSES FOR WHICH IT WAS PREPARED AND PROVIDED.

Drawn By: RL Date: 06/11/2024

Checked By: AP Dwg no: J007128-24-08



Map Centre 567781E 174114N m

Inset 7A @ 1:150

0 20 40 60  
Metres

Scale @ A1 1:1,250



**Carter Jonas**  
1 Chapel Place, London, W1G 8EG  
E: land.referrals@carterjonas.co.uk  
www.carterjonas.co.uk

**Client:**  
**nationalgrid**  
1-3 Strand, London, WC2N 5EH  
T: +44 (0)2070000000  
https://www.nationalgrid.com

**Project:**  
Grain to Tilbury

**Title:**  
MAP REFERRED TO IN THE  
NATIONAL GRID ELECTRICITY  
TRANSMISSION PLC  
(GRAIN TO TILBURY) COMPULSORY  
PURCHASE ORDER 2024

**Sheet:**  
7 of 9

- Legend:**
- Order Land Boundary
  - New Rights to be Acquired
  - Land to be Acquired
  - Area not within the Order Land
  - Sheet Cut Line
  - Public Rights of Way
  - National Cycle Network

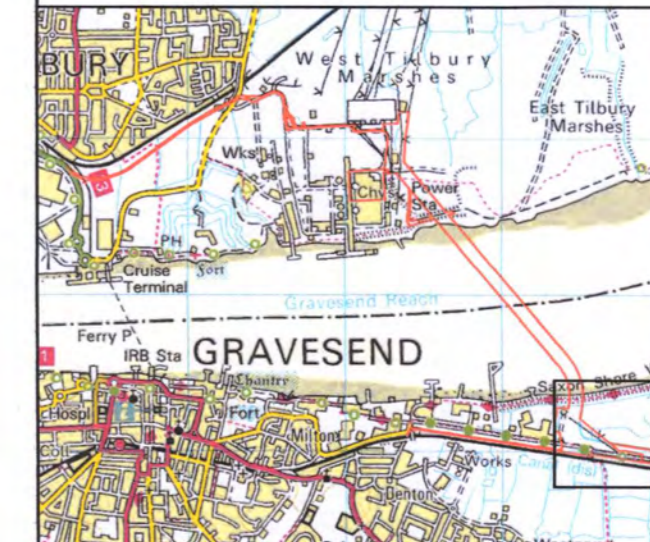

The COMMON SEAL of NATIONAL GRID ELECTRICITY TRANSMISSION PLC was hereunto affixed on the 14 day of November 2024 in the presence of:

*[Signature]*  
MEMBER OF THE BOARD SEALING COMMITTEE  
N/G/T 12197



Authorised Signatory  
Member of the Board Sealing Committee

- NOTES**
1. ALL DIMENSIONS ARE IN METRES UNLESS STATED OTHERWISE.
  2. DO NOT SCALE FROM THIS DRAWING, USE ONLY PRINTED DIMENSIONS.
  3. ALL EASEMENTS, SERVITUDES AND PRIVATE RIGHTS ARE PROPOSED TO BE EXTINGUISHED ON LAND THAT IS TO BE ACQUIRED, UNLESS STATED OTHERWISE IN THE CPO SCHEDULE.
  4. THIS DRAWING IS TO BE READ IN CONJUNCTION WITH ALL OTHER PLANS AND DOCUMENTATION, IN PARTICULAR THE WORKS PLANS AND THE CPO SCHEDULE.

THIS DOCUMENT HAS BEEN PREPARED PURSUANT TO AND SUBJECT TO THE TERMS OF CARTER JONAS' APPOINTMENT BY ITS CLIENT.  
CARTER JONAS ACCEPTS NO LIABILITY FOR ANY USE OF THIS DOCUMENT OTHER THAN BY ITS ORIGINAL CLIENT OR FOLLOWING CARTER JONAS' EXPRESS AGREEMENT TO SUCH USE, AND ONLY FOR THE PURPOSES FOR WHICH IT WAS PREPARED AND PROVIDED.

Drawn By: RL Date: 05/11/2024  
Checked By: AP Dwg no: J0077128-24-08

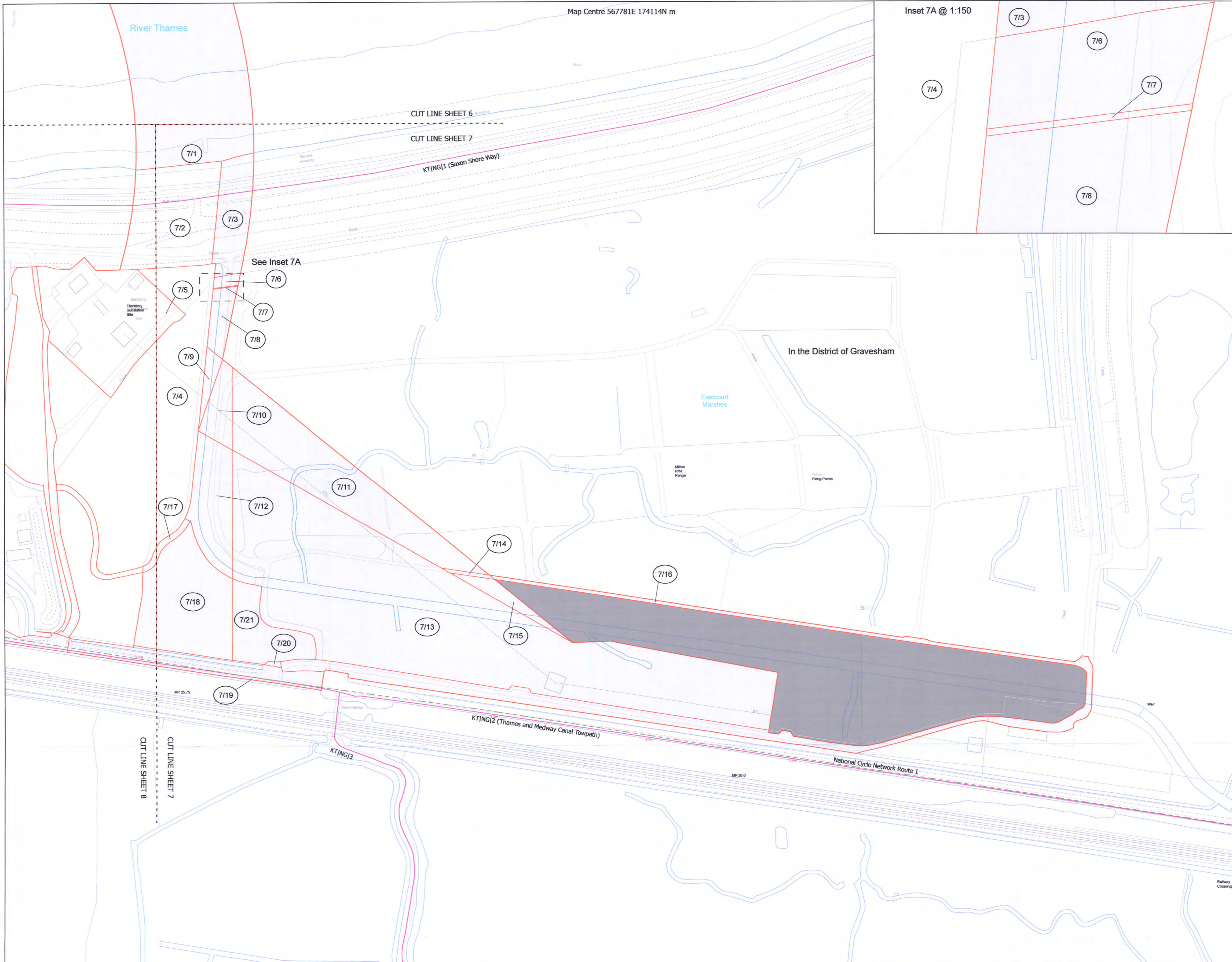



Map Centre 567111E 174114N m

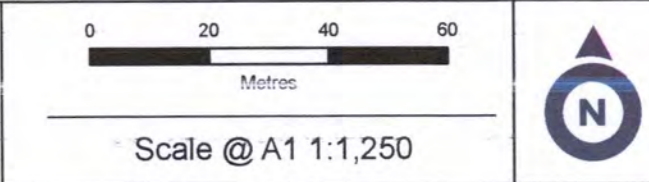

Scale @ A1 1:1,250

**Carter Jonas**  
1 Chancery Place, London, WC1A 3RG  
E: land.referring@carterjonas.co.uk  
carterjonas.co.uk

**Client:**  
**nationalgrid**  
1-3 Strand, London, WC2N 5EH  
T: +44 (0)2070403000  
https://www.nationalgrid.com

**Project:**  
Grain to Tilbury

**Title:**  
MAP REFERRED TO IN THE  
NATIONAL GRID ELECTRICITY  
TRANSMISSION PLC  
(GRAIN TO TILBURY) COMPULSORY  
PURCHASE ORDER 2024

**Sheet:**  
8 of 9

- Legend:**
- Order Land Boundary
  - New Rights to be Acquired
  - Land to be Acquired
  - Area not within the Order Land
  - Sheet Cut Line
  - Public Rights of Way
  - National Cycle Network



The COMMON SEAL of NATIONAL GRID ELECTRICITY TRANSMISSION PLC was hereunto affixed on the 14 day of November 2024 in the presence of:

*[Signature]*  
MEMBER OF THE BOARD SEALING COMMITTEE  
NS/C 12/97



Authorised Signatory  
Member of the Board Sealing Committee

- NOTES**
1. ALL DIMENSIONS ARE IN METRES UNLESS STATED OTHERWISE.
  2. DO NOT SCALE FROM THIS DRAWING, USE ONLY PRINTED DIMENSIONS.
  3. ALL EASEMENTS, SERVITUDES AND PRIVATE RIGHTS ARE PROPOSED TO BE EXTINGUISHED ON LAND THAT IS TO BE ACQUIRED, UNLESS STATED OTHERWISE IN THE CPO SCHEDULE.
  4. THIS DRAWING IS TO BE READ IN CONJUNCTION WITH ALL OTHER PLANS AND DOCUMENTATION, IN PARTICULAR THE WORKS PLANS AND THE CPO SCHEDULE.

THIS DOCUMENT HAS BEEN PREPARED PURSUANT TO AND SUBJECT TO THE TERMS OF CARTER JONAS' APPOINTMENT BY ITS CLIENT. CARTER JONAS ACCEPTS NO LIABILITY FOR ANY USE OF THIS DOCUMENT OTHER THAN BY ITS ORIGINAL CLIENT OR FOLLOWING CARTER JONAS' EXPRESS AGREEMENT TO SUCH USE, AND ONLY FOR THE PURPOSES FOR WHICH IT WAS PREPARED AND PROVIDED.

Drawn By: RL Date: 05/11/2024

Checked By: AP Dwg no: J0077128-24-08

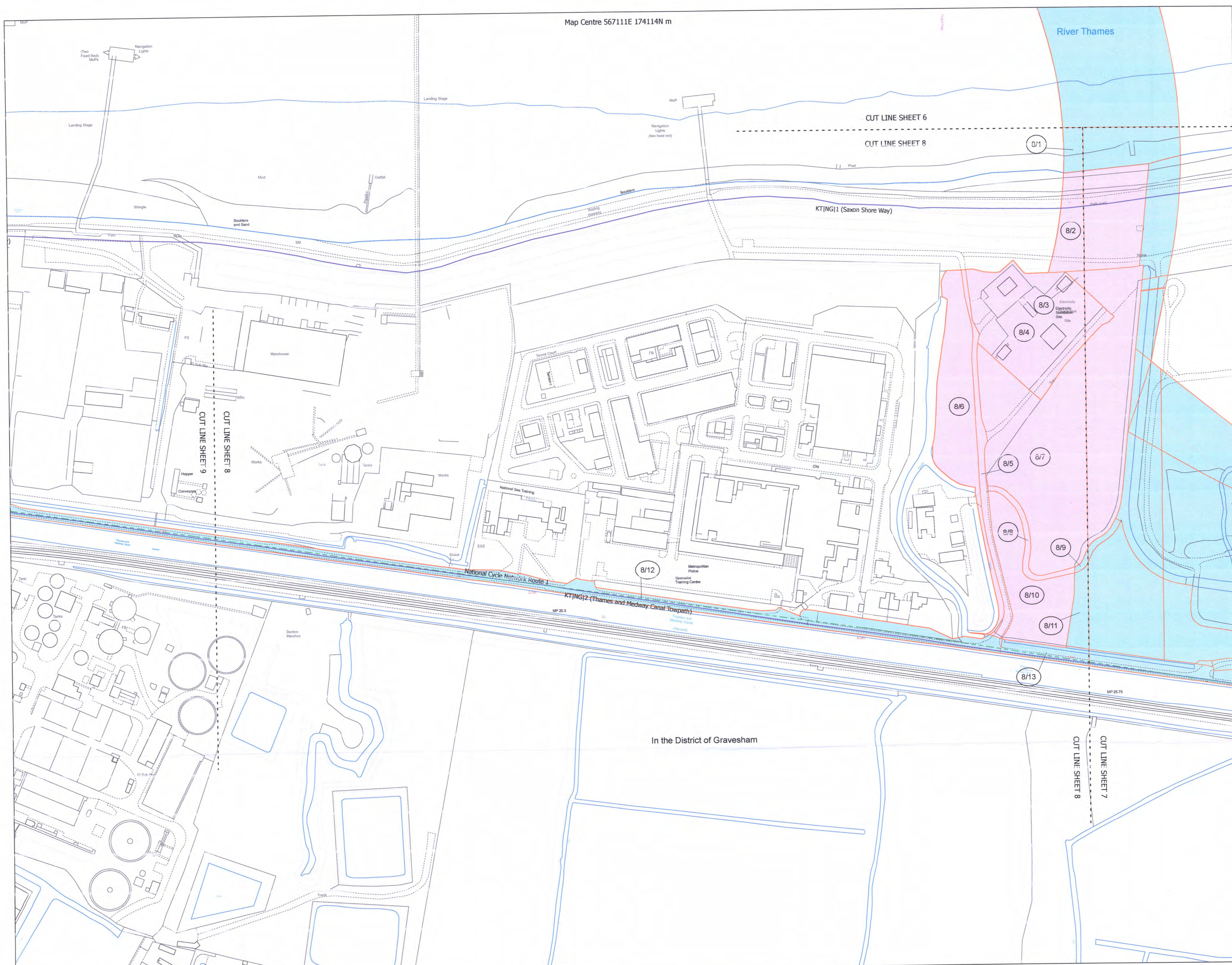

In the District of Gravesend



