

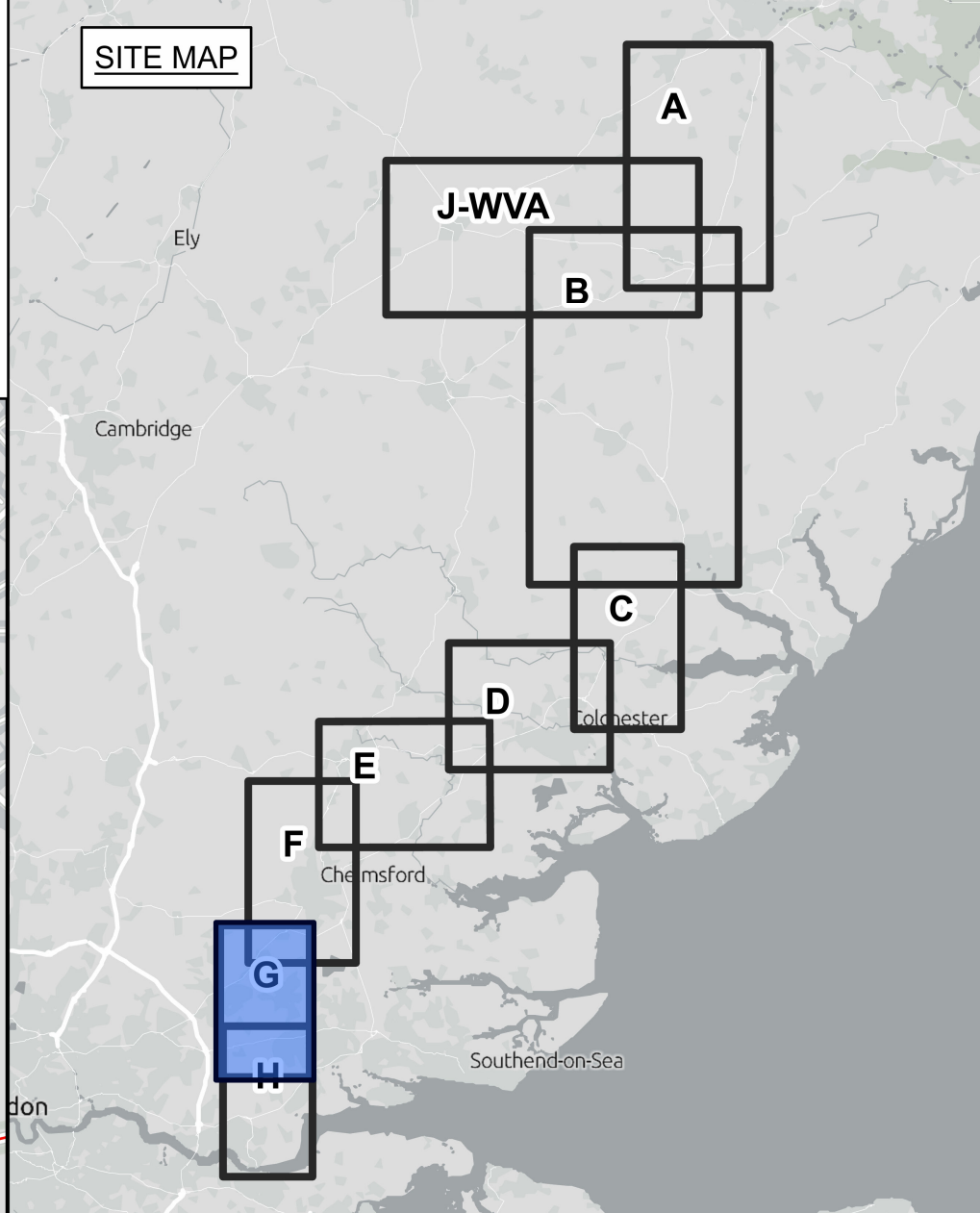

NATIONAL GRID
(NORWICH TO TILBURY)
S.42 CONSULTATION CONSTRUCTION ACCESS KEY PLAN
SECTION G (SHEET 1 OF 1,
BRENTWOOD BOROUGH COUNCIL AND BASILDON BOROUGH COUNCIL)

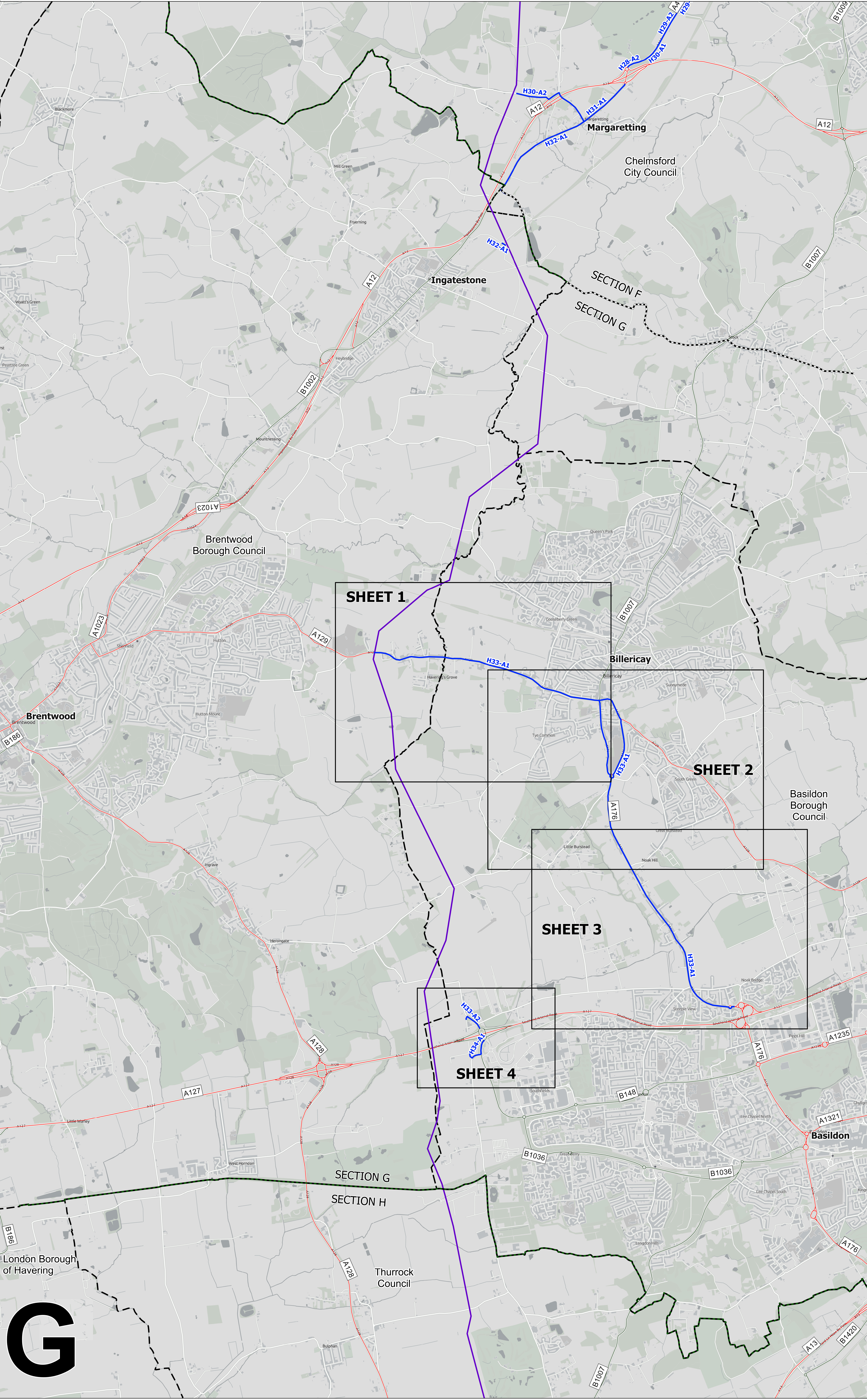

- Legend**
- Sheet index
 - Local authority boundary
 - Section boundary and local authority boundary
 - Section boundary
- Existing roads**
- A road
 - B road
- Proposed project design details**
- Existing / proposed extension or proposed new substation boundary
 - New overhead line
 - Primary access route (no works anticipated)



Notes

This drawing is scaled at paper size A0, therefore any prints taken at smaller sizes will affect accuracy of the measurement units and should not be scaled against.

The proposed overhead alignment and proposed underground alignment together comprise the 2024 preferred draft alignment.

Any drawing errors or discrepancies should be brought to the attention of Mott MacDonald.

Drawing information is preliminary and subject to detailed design.

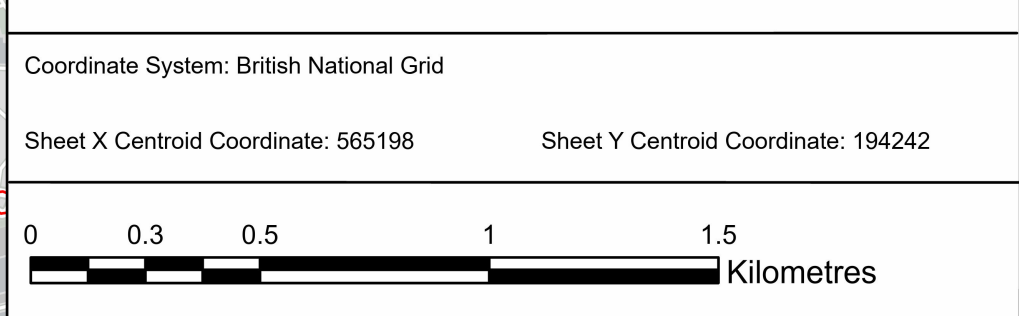

BACKGROUND MAPPING INFORMATION HAS BEEN REPRODUCED FROM THE ORDNANCE SURVEY BY PERMISSION OF ORDNANCE SURVEY OF THE CONTROLLER OF HER MAJESTY'S STATIONERY OFFICE. © CROWN COPYRIGHT AND DATABASE RIGHTS (2024) CONTAINS OR DATA © CROWN COPYRIGHT AND DATABASE RIGHT 2023. CONTAINS DATA FROM OS ZOOMSTACK OFFICE FOR NATIONAL STATISTICS LICENCED UNDER THE OPEN GOVERNMENT LICENCE V3.0

Issue	Date	Remarks	Drawn	Checked	Approved
A	April 2024	FOR STATUTORY CONSULTATION	AJM	WES	DR

NATIONAL GRID
(NORWICH TO TILBURY)
S.42 CONSULTATION CONSTRUCTION ACCESS KEY PLAN
SECTION G (SHEET 1 OF 1,
BRENTWOOD BOROUGH COUNCIL AND BASILDON BOROUGH COUNCIL)

National Grid Drawing Reference
AENC-NG-ENG-PLN-0028

Scale	Sheet Size	Sheet	Issue
1:16,500	A0	SHEET 1 OF 1	A



NATIONAL GRID
(NORWICH TO TILBURY)
S.42 CONSULTATION CONSTRUCTION ACCESS PLAN
SECTION G (SHEET 1 OF 4,
BRENTWOOD BOROUGH COUNCIL)

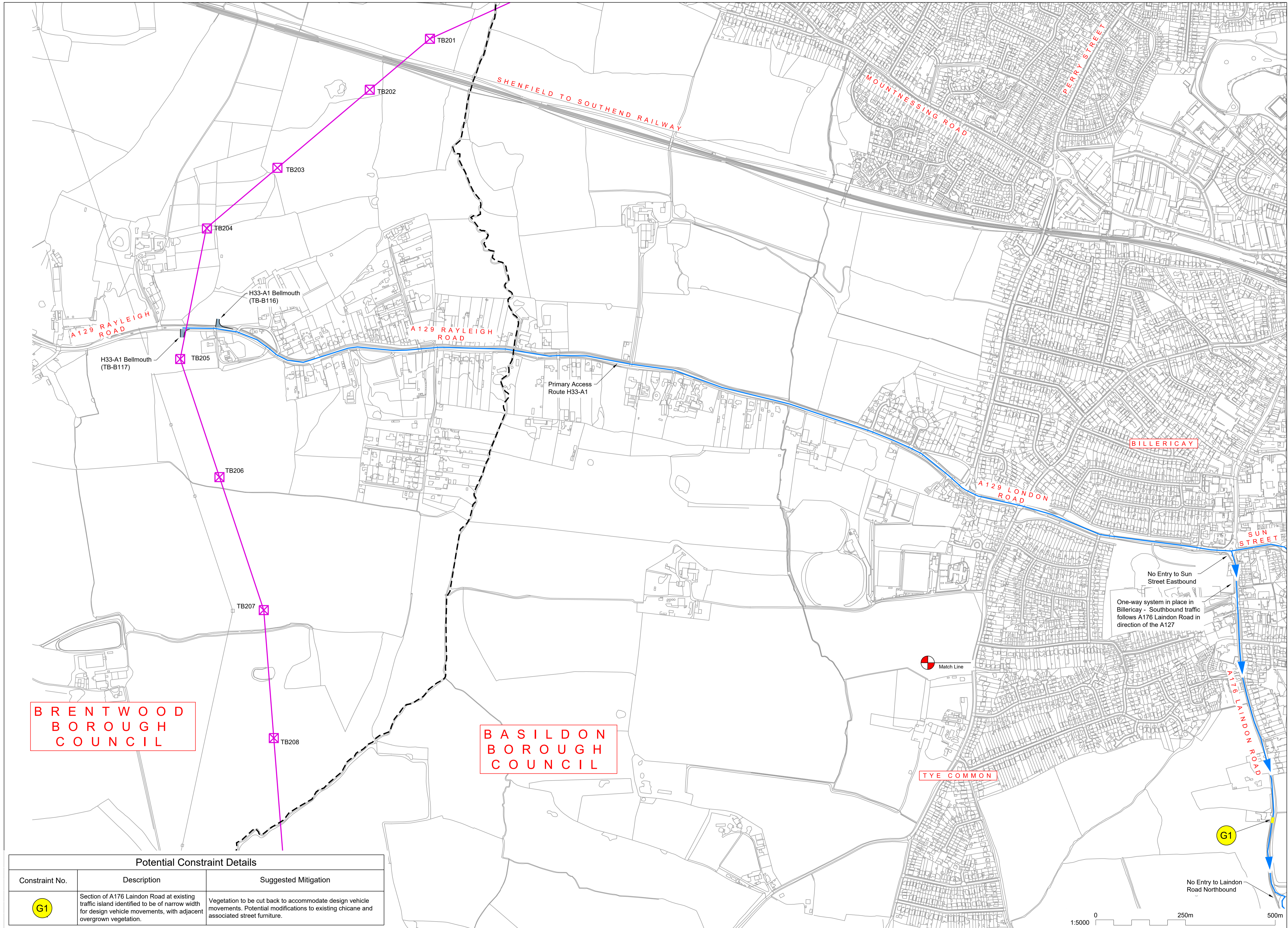

BRENTWOOD
BOROUGH
COUNCIL

BASILDON
BOROUGH
COUNCIL

TYE COMMON

G1

Potential Constraint Details

Constraint No.	Description	Suggested Mitigation
G1	Section of A176 Laindon Road at existing traffic island identified to be of narrow width for design vehicle movements, with adjacent overgrown vegetation.	Vegetation to be cut back to accommodate design vehicle movements. Potential modifications to existing chicane and associated street furniture.

- Notes
- This drawing is scaled at paper size A1. Therefore any prints taken at smaller sizes will affect accuracy of the measurement units and should not be scaled against.
 - All dimensions are in metres unless otherwise shown. All levels are in metres Above Ordnance Datum (AOD). All dimensions and levels should be checked on site.
 - Any drawing errors or discrepancies should be brought to the attention of Matt MacDonald.
 - Drawing information is based on OS information. The extent of the existing public highway has been assumed from OS mapping.
 - Extent of public highway ownership to be confirmed with Local Highway Authorities.
 - Drawing information is preliminary and subject to detailed design.
 - Details of any signage, lining, surfacing or other highways infrastructure associated with any proposed interventions are subject to agreement with the Local Highway Authority.
 - Sweep Path Analysis (SPA) has been carried out for the largest vehicles anticipated to be required to use the proposed access route, and also a typical construction movement of two-way HGV traffic.
 - Movements of all vehicles exceeding maximum legal HGV dimensions are assumed to be in one direction at a time only. It is further assumed that any such movements shall be subject to specific movement plans, including suitable escort and temporary traffic management, where required.
 - Locations of overhead line infrastructure crossing the Primary Access Route, may be impacted by the proposed construction vehicles. Vertical clearance and associated impact assessment to be confirmed with statutory undertaker. Refer to document titled Route RAG Assessment.
 - It is assumed that vegetation growth identified as within or overhanging the carriageway will be removed prior to construction activities commencing, and maintained in a suitable condition for the duration of access route use. Therefore, any such vegetation is not considered to impose additional constraint.
 - Constraints and mitigations do not include works associated with Bellmouth junctions.
 - It is assumed that all mitigation measures are removed following the completion of works, subject to agreement with the Local Highway Authority and/or National Highways.
 - Unless stated otherwise, existing bridge and culvert structures along the primary access route are assumed to take UK standard vehicle weight limits (ALLs to be considered in the abnormal case). This is to be confirmed with the Local Highway Authority prior to construction.
 - These plans show the indicative highway mitigation draft Order Limits associated with potential highway mitigation works. Further information is provided in our 'Guide to Interacting with our Consultations Plans' document.
 - The proposed overhead line alignment and proposed underground cable alignment together comprise the 2024 preferred draft alignment.

Legend

- Sheet match line
- Existing land boundary
- Local Authority Boundary
- Proposed land use
- Indicative Highway Mitigation Draft Order Limits
- Proposed project design details
- Existing, proposed extension or proposed new substation boundary
- Primary Access Route (No works anticipated)
- Proposed new private access road
- New underground cable swathe centreline
- New overhead line
- New lattice pylon
- Temporary works
- Vegetation Removal / Cutting Back / Temporary Traffic Regulation Orders
- Modifications to existing highway features
- Work within the existing highway boundary
- Work outside the existing highway boundary. Based upon assumption of highway boundary extents.
- Site Access Point (Bellmouth)

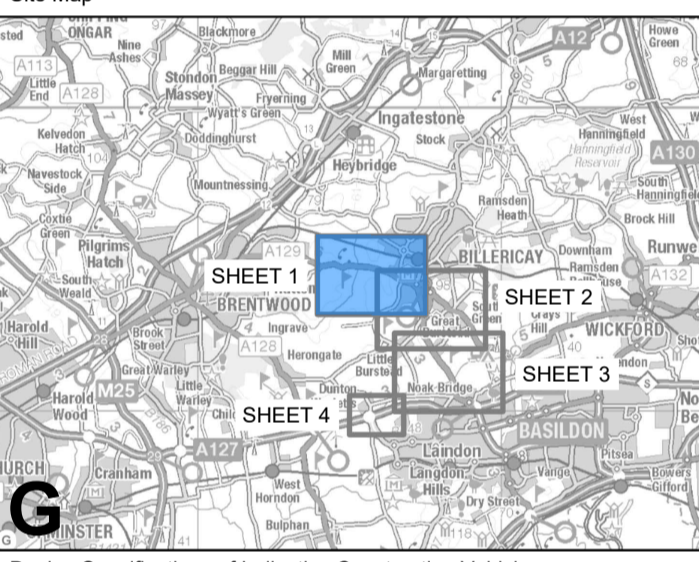

Design Specifications of Indicative Construction Vehicles

Vehicle Type	Overall Length	Overall Width	Overall Body Height	Track Width	Kerb to Kerb Radius
Mobile Crane Liebherr LTM 1250-6.1	17.835m	3.000m	4.000m	3.000m	11.624m
Low Loader HGV	16.633m	2.500m	3.396m	2.500m	6.790m

Drawing References (Section G)

For information regarding the proposed project design details please refer to the 'Consultation Plans'

Coordinate System: British National Grid
Sheet X Centroid Coordinate: 567016 Sheet Y Centroid Coordinate: 201261
BACKGROUND MAPPING INFORMATION HAS BEEN REPRODUCED FROM THE ORDNANCE SURVEY BY PERMISSION OF ORDNANCE SURVEY OF THE CONTROLLER OF HIS MAJESTY'S STATIONERY OFFICE. © CROWN COPYRIGHT AND DATABASE RIGHTS (2024) LICENCE: OS1000241 AND A1000007949.
OFFICE FOR NATIONAL STATISTICS LICENSED UNDER THE OPEN GOVERNMENT LICENCE V.3.0

Issue	Date	FOR STATUTORY CONSULTATION	Remarks	Drawn	Checked	AMR
A	April 2024			AJM	WES	AMR

Title: NATIONAL GRID (NORWICH TO TILBURY)
S.42 CONSULTATION CONSTRUCTION ACCESS PLAN
SECTION G (SHEET 1 OF 4,
BRENTWOOD BOROUGH COUNCIL)
PRIMARY ACCESS ROUTES H33-A1
GENERAL ARRANGEMENT

nationalgrid

Application Number: AENC-NG-ENG-PLN-0028

National Grid Drawing Reference: AENC-NG-ENG-PLN-0028

Scale	Sheet Size	Sheet	Issue
1:5000	A1	SHEET 1 OF 4	A



NATIONAL GRID
(NORWICH TO TILBURY)
S.42 CONSULTATION CONSTRUCTION ACCESS PLAN
SECTION G (SHEET 2 OF 4,
BRENTWOOD BOROUGH COUNCIL)

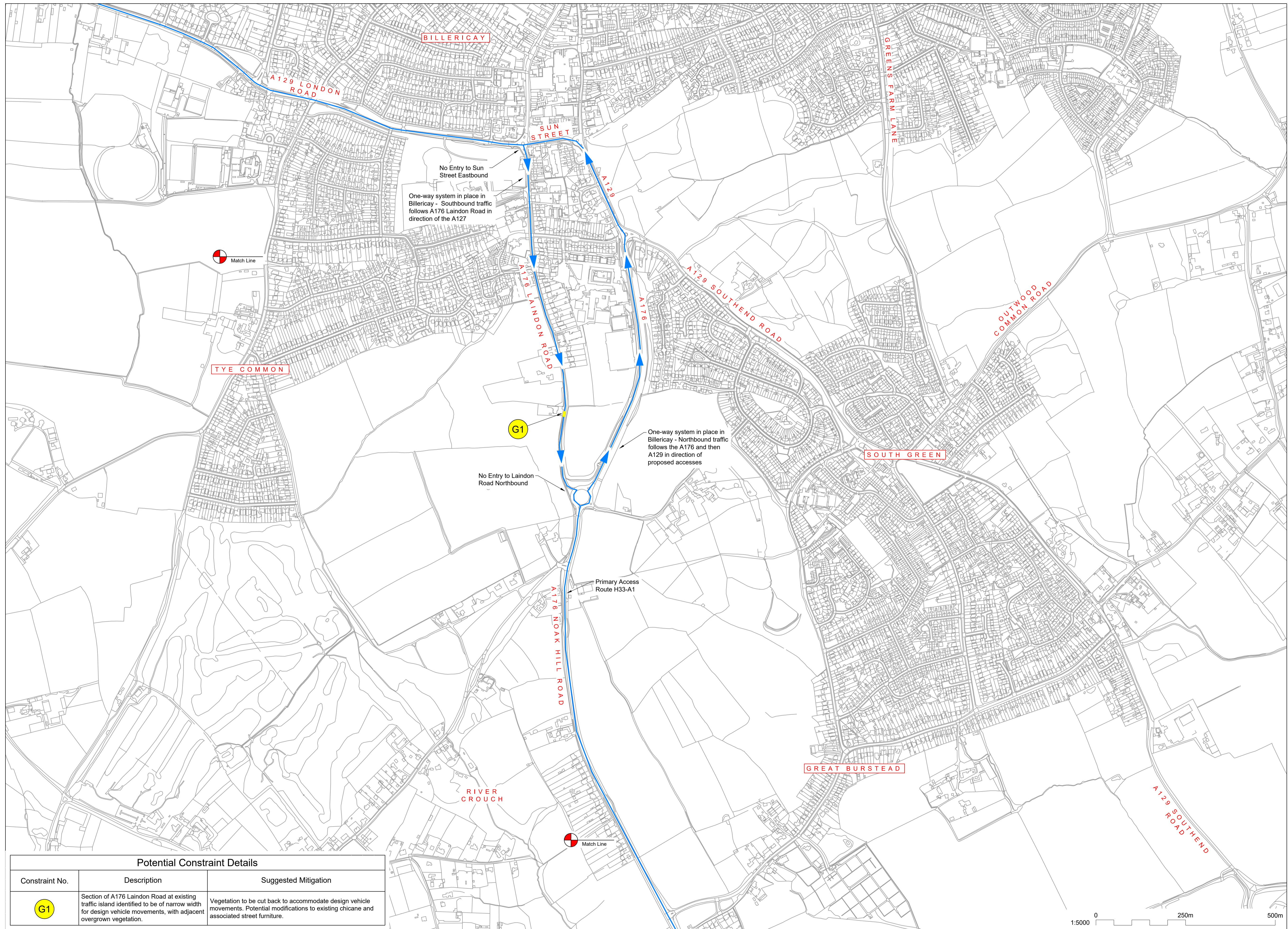

Potential Constraint Details

Constraint No.	Description	Suggested Mitigation
G1	Section of A176 Landon Road at existing traffic island identified to be of narrow width for design vehicle movements, with adjacent overgrown vegetation.	Vegetation to be cut back to accommodate design vehicle movements. Potential modifications to existing chicane and associated street furniture.

- Notes
- This drawing is scaled at paper size A1. Therefore any prints taken at smaller sizes will affect accuracy of the measurement units and should not be scaled against.
 - All dimensions are in metres unless otherwise shown. All levels are in metres Above Ordnance Datum (AOD). All dimensions and levels should be checked on site.
 - Any drawing errors or discrepancies should be brought to the attention of Matt MacDonald.
 - Drawing information is based on OS information. The extent of the existing public highway has been assumed from OS mapping.
 - Extent of public highway ownership to be confirmed with Local Highway Authorities.
 - Drawing information is preliminary and subject to detailed design.
 - Details of any signage, lining, surfacing or other highway infrastructure associated with any proposed interventions are subject to agreement with the Local Highway Authority.
 - Sweep Path Analysis (SPA) has been carried out for the largest vehicles anticipated to be required to use the proposed access route, and also a typical construction movement of two-way HGV traffic.
 - Movements of all vehicles exceeding maximum legal HGV dimensions are assumed to be in one direction at a time only. It is further assumed that any such movements shall be subject to specific movement plans, including suitable escort and temporary traffic management, where required.
 - Locations of overhead line infrastructure crossing the Primary Access Route, may be impacted by the proposed construction vehicles. Vertical clearance and associated impact assessment to be confirmed with statutory undertaker. Refer to document titled Route RAG Assessment.
 - It is assumed that vegetation growth identified as within or overhanging the carriageway will be removed prior to construction activities commencing, and maintained in a suitable condition for the duration of access route use. Therefore, any such vegetation is not considered to impose additional constraint.
 - Constraints and mitigations do not include works associated with Bellmouth junctions.
 - It is assumed that all mitigation measures are removed following the completion of works, subject to agreement with the Local Highway Authority and/or National Highways.
 - Unless stated otherwise, existing bridge and culvert structures along the primary access route are assumed to take UK standard vehicle weight limits (ALL to be considered in the abnormal case). This is to be confirmed with the Local Highway Authority prior to construction.
 - These plans show the indicative highway mitigation Draft Order Limits associated with potential highway mitigation works. Further information is provided in our 'Guide to Interacting with our Consultation Plans' document.
 - The proposed overhead line alignment and proposed underground cable alignment together comprise the 2024 preferred draft alignment.

Legend

- Sheet match line
- Local Authority Boundary
- Indicative Highway Mitigation Draft Order Limits
- Proposed project design details
 - Existing, proposed extension or proposed new substation boundary
 - Primary Access Route (No works anticipated)
 - Proposed new private access road
 - New underground cable swathe centreline
 - New overhead line
 - New lattice pylon
- Temporary works
 - Vegetation Removal / Cutting Back / Temporary Traffic Regulation Orders
 - Modifications to existing highway features
 - Work within the existing highway boundary
 - Work outside the existing highway boundary. Based upon assumption of highway boundary extents.
 - Site Access Point (Bellmouth)

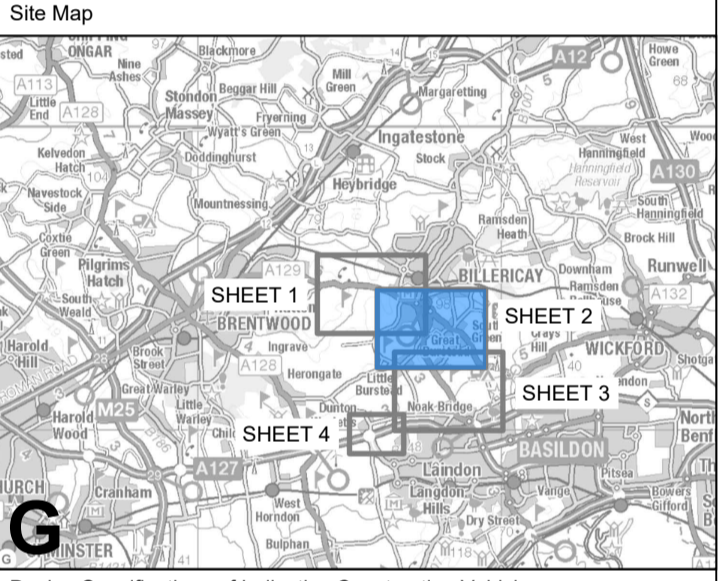

Design Specifications of Indicative Construction Vehicles

Vehicle Type	Overall Length	Overall Width	Overall Body Height	Max Track Width	Kerb to Kerb Radius
Mobile Crane Liebherr LTM 1250-6.1	17.835m	3.000m	4.000m	3.000m	11.624m
Low Loader HGV	16.633m	2.500m	3.396m	2.500m	6.700m

Drawing References (Section G)

- For information regarding the proposed project design details please refer to the 'Consultation Plans'

Coordinate System: British National Grid
 Sheet X Centroid Coordinate: 567684 Sheet Y Centroid Coordinate: 193337
 BACKGROUND MAPPING INFORMATION HAS BEEN REPRODUCED FROM THE ORDNANCE SURVEY BY PERMISSION OF ORDNANCE SURVEY OF THE CONTROLLER OF HIS MAJESTY'S STATIONARY OFFICE. © CROWN COPYRIGHT AND DATABASE RIGHTS (2024) LICENCE: OS10002411 AND A10001007949.
 OFFICE FOR NATIONAL STATISTICS LICENSED UNDER THE OPEN GOVERNMENT LICENCE V.3.0

Issue	Date	FOR STATUTORY CONSULTATION	AJM	WES	AMR
A	April 2024	FOR STATUTORY CONSULTATION	AJM	WES	AMR

Title: NATIONAL GRID (NORWICH TO TILBURY)
 S.42 CONSULTATION CONSTRUCTION ACCESS PLAN
 SECTION G (SHEET 2 OF 4, BRENTWOOD BOROUGH COUNCIL)
 PRIMARY ACCESS ROUTES H33-A1 GENERAL ARRANGEMENT

nationalgrid

Application Number: AENC-NG-ENG-PLN-0028

National Grid Drawing Reference: AENC-NG-ENG-PLN-0028

Scale	Sheet Size	Sheet	Issue
1:5000	A1	SHEET 2 OF 4	A



NATIONAL GRID
(NORWICH TO TILBURY)
S.42 CONSULTATION CONSTRUCTION ACCESS PLAN
SECTION G (SHEET 3 OF 4,
BRENTWOOD BOROUGH COUNCIL)

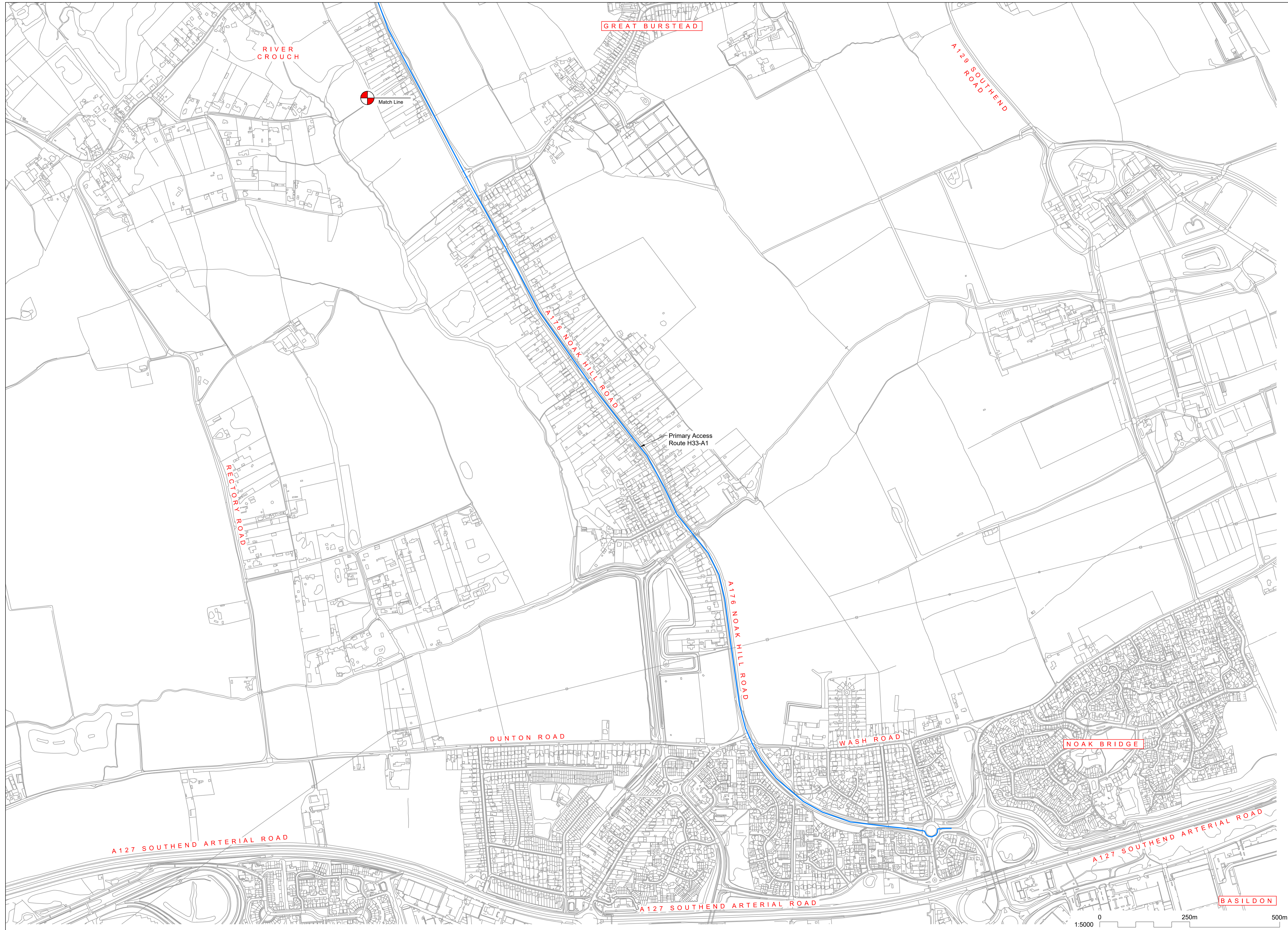

- Notes
- This drawing is scaled at paper size A1. Therefore any prints taken at smaller sizes will affect accuracy of the measurement units and should not be scaled against.
 - All dimensions are in metres unless otherwise shown. All levels are in metres Above Ordnance Datum (AOD). All dimensions and levels should be checked on site.
 - Any drawing errors or discrepancies should be brought to the attention of Matt MacDonald.
 - Drawing information is based on OS information. The extent of the existing public highway has been assumed from OS mapping.
 - Extent of public highway ownership to be confirmed with Local Highway Authorities.
 - Drawing information is preliminary and subject to detailed design.
 - Details of any signage, lining, surfacing or other highways infrastructure associated with any proposed interventions are subject to agreement with the Local Highway Authority.
 - Sweep Path Analysis (SPA) has been carried out for the largest vehicles anticipated to be required to use the proposed access route, and also a typical construction movement of two-way HGV traffic.
 - Movements of all vehicles exceeding maximum legal HGV dimensions are assumed to be in one direction at a time only. It is further assumed that any such movements shall be subject to specific movement plans, including suitable escort and temporary traffic management, where required.
 - Locations of overhead line infrastructure crossing the Primary Access Route, may be impacted by the proposed construction activities. Vertical clearance and associated impact assessment to be confirmed with statutory undertaker. Refer to document titled Route RAG Assessment.
 - It is assumed that vegetation growth identified as within or overhanging the carriageway will be removed prior to construction activities commencing, and maintained in a suitable condition for the duration of access route use. Therefore, any such vegetation is not considered to impose additional constraint.
 - Constraints and mitigations do not include works associated with Bellmouth junctions, subject to agreement with the Local Highway Authority and/or National Highways.
 - Unless stated otherwise, existing bridge and culvert structures along the primary access route are assumed to take UK standard vehicle weight limits (ALLs to be considered in the abnormal case). This is to be confirmed with the Local Highway Authority prior to construction.
 - These plans show the indicative highway mitigation draft Order Limits associated with potential highways mitigation works. Further information is provided in our 'Guide to interacting with our consultations plans' document.
 - The proposed overhead line alignment and proposed underground cable alignment together comprise the 2024 preferred draft alignment.

Legend

- Match Line
- Sheet match line
- Existing land boundary
 - Local Authority Boundary
- Proposed land use
 - Indicative Highway Mitigation Draft Order Limits
- Proposed project design details
 - Existing, proposed extension or proposed new substation boundary
 - Primary Access Route (No works anticipated)
 - Proposed new private access road
 - New underground cable swathe centreline
 - New overhead line
 - New lattice pylon
- Temporary works
 - Vegetation Removal / Cutting Back / Temporary Traffic Regulation Orders
 - Modifications to existing highway features
 - Work within the existing highway boundary
 - Work outside the existing highway boundary. Based upon assumption of highway boundary extents.
 - Site Access Point (Bellmouth)

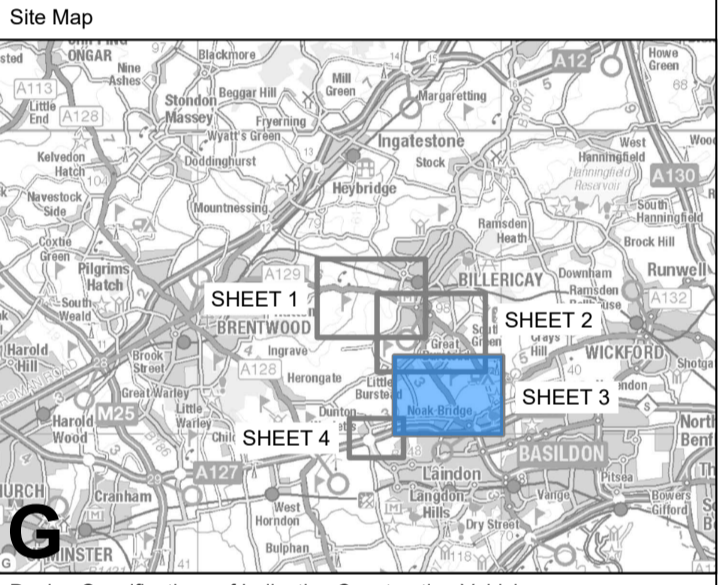

Design Specifications of Indicative Construction Vehicles

Vehicle	Overall Length	Overall Width	Overall Body Height	Track Width	Kerb to Kerb Radius
Mobile Crane Liebherr LTM 1250-6.1	17.835m	3.000m	4.000m	3.000m	11.624m
Low Loader HGV	16.633m	2.500m	3.396m	2.300m	6.790m

Drawing References (Section G)

For information regarding the proposed project design details please refer to the 'Consultation Plans'

Coordinate System: British National Grid
Sheet X Centroid Coordinate: 568255 Sheet Y Centroid Coordinate: 191270
BACKGROUND MAPPING INFORMATION HAS BEEN REPRODUCED FROM THE ORDNANCE SURVEY BY PERMISSION OF ORDNANCE SURVEY OF THE CONTROLLER OF HIS MAJESTY'S STATIONERY OFFICE. © CROWN COPYRIGHT AND DATABASE RIGHTS (2024) LICENCE: OS1000241 AND A1000007949.
OFFICE FOR NATIONAL STATISTICS LICENSED UNDER THE OPEN GOVERNMENT LICENCE V.3.0

A	April 2024	FOR STATUTORY CONSULTATION	AJM	WES	AMR
Issue	Date	Remarks	Drawn	Checked	Approved

Title NATIONAL GRID (NORWICH TO TILBURY)
S.42 CONSULTATION CONSTRUCTION
ACCESS PLAN
SECTION G (SHEET 3 OF 4,
BRENTWOOD BOROUGH COUNCIL)
PRIMARY ACCESS ROUTES H33-A1
GENERAL ARRANGEMENT

nationalgrid

Application Number

National Grid Drawing Reference AENC-NG-ENG-PLN-0028

Scale	Sheet Size	Sheet	Issue
1:5000	A1	SHEET 3 OF 4	A

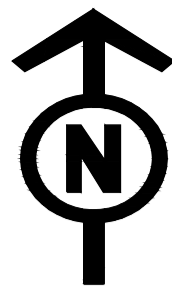

NATIONAL GRID
(NORWICH TO TILBURY)
S.42 CONSULTATION CONSTRUCTION ACCESS PLAN
SECTION G (SHEET 4 OF 4,
BASILDON DISTRICT)

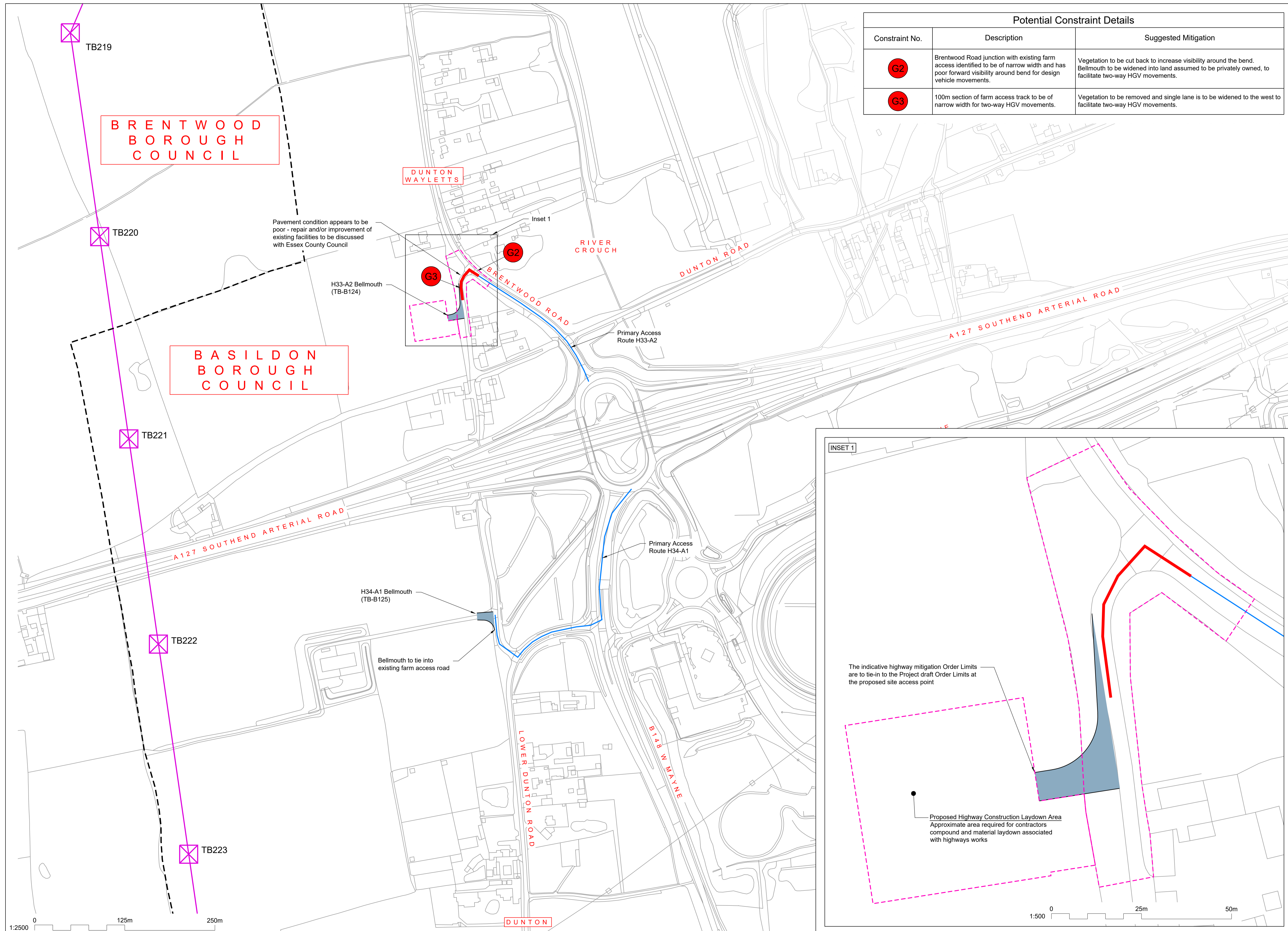

Potential Constraint Details		
Constraint No.	Description	Suggested Mitigation
G2	Brentwood Road junction with existing farm access identified to be of narrow width and has poor forward visibility around bend for design vehicle movements.	Vegetation to be cut back to increase visibility around the bend. Bellmouth to be widened into land assumed to be privately owned, to facilitate two-way HGV movements.
G3	100m section of farm access track to be of narrow width for two-way HGV movements.	Vegetation to be removed and single lane is to be widened to the west to facilitate two-way HGV movements.

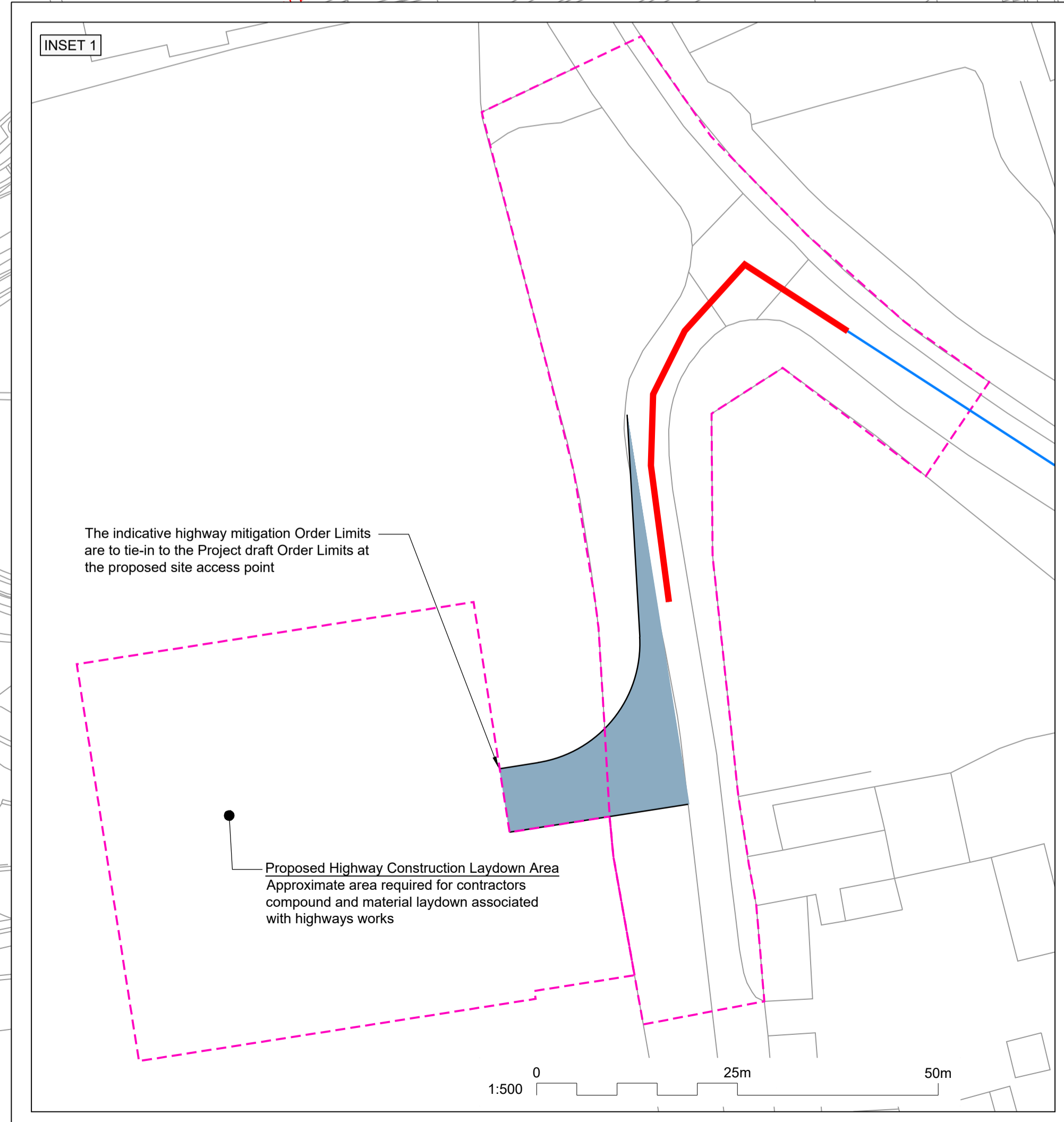

- Notes
- This drawing is scaled at paper size A1. Therefore any prints taken at smaller sizes will affect accuracy of the measurement units and should not be scaled against.
 - All dimensions are in metres unless otherwise shown. All levels are in metres Above Ordnance Datum (AOD). All dimensions and levels should be checked on site.
 - Any drawing errors or discrepancies should be brought to the attention of Matt MacDonald.
 - Drawing information is based on OS information. The extent of the existing public highway has been assumed from OS mapping.
 - Extent of public highway ownership to be confirmed with Local Highway Authorities.
 - Drawing information is preliminary and subject to detailed design.
 - Details of any signage, lining, surfacing or other highways infrastructure associated with any proposed interventions are subject to agreement with the Local Highway Authority.
 - Sweep Path Analysis (SPA) has been carried out for the largest vehicles anticipated to be required to use the proposed access route, and also a typical construction movement of two-way HGV traffic.
 - Movements of all vehicles exceeding maximum legal HGV dimensions are assumed to be in one direction at a time only. It is further assumed that any such movements shall be subject to specific movement plans, including suitable escort and temporary traffic management, where required.
 - Locations of overhead line infrastructure crossing the Primary Access Route, may be impacted by the proposed construction vehicles. Vertical clearance and associated impact assessment to be confirmed with statutory undertaker. Refer to document titled Route RAG Assessment.
 - It is assumed that vegetation growth identified as within or overhanging the carriageway will be removed prior to construction activities commencing, and maintained in a suitable condition for the duration of access route use. Therefore, any such vegetation is not considered to impose additional constraint.
 - Constraints and mitigations do not include works associated with Bellmouth junctions.
 - It is assumed that all mitigation measures are removed following the completion of works, subject to agreement with the Local Highway Authority and/or National Highways.
 - Unless stated otherwise, existing bridge and culvert structures along the primary access route are assumed to take UK standard vehicle weight limits (ALL to be considered in the abnormal case). This is to be confirmed with the Local Highway Authority prior to construction.
 - These plans show the indicative highway mitigation draft Order Limits associated with potential highways mitigation works. Further information is provided in our 'Guide to interacting with our consultations plans' document.
 - The proposed overhead line alignment and proposed underground cable alignment together comprise the 2024 preferred draft alignment.

Legend

- Sheet match line
- Existing land boundary: Local Authority Boundary
- Proposed land use: Indicative Highway Mitigation Draft Order Limits
- Proposed project design details:
 - Existing, proposed extension or proposed new substation boundary
 - Primary Access Route (No works anticipated)
 - Proposed new private access road
 - New underground cable swathe centreline
 - New overhead line
 - New lattice pylon
- Temporary works:
 - Vegetation Removal / Cutting Back / Temporary Traffic Regulation Orders
 - Modifications to existing highway features
 - Work within the existing highway boundary
 - Work outside the existing highway boundary. Based upon assumption of highway boundary extents.
 - Site Access Point (Bellmouth)

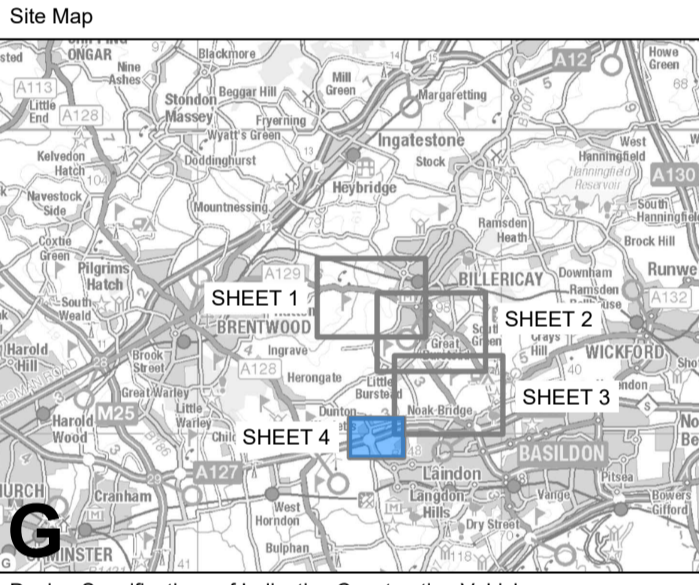

Design Specifications of Indicative Construction Vehicles

	Mobile Crane Liebherr LTM 1250-6.1	Low Loader HGV
Overall Length	17.835m	16.633m
Overall Width	3.000m	2.500m
Overall Body Height	4.000m	3.396m
Track Width	3.000m	2.500m
Kerb to Kerb Radius	11.524m	6.790m

Drawing References (Section G)

- For information regarding the proposed project design details please refer to the 'Consultation Plans'

Coordinate System: British National Grid
 Sheet X Centroid Coordinate: 565876 Sheet Y Centroid Coordinate: 189859
 BACKGROUND MAPPING INFORMATION HAS BEEN REPRODUCED FROM THE ORDNANCE SURVEY BY PERMISSION OF ORDNANCE SURVEY OF THE CONTROLLER OF HIS MAJESTY'S STATIONERY OFFICE. © CROWN COPYRIGHT AND DATABASE RIGHTS (2024) LICENCE: OS1000241 AND A2000007949.
 OFFICE FOR NATIONAL STATISTICS LICENSED UNDER THE OPEN GOVERNMENT LICENCE V.3.0

Issue	Date	FOR STATUTORY CONSULTATION	Remarks	Drawn	Checked	Approved
A	April 2024			AJM	WES	AMR

Title: NATIONAL GRID (NORWICH TO TILBURY)
 S.42 CONSULTATION CONSTRUCTION
 ACCESS PLAN
 SECTION G (SHEET 4 OF 4,
 BASILDON DISTRICT)
 PRIMARY ACCESS ROUTES H33-A2 AND H34-A1
 GENERAL ARRANGEMENT

nationalgrid
 Application Number
 National Grid Drawing Reference: AENC-NG-ENG-PLN-0028
 Scale: 1:2500 Sheet Size: A1 Sheet: SHEET 4 OF 4 Issue: A