

DATED

1 November

2023

NATIONAL GRID ELECTRICITY TRANSMISSION PLC

GENERAL VESTING DECLARATION

**Relating to The National Grid (Hinkley
Point C Connection Project) Order 2016**

Relating to Land at Woolavington, East Huntspill, Mark, Vole and
Tarnock, Somerset

Stage 7.1



BDB PITMANS

Registered Office

One Bartholomew Close
London
EC1A 7BL
DX 339401 London Wall

50/60 Station Road
Cambridge
CB1 2JH
DX 339601 Cambridge 24

The Anchorage
34 Bridge Street
Reading, RG1 2LU
DX 146420 Reading 21

Grosvenor House
Grosvenor Square
Southampton, SO15 2BE
DX 38516 Southampton 3

T +44 (0)345 222 9222

W www.bdbpitmans.com

THE NATIONAL GRID (HINKLEY POINT C CONNECTION PROJECT) ORDER 2016

THIS **GENERAL VESTING DECLARATION** is made on the 1st day of November 2023 by the **Company**

WHEREAS:

- (A) On 19 January 2016 the Order was made by authority of the Secretary of State for Energy and Climate Change under the powers conferred on her by section 114 of the Planning Act 2008 authorising the Company to acquire the rights and to impose the restrictions specified in the Second Schedule.
- (B) The Order came into force on 9 February 2016.
- (C) A subsequent notice given and published in the Somerset County Gazette on 3 November 2022 (the **s3 Notice**), before the service of any notice to treat in respect of any of the rights and restrictions described in the Second Schedule, included the particulars specified in section 3(3) of the Act, as modified by the Order.
- (D) The s3 Notice did not specify a period longer than two months beginning with the date of publication of the s3 Notice as the period before the end of which this general vesting declaration could not be executed.

NOW THIS DEED WITNESSETH that, in exercise of the powers conferred on it by section 4 of the Act as applied and modified by article 25 of the Order, the Company hereby declares as follows:

1 Vesting of the benefit of Rights and Restrictions

As from the end of the period of 28 days from the date on which the service of notices required by section 6 of the Act is completed (save insofar that they comprise or affect interests of Excluded Persons in such land) in relation to each Plot listed in column 1 of the Second Schedule:

- 1.1 the Rights listed in column 3 of the Second Schedule;
- 1.2 the right to enforce the Overhead Restrictions listed in column 4 of the Second Schedule; and
- 1.3 the right to enforce the Access Restrictions listed in column 4 of the Second Schedule;

shall vest in the Company.

2 Interests to benefit from Rights and Restrictions

In relation to each Plot the Rights described in column 3 of the Second Schedule shall vest in and be exercisable and the benefit of the Overhead Restrictions and the Access Restrictions described in column 4 of the Second Schedule shall vest in and be enforceable by the Company for the benefit of and for all purposes connected with:

2.1 the land comprised in the Company's Title's or such parts thereof as are capable of benefitting from the same; and

2.2 such other parts of the Company's Undertaking as are capable of benefitting from the same.

3 **Highways and Utilities**

This Declaration shall not have effect of vesting in the Company any interest or right in:

3.1 any Highway, although for the avoidance of doubt, this exclusion does not prevent the vesting of rights in land which is horizontally or vertically adjacent to the Highway; or

3.2 any Utility Conduit.

4 **The Company's Covenants**

The Company covenants with each Owner so as to bind the Company's Undertaking and for the benefit and protection of the Owner's Land:

4.1 when exercising any of the Rights upon the Owner's Land, to comply with the requirements of Section 29 of the Electricity Act 1989;

4.2 to make good to the reasonable satisfaction of the Owner any damage caused to the Owner's Land or to any buildings, structures, trees, crops, deadstock or livestock on it caused by the exercise of any of the Rights or (if and to the extent that such damage cannot be made good) to compensate the Owner for any such damage;

4.3 if required by the Owner, to remove from the Owner's Land all timber, etc, cut by the Company in accordance with the Rights and to leave the corresponding parts of the Owner's Land neat and tidy; and

4.4 subject to the provisions of clause 5, to keep the Owner indemnified against all actions which may be brought against it and all claims and demands which may be made against it by reason of any negligence on the part of the Company in the exercise of the Rights, or any breach by the Company of the Company's obligations to the Owner, in this Declaration.

5 **The Company's Indemnity**

5.1 The indemnity in clause 4.4 is conditional upon the Owner:

5.1.1 giving to the Company written notice of any such actions claims or demands as soon as reasonably possible after the Owner becomes aware of any such actions claims or demands;

5.1.2 not admitting liability to any third party, making any offer to settle, settling or compromising any such actions claims or demands without the Company's consent (such consent not to be unreasonably withheld or delayed);

5.1.3 taking all reasonable steps to mitigate any liabilities relating to such actions claims or demands; and

5.1.4 keeping the Company informed in relation to the progress of any such actions, claims and demands and paying due regard to the Company's reasonable representations in relation thereto.

5.2 The indemnity at Clause 4.4 shall not apply to the extent that the relevant amount resulted from or was increased by the negligence or default of the Owner, or any other Third Party (other than a Third Party authorised by the Company to exercise the Rights) or any of their respective employees agents consultants or contractors.

6 Minor Tenancies

For the purposes of section 2(2) of the Act, the specified period in relation to the land comprised in this Declaration is 1 year and 1 day.

7 Definitions and Interpretation

In this Declaration wherever the context permits:

7.1 the capitalised terms appearing in this Declaration have the respective meanings assigned to them by the First Schedule;

7.2 references to 'the Owner' include the Owner's personal representatives, successors in title or permitted assigns;

7.3 references to 'the Company' include the Company's assignees and the successors in title to the Company's Undertaking;

7.4 where a party is placed under a restriction in this Deed the restriction is to be deemed to include the obligation on that party not to permit or suffer any infringement of the restriction;

7.5 all obligations (including restrictions) given or undertaken by or imposed upon more than one person in the same capacity are given or undertaken by or imposed upon them jointly and severally;

7.6 headings are for ease of reference only and are not to be taken into account in the interpretation of the provisions to which they refer;

7.7 references to clauses and schedules are references to the relevant clause in or schedule to this Declaration;

- 7.8 words denoting the singular include the plural and vice versa;
- 7.9 references to any statutes or statutory instruments include any statute or statutory instrument amending, consolidating or replacing them respectively from time to time in force, and references to a statute include statutory instruments and regulations made pursuant to it;
- 7.10 references to persons includes persons firms and companies;
- 7.11 words importing one gender include both other genders;
- 7.12 in relation to a Plot the description of the Plot in the Second Schedule may not take into account any works that have subsequently been undertaken in, under or over the Plot pursuant to the Order; and
- 7.13 in the event of inconsistency between the extent of a Plot shown on the Plan and the description of that Plot in column 2 of the Second Schedule the Plan shall override the description of that Plot in column 2 of the Second Schedule; and
- 7.14 the Plans drawn at declared scale of 1:1,250 shall be regarded as definitive and any of the Plans which are reproduced at declared scale of 1:250, 1:500 and/or "Enlargement" inserts in the Plans are illustrative only.

8 Registration

The Company hereby requests the Chief Land Registrar:

- 8.1 to note the benefit of any Vested Rights, the Access Restrictions and/or the Overhead Restrictions acquired by the Company by this Declaration in relation to a particular Plot in the property registers of each of the relevant Company Title/s (if any); and
- 8.2 to note the burden of Vested Rights, the Access Restrictions and/or the Overhead Restrictions acquired by the Company by this Declaration in relation to a particular Plot in the charges register of each Owner's Title relating to that Plot.

9 Contracts (Rights of Third Parties) Act

For the avoidance of doubt and save insofar as expressly provided to the contrary in this Declaration, it is not intended that a person other than the Company or an Owner shall have rights under the Contracts (Rights of Third Parties) Act 1999 to enforce any term of this Declaration

EXECUTED as a DEED by the Company on the day and year above-written

THE FIRST SCHEDULE

| Term | Meaning |
|------------------------------|--|
| Access Restrictions | Covenants by the Owner with the Company so as to bind the Owner's Land within the relevant Plot for the benefit and protection of the Company's Undertaking insofar as the same are capable of so benefitting not to do or suffer to be done anything upon the Owner's Land which may in any way interfere with the Company's enjoyment of the Access Rights and to take all reasonable precautions to prevent such interference; |
| Access Rights | <p>The following rights for the Company and all those authorised by the Company from time to time:</p> <ol style="list-style-type: none"> 1. the right of way for the Company and all those authorised by the Company from time to time with or without vehicles plant and equipment at all times across the relevant Plot/s; 2. the rights contained at paragraph 4 of Overhead Rights in so far as they relate to Access Rights; 3. the right of way with or without vehicles, plant and equipment to enter the relevant Plot to access any adjoining land in connection with the purposes authorised by the Order; and 4. the right to enter the relevant Plots to carry out activities ancillary to the exercise of the above rights including the rights to construct, use, retain, inspect, maintain, repair, alter, renew, replace or resurface such access ways; |
| Act | Compulsory Purchase (Vesting Declarations) Act 1981 as amended; |
| Company | National Grid Electricity Transmission PLC, a company incorporated and registered in England and Wales with company registration number 02366977; |
| Company's Titles | <p>means the freehold interests in:</p> <ol style="list-style-type: none"> a) the Bridgwater Tee being a 400kv Teed circuit comprising of two sealing end compounds registered with title numbers ST359605 and ST371248; and b) the Loxton Sealing Compound registered with title numbers ST294124 and ST318828; |
| Company's Undertaking | the Company's undertaking for the transmission of electricity including (without limitation) such land and hereditaments forming part of that undertaking as are accommodated by the Vested Rights including, without limitation the Company's Titles; |
| Conductors | up to 24 conductors (the approximate centre line of which is indicated by a black line on the Plan and subject to their maximum swing) for transmitting electricity at such pressure as the Company may from time to time require for the purposes of its operations together with [an] earth wire[s] and fibre optic cables (in connection with the use of the Company's Undertaking only); |

| Term | Meaning |
|------------------------------|--|
| Conduit | Sewers, drains, watercourse, pipes, cables, wires, ducts, hydrants, cable trays, and other service channels, conduits, apparatus or media for the passage or transmission of Services; |
| Electric Lines | <ol style="list-style-type: none"> 1. the Conductors; 2. the Towers; and 3. any other equipment or apparatus (but excluding fibre optic cables for the use of any third party or commercial operator) required by the Company from time to time in connection with the Towers or the Conductors; |
| Excluded Persons | In relation to the relevant Plots, those persons listed in column 6 of the Second Schedule; |
| Highway | such (if any) of the airspace, surface, structure or subsoil of the relevant Plot as forms part of any highway and which vests in the highway authority, but for the avoidance of doubt shall not include any of the subsoil, airspace, verge or any other land which although horizontally, or vertically adjacent to the highway, does not so vest (and where a highway passes over a bridge or through a tunnel, that bridge or tunnel is to be taken for the purposes of this Declaration to be a part of the highway); |
| Order | The National Grid (Hinkley Point C Connection Project) Order 2016 as amended; |
| Overhead Restrictions | <p>covenants by the Owner with the Company so as to bind the Owner's Land within the relevant Plot for the benefit and protection of the Company's Undertaking insofar as the same is capable of so benefiting:</p> <ol style="list-style-type: none"> 1. not to do or suffer to be done anything upon the Owner's Land which may in any way interfere with, damage or cause injury to any Electric Lines or interfere with or obstruct the Company's access thereto or use thereof; 2. (without limiting clause 1) not to: <ol style="list-style-type: none"> (a) do or suffer to be done anything upon the Owner's Land without taking all reasonable precautions to prevent interference, obstruction, damage or injury to any Electric Lines or the Company's access thereto or use thereof; (b) erect any building or structure (whether temporary or permanent) or plant or allow to grow any plant or tree on the Owner's Land within 5.3 metres of any Conductor when at its maximum temperature and/or maximum swing; (c) erect any building or structure (whether temporary or permanent) or plant or allow any plant or tree within a 15 metres radius in any direction from the centre of any Tower without the written consent of the Company (such consent |

| Term | Meaning |
|------------------------|---|
| | <p>not to be unreasonably withheld or delayed and which consent may be granted subject to reasonable conditions);</p> <p>(d) store or place within a 15 metre radius in any direction from the centre of any of Tower any goods or materials whatsoever without the written consent of the Company (such consent not to be unreasonably withheld or delayed and which consent may be granted subject to reasonable conditions);</p> <p>(e) raise the level of the surface of the Owner's Land so as to make the distance between the level of the ground and the lowest Conductor at any point of its span less than 7.6 metres;</p> <p>(f) carry out any works or excavations whether on the Owner's Land or otherwise which may endanger the stability, safety and integrity of any of the Electric Lines; and</p> <p>3. in so far as the Owner's Land, or any part thereof, is not registered at the Land Registry, not to raise any objection to the Company applying to register such restrictions as D(ii) land charges and/or applying for caution/s against first registration in respect of the Owner's Land;</p> |
| Overhead Rights | <p>the following rights for the Company and all those authorised by the Company from time to time for the benefit of the Company's Undertaking:</p> <ol style="list-style-type: none"> 1. the right with or without vehicles plant and equipment to enter the relevant Plot to erect the Electric Lines and thereafter retain, inspect, maintain, repair, alter, renew, replace and remove the Electric Lines; 2. the Access Rights; 3. the right to use such Electric Lines; 4. the right with or without vehicles plant and equipment at the Company's expense and in a: <ol style="list-style-type: none"> (a) proper and woodmanlike manner to fell, trim or lop all trees and bushes on the Owner's Land which obstruct or interfere with the exercise of the Overhead Rights or the Access Rights; and (b) proper and workmanlike matter to the extent necessary to rectify any breach of the Overhead Restrictions or the Access Restrictions to remove any buildings, structures, pylons and vegetation from the relevant part of the Owner's Land; 5. the right to carry out any activities on the Owner's Land ancillary or incidental to the exercise of the above rights; |

| Term | Meaning |
|------------------------|--|
| Owner | an owner and/or lessee of an interest in one or more Plots other than an Excluded Person; |
| Owner's Land | such of the Plot/s as are vested in the relevant Owner on the date of this Declaration; |
| Owner's Title | A registered title of which an Owner is the registered proprietor and which is listed in column 5 of the Second Schedule in relation to a Plot; |
| Plan | The set of seventeen plans attached hereto titled 'STAGE 7 - GVD B1 CoR OVERVIEW' with reference numbers HINK-GVDS7-COR-OV-1 through to HINK-GVDS7-COR-OV-17 (inclusive), |
| Plot | a plot of land described in column 2 of the Second Schedule and marked by the relevant Plot Number and shown coloured blue and edged blue or edged blue and dark green and coloured green and edged dark green or dark green and blue on the Plan; |
| Plot Number | the number for the relevant Plot appearing in column 1 of the Second Schedule; |
| Rights | <p>in relation to each Plot such of the following rights for the Company and all those authorised by the Company from time to time for the benefit of the Company's Undertaking:</p> <ol style="list-style-type: none"> 1. Access Rights; and 2. Overhead Rights; <p>as are specified in column 3 of the Second Schedule in relation to that Plot;</p> |
| Services | Water, gas, electricity, telecommunications, data transfer, surface water drainage, foul drainage and/or other services as the context permits; |
| Towers | towers to support Conductors either erected or to be erected in the position approximately indicated by a black circle on the Plan and such ancillary equipment and apparatus as required by the Company from time to time; |
| Utility Company | <ol style="list-style-type: none"> 1. a 'public communication provider' as the term is defined in section 151(1) of the Communications Act 2003; 2. a 'public utility undertaker' as the term is defined in the Highways Act 1980; or 3. a 'statutory undertaker' as the term is defined in paragraph 2 of Part 1 of Schedule 15 to the Order |

| Term | Meaning |
|------------------------|---|
| Utility Conduit | Such (if any) of the Plot as is occupied at the date of this Declaration by a Conduit housing Service/s belonging to one or more Utility Company (other than the Company) together with the contents of such Conduit; |
| Vested Rights | All Rights, Overhead Restrictions and Access Restrictions the benefit of which or the right to enforce is vested in the Company by virtue of this Declaration. |

THE SECOND SCHEDULE

| 1 Plot Number | 2 Plot Description | 3 Rights Acquired | 4 Restrictions Imposed | 5 Owner's Title | 6 Excluded Person/s |
|------------------|--|----------------------|---------------------------|--------------------|------------------------|
| 1 | Approximately 2023.7 sqm of agricultural land to the west of Homestead Farm. | Overhead Rights | Overhead Restrictions | ST36689 | |
| 2 | Approximately 115.89 sqm of land forming part of drainage ditch and unregistered watercourse west of Causeway (B3141). | Overhead Rights | Overhead Restrictions | Unregistered | |
| 3 | Approximately 994.9 sqm of agricultural land to the west of Causeway, Woolavington. | Access Rights | Access Restrictions | ST90979 | |
| 4 | Approximately 7384.7 sqm of agricultural land to the west of Causeway, Woolavington. | Overhead Rights | Overhead Restrictions | ST90979 | |
| 5 | Approximately 196.49 sqm of land forming part of drainage ditch and unregistered watercourse west of Causeway (B3141). | Overhead Rights | Overhead Restrictions | Unregistered | |

| 1 | 2 | 3 | 4 | 5 | 6 |
|-------------|---|-----------------|-----------------------|---------------|-------------------|
| Plot Number | Plot Description | Rights Acquired | Restrictions Imposed | Owner's Title | Excluded Person/s |
| 6 | Approximately 3554.87 sqm of agricultural land to the west of Causeway, Woolavington. | Overhead Rights | Overhead Restrictions | ST209108 | |
| 7 | Approximately 7.46 sqm of agricultural land to the west of Causeway, Woolavington. | Access Rights | Access Restrictions | Unregistered | |
| 8 | Approximately 63.53 sqm of land forming part of drainage ditch and unregistered watercourse west of Causeway (B3141). | Overhead Rights | Overhead Restrictions | Unregistered | |
| 9 | Approximately 835.62 sqm of track south of Huntspill River and adjacent drainage ditches. | Overhead Rights | Overhead Restrictions | Unregistered | |
| 10 | Approximately 127.13 sqm of track south of Huntspill River and adjacent drainage ditches. | Access Rights | Access Restrictions | Unregistered | |
| 11 | Approximately 840.41 sqm of track south of Huntspill River. | Access Rights | Access Restrictions | Unregistered | |
| 12 | Approximately 20.17 sqm of land forming part of the highway and verge known as | Access Rights | Access Restrictions | Unregistered | |

| 1 | 2 | 3 | 4 | 5 | 6 |
|-------------|--|-----------------|-----------------------|---------------|-------------------|
| Plot Number | Plot Description | Rights Acquired | Restrictions Imposed | Owner's Title | Excluded Person/s |
| | Causeway south of Huntspill River. | | | | |
| 13 | Approximately 110.87 sqm of land forming part of drainage ditch and unregistered watercourse south of Burtle Road. | Overhead Rights | Overhead Restrictions | Unregistered | |
| 14 | Plot not being used | | | | |
| 15 | Approximately 47.82 sqm of land forming part of drainage ditch and unregistered watercourse north of Burtle Road. | Overhead Rights | Overhead Restrictions | ST320965 | |
| 16 | Approximately 237.53 sqm of agricultural land and buildings known as Cote Farm, north of Burtle Road | Access Rights | Access Restrictions | Unregistered | |
| 17 | Approximately 192.38 sqm of agricultural land to the north of Burtle Road. | Access Rights | Access Restrictions | Unregistered | |
| 18 | Approximately 112.5 sqm of agricultural land north of Burtle Road. | Access Rights | Access Restrictions | Unregistered | |

| 1 Plot Number | 2 Plot Description | 3 Rights Acquired | 4 Restrictions Imposed | 5 Owner's Title | 6 Excluded Person/s |
|------------------|--|----------------------|---------------------------|--------------------|------------------------|
| 19 | Approximately 22.17 sqm of land forming part of drainage ditch and unregistered watercourse south of Merry Farm, Merry Lane. | Overhead Rights | Overhead Restrictions | Unregistered | |
| 20 | Approximately 81.41 sqm of land forming part of drainage ditch and unregistered watercourse south of Merry Farm, Merry Lane. | Overhead Rights | Overhead Restrictions | Unregistered | |
| 21 | Approximately 76.52 sqm of land forming part of drainage ditch and unregistered watercourse south of Merry Farm, Merry Lane. | Overhead Rights | Overhead Restrictions | Unregistered | |
| 22 | Approximately 104.08 sqm of land being part of a drainage ditch and boundary hedge to the east of Merry Farm, Merry Lane and land forming part of the highway known as Merry Lane. | Overhead Rights | Overhead Restrictions | ST317792 | |
| 23 | Approximately 1.5 sqm land forming part of the highway | Overhead Rights | Overhead Restrictions | ST317792 | |

| 1 Plot Number | 2 Plot Description | 3 Rights Acquired | 4 Restrictions Imposed | 5 Owner's Title | 6 Excluded Person/s |
|------------------|---|----------------------|---------------------------|--------------------|------------------------|
| | and verge known as Merry Lane. | | | | |
| 24 | Plot not being used | | | | |
| 25 | Plot not being used | | | | |
| 26 | Approximately 21.42 sqm of land forming part of a section of riverbank north of the River Brue. | Overhead Rights | Overhead Restrictions | ST246368 | |
| 27 | Approximately 5.04 sqm of land forming part of drainage ditch north of River Brue. | Overhead Rights | Overhead Restrictions | ST318715 | |
| 28 | Approximately 150.98 sqm of land forming part of drainage ditch north of River Brue. | Access Rights | Access Restrictions | ST318715 | |
| 29 | Approximately 1967.59 sqm of track north of River Brue. | Access Rights | Access Restrictions | ST298145 | |
| 30 | Approximately 2067.46 sqm of track north of River Brue. | Access Rights | Access Restrictions | ST299459 | |
| 31 | Approximately 1225.75sqm of track north of River Brue. | Access Rights | Access Restrictions | ST299463 | |

| 1 | 2 | 3 | 4 | 5 | 6 |
|-------------|---|-----------------|----------------------|---------------|-------------------|
| Plot Number | Plot Description | Rights Acquired | Restrictions Imposed | Owner's Title | Excluded Person/s |
| 32 | Approximately 2187.97 sqm of agricultural land to the north of River Brue. | Access Rights | Access Restrictions | ST298129 | |
| 33 | Approximately 1867.6 sqm of track north of River Brue | Access Rights | Access Restrictions | ST299463 | |
| 34 | Approximately 480.5 sqm of track at head of Factory Lane. | Access Rights | Access Restrictions | ST299459 | |
| 35 | Approximately 4.3 sqm of land forming part of drainage ditch north of River Brue. | Access Rights | Access Restrictions | Unregistered | |
| 36 | Approximately 2328.23 sqm of agricultural land to the north of the River Brue. | Access Rights | Access Restrictions | ST352615 | |
| 37 | Approximately 14.92 sqm of land forming part of drainage ditch north of River Brue. | Access Rights | Access Restrictions | Unregistered | |
| 38 | Approximately 1530.58 sqm of agricultural land, hardstanding, track and an agricultural building to the west of Reed Drove and south of Southwick Road. | Access Rights | Access Restrictions | ST96322 | |

| 1 Plot Number | 2 Plot Description | 3 Rights Acquired | 4 Restrictions Imposed | 5 Owner's Title | 6 Excluded Person/s |
|------------------|---|----------------------|---------------------------|--------------------|------------------------|
| 39 | Approximately 353.52 sqm of agricultural land at Southwick Farm including verge and subsoil beneath Southwick Road. | Access Rights | Access Restrictions | ST273180 | |
| 40 | Approximately 14,134.11 sqm of agricultural land at Southwick Farm north of Southwick Road. | Overhead Rights | Overhead Restrictions | ST273180 | |
| 41 | Approximately 99.41 sqm of land forming part of drainage ditch north of Southwick Road. | Overhead Rights | Overhead Restrictions | Unregistered | |
| 42 | Plot not being used | | | | |
| 43 | Approximately 9.09 sqm of land forming part of drainage ditch north of Northwick Road. | Overhead Rights | Overhead Restrictions | Unregistered | |
| 44 | Plot not being used | | | | |
| 45 | Approximately 499.25 sqm of agricultural land and access at Vole House including drainage ditch west of Vole Road. | Access Rights | Access Restrictions | ST126998 | |
| 46 | Approximately 21,007.62 sqm of agricultural land forming part | Overhead Rights | Overhead Restrictions | ST124731 | |

| 1 | 2 | 3 | 4 | 5 | 6 |
|-------------|---|-----------------|-----------------------|---------------|-------------------|
| Plot Number | Plot Description | Rights Acquired | Restrictions Imposed | Owner's Title | Excluded Person/s |
| 47 | of Manor Farm on the north east side of Oldmead Lane Approximately 14.6 sqm of agricultural land and access forming part of Manor Farm on the north east side of Oldmead Lane. | Access Rights | Access Restrictions | Unregistered | |
| 48 | Approximately 1766.07 sqm of agricultural land and access forming part of Manor Farm on the north east side of Oldmead Lane. | Access Rights | Access Restrictions | ST124731 | |
| 49 | Approximately 76.1 sqm of land forming part of drainage ditch north east of Oldmead Lane. | Overhead Rights | Overhead Restrictions | Unregistered | |
| 50 | Approximately 58.06 sqm of land forming part of drainage ditch north east of Oldmead Lane. | Overhead Rights | Overhead Restrictions | Unregistered | |
| 51 | Approximately 38.03 sqm of land forming part of drainage ditch south of A38. | Overhead Rights | Overhead Restrictions | Unregistered | |

| 1 Plot Number | 2 Plot Description | 3 Rights Acquired | 4 Restrictions Imposed | 5 Owner's Title | 6 Excluded Person/s |
|------------------|--|----------------------|---------------------------|--|------------------------|
| 52 | Approximately 871.86sqm of industrial car showroom and workshop on the south side of Bristol Road, A38 | Overhead Rights | Overhead Restrictions | ST182356 (Subject to pending Application for a dispositional first lease with pending title number ST377082 to be included in this Schedule) | |
| 53 | Approximately 85.2 sqm of land forming part of drainage ditch south of A38. | Overhead Rights | Overhead Restrictions | Unregistered | |
| 54 | Approximately 188.6 sqm of property including verge and subsoil beneath highway known as Bristol Road, A38. | Overhead Rights | Overhead Restrictions | Unregistered | |
| 55 | Approximately 5582.9 sqm of agricultural land and buildings forming part of Tarnock Farm including verge and subsoil beneath the highway known as Bristol Road, A38. | Overhead Rights | Overhead Restrictions | ST378117 | |
| 56 | Plot not used | | | | |
| 57 | Approximately 51.5 sqm of land forming part of drainage ditch north of A38. | Overhead Rights | Overhead Restrictions | ST378117 | |

| 1 Plot Number | 2 Plot Description | 3 Rights Acquired | 4 Restrictions Imposed | 5 Owner's Title | 6 Excluded Person/s |
|------------------|--|----------------------|---------------------------|--------------------|---|
| 58 | Approximately 7.4 sqm of land forming part of drainage ditch west of Fletchers Lane. | Overhead Rights | Overhead Restrictions | Unregistered | Linda Hodges and Michael Anthony Hodges as Executors of Florence Vera Edwards |
| 59 | Approximately 0.4 sqm of agricultural land west of Fletchers Lane and of land forming part of drainage ditch west of Fletchers Lane. | Overhead Rights | Overhead Restrictions | ST93332 | Linda Hodges and Michael Anthony Hodges as Executors of Florence Vera Edwards |
| 60 | Approximately 30.9 of land forming part of drainage ditch and unregistered watercourse west of Biddisham Lane | Overhead Rights | Overhead Restrictions | Unregistered | Ian Edward Marshall |
| 61 | Approximately 6.2sqm of land forming part of drainage ditch and unregistered watercourse west of Biddisham Lane. | Overhead Rights | Overhead Restrictions | Unregistered | Ian Edward Marshall |



MEMBER OF THE BOARD SEALING COMMITTEE
NGET 11620

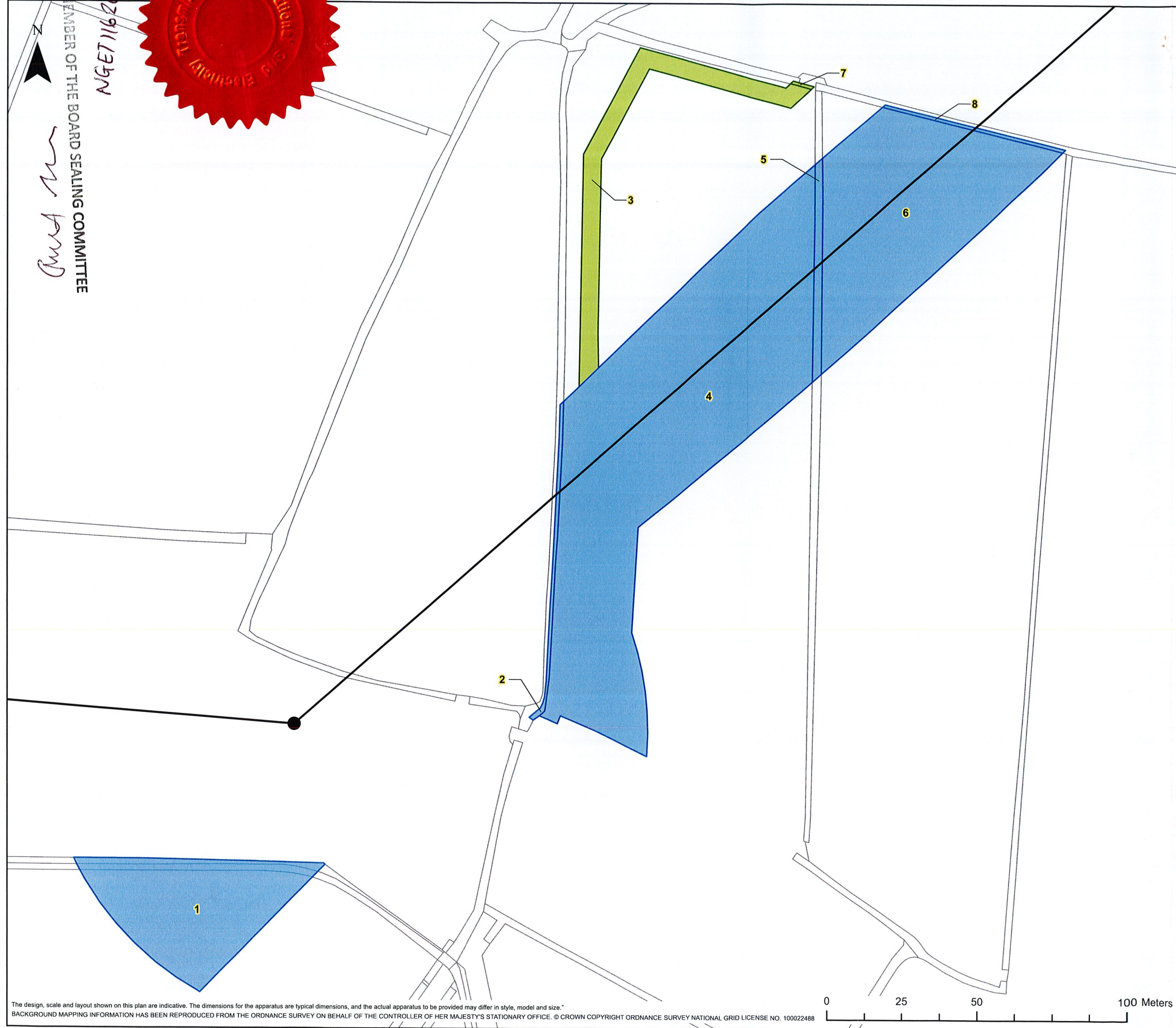

nationalgrid

HINKLEY C CONNECTION PROJECT

Title
STAGE 7 - GVD B1 CoR OVERVIEW

Ref No: HINK-GVDS7-COR-OV-1 Plan: 1 of 17

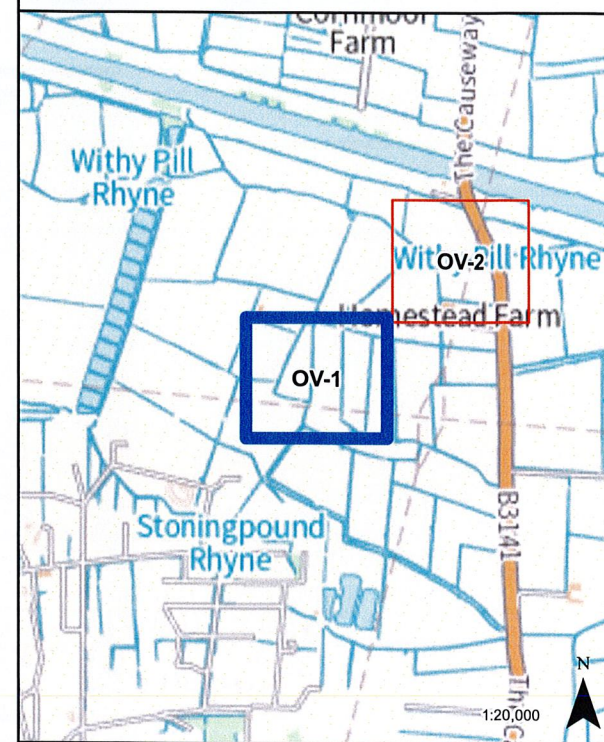

LEGEND

- GVD Plan Outlines
- Overhead Rights and Restrictions
- Access Rights and Restrictions
- Overhead Line
- Pylons

| | | | | |
|---|------------|--------------------------------|--------|----------|
| Coordinate System: British National Grid Projection: Transverse Mercator Datum: OSGB 1938 Units: Metre | | Map Centre: 334112E 143099N | | |
| Version: | Date: | Remarks: | Drawn: | Checked: |
| v2 | 10/08/2023 | Published | JK | SM |
| SCALE: 1:1,250 | | PAPER SIZE: A3 | | |

Notes:
This drawing is scaled at paper size A3, therefore any prints taken at different sizes will affect the accuracy of the measurement units and should not be scaled against.

The design, scale and layout shown on this plan are indicative. The dimensions for the apparatus are typical dimensions, and the actual apparatus to be provided may differ in style, model and size.
BACKGROUND MAPPING INFORMATION HAS BEEN REPRODUCED FROM THE ORDNANCE SURVEY ON BEHALF OF THE CONTROLLER OF HER MAJESTY'S STATIONARY OFFICE. © CROWN COPYRIGHT ORDNANCE SURVEY NATIONAL GRID LICENSE NO. 100022488

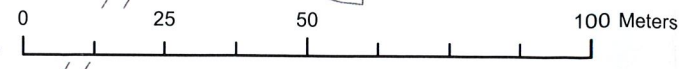

NG ET 11620



MEMBER OF THE BOARD SEALING COMMITTEE

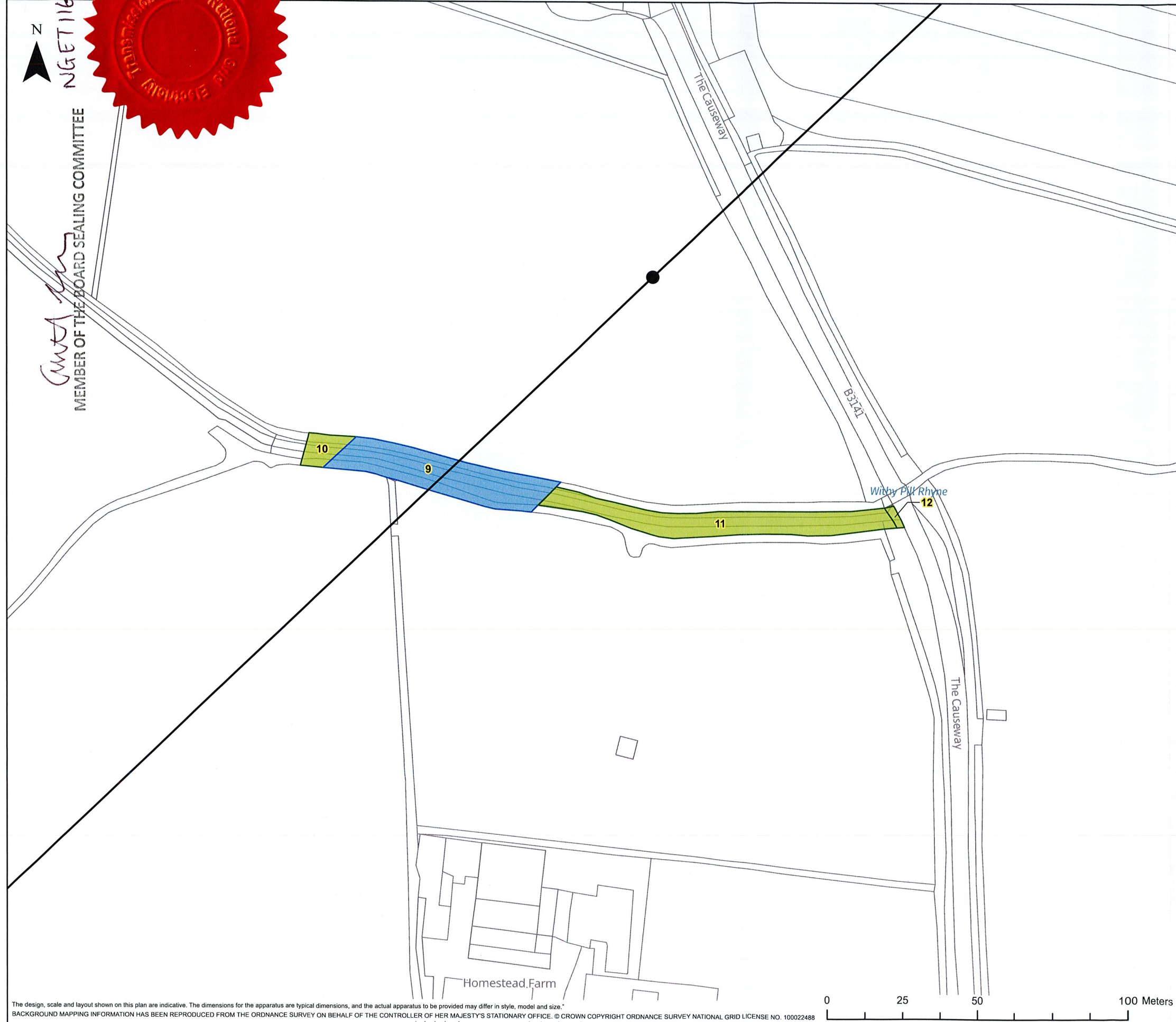

nationalgrid

HINKLEY C CONNECTION PROJECT

Title
STAGE 7 - GVD B1 CoR OVERVIEW

Ref No: HINK-GVDS7-COR-OV-2 Plan: 2 of 17

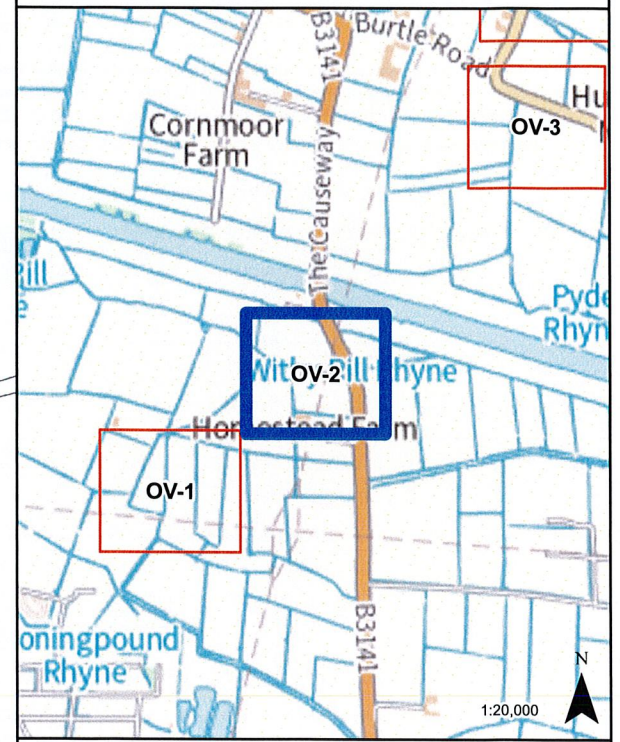

LEGEND

- GVD Plan Outlines
- Overhead Rights and Restrictions
- Access Rights and Restrictions
- Overhead Line
- Pylons

Coordinate System: British National Grid
 Projection: Transverse Mercator
 Datum: OSGB 1938
 Units: Metre

Map Centre:
 334518E 143429N

| Version: | Date: | Remarks: | Drawn: | Checked: |
|----------|------------|-----------|--------|----------|
| v2 | 10/08/2023 | Published | JK | SM |

SCALE: 1:1,250 PAPER SIZE: A3

Notes:
 This drawing is scaled at paper size A3, therefore any prints taken at different sizes will affect the accuracy of the measurement units and should not be scaled against.



The design, scale and layout shown on this plan are indicative. The dimensions for the apparatus are typical dimensions, and the actual apparatus to be provided may differ in style, model and size.
 BACKGROUND MAPPING INFORMATION HAS BEEN REPRODUCED FROM THE ORDNANCE SURVEY ON BEHALF OF THE CONTROLLER OF HER MAJESTY'S STATIONARY OFFICE. © CROWN COPYRIGHT ORDNANCE SURVEY NATIONAL GRID LICENSE NO. 100022488

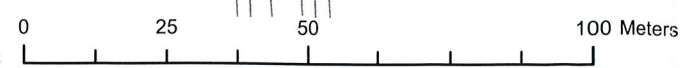

NGE11620

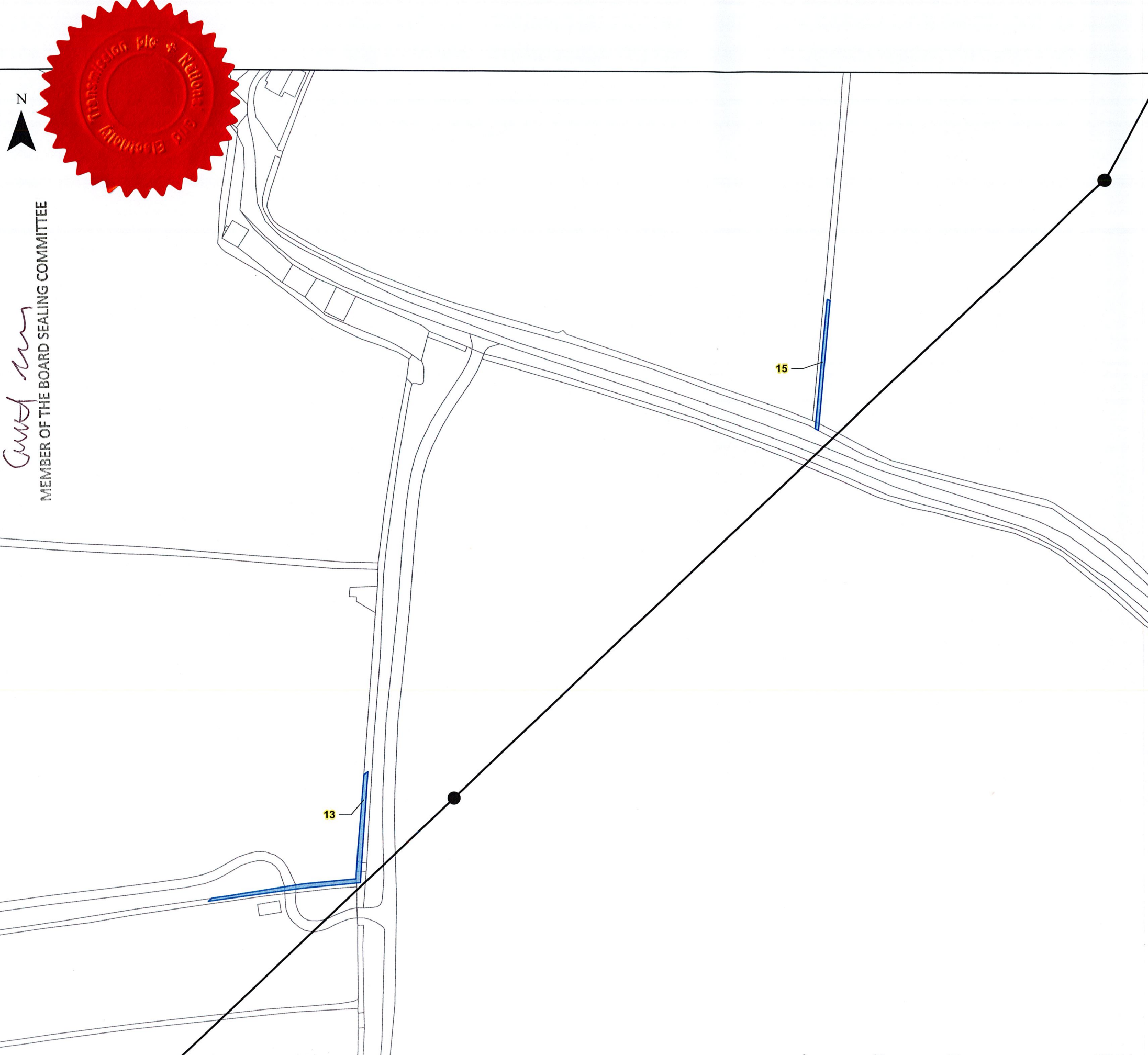

nationalgrid

HINKLEY C CONNECTION PROJECT

Title
STAGE 7 - GVD B1 CoR OVERVIEW

| | |
|--------------------------------|------------------|
| Ref No: HINK-GVDS7-COR-OV-3 | Plan: 3 of 17 |
|--------------------------------|------------------|

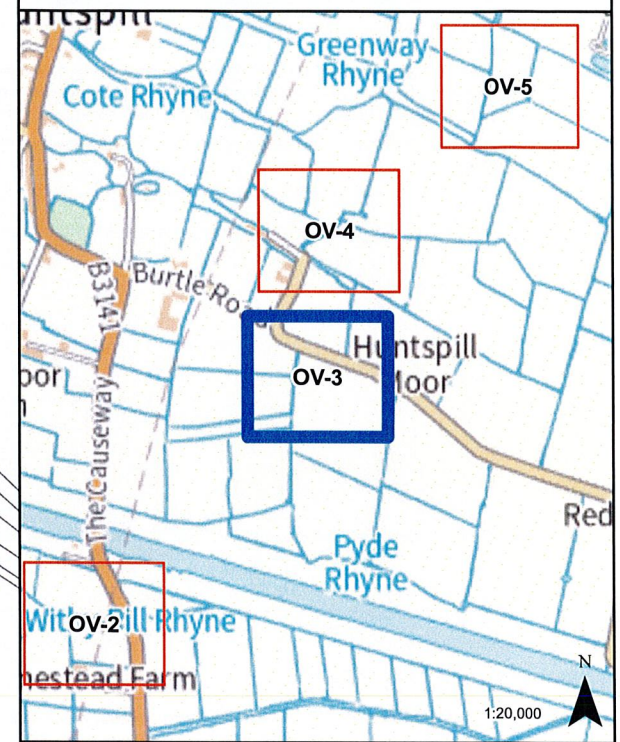

LEGEND

- GVD Plan Outlines
- Overhead Rights and Restrictions
- Access Rights and Restrictions
- Overhead Line
- Pylons

| | |
|---|--------------------------------|
| Coordinate System: British National Grid Projection: Transverse Mercator Datum: OSGB 1938 Units: Metre | Map Centre: 335149E 144123N |
|---|--------------------------------|

| Version: | Date: | Remarks: | Drawn: | Checked: |
|----------|------------|-----------|--------|----------|
| v2 | 10/08/2023 | Published | JK | SM |

| | |
|----------------|----------------|
| SCALE: 1:1,250 | PAPER SIZE: A3 |
|----------------|----------------|

Notes:
This drawing is scaled at paper size A3, therefore any prints taken at different sizes will affect the accuracy of the measurement units and should not be scaled against.



The design, scale and layout shown on this plan are indicative. The dimensions for the apparatus are typical dimensions, and the actual apparatus to be provided may differ in style, model and size.
BACKGROUND MAPPING INFORMATION HAS BEEN REPRODUCED FROM THE ORDNANCE SURVEY ON BEHALF OF THE CONTROLLER OF HER MAJESTY'S STATIONARY OFFICE. © CROWN COPYRIGHT ORDNANCE SURVEY NATIONAL GRID LICENSE NO. 100022488



MEMBER OF THE BOARD SEALING COMMITTEE
NGE T11020



nationalgrid

HINKLEY C CONNECTION PROJECT

Title
STAGE 7 - GVD B1 CoR OVERVIEW

Ref No: HINK-GVDS7-COR-OV-4 Plan: 4 of 17

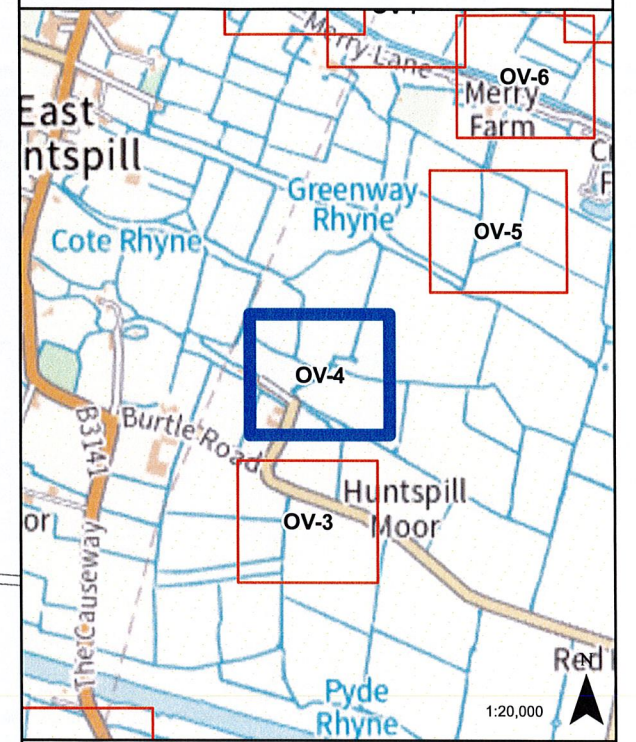

LEGEND

- GVD Plan Outlines
- Overhead Rights and Restrictions
- Access Rights and Restrictions
- Overhead Line
- Pylons

| | | | | |
|---|------------|--------------------------------|--------|----------|
| Coordinate System: British National Grid Projection: Transverse Mercator Datum: OSGB 1938 Units: Metre | | Map Centre: 335183E 144535N | | |
| Version: | Date: | Remarks: | Drawn: | Checked: |
| v2 | 10/08/2023 | Published | JK | SM |
| SCALE: 1:1,250 | | PAPER SIZE: A3 | | |

Notes:
This drawing is scaled at paper size A3, therefore any prints taken at different sizes will affect the accuracy of the measurement units and should not be scaled against.

The design, scale and layout shown on this plan are indicative. The dimensions for the apparatus are typical dimensions, and the actual apparatus to be provided may differ in style, model and size.
BACKGROUND MAPPING INFORMATION HAS BEEN REPRODUCED FROM THE ORDNANCE SURVEY ON BEHALF OF THE CONTROLLER OF HER MAJESTY'S STATIONARY OFFICE. © CROWN COPYRIGHT ORDNANCE SURVEY NATIONAL GRID LICENSE NO. 100022488





MEMBER OF THE BOARD SEALING COMMITTEE
NGE/116/20

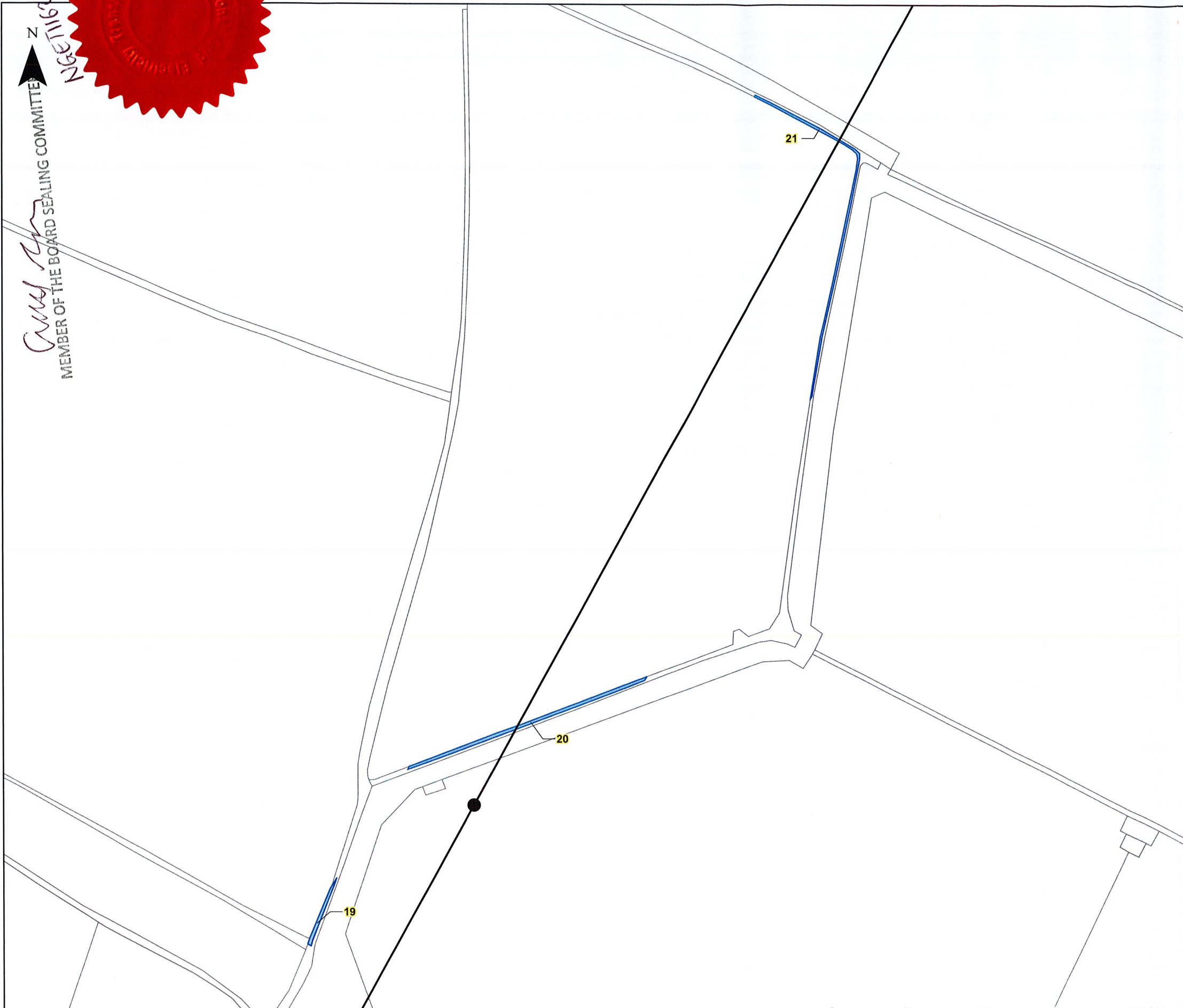

nationalgrid

HINKLEY C CONNECTION PROJECT

Title
STAGE 7 - GVD B1 CoR OVERVIEW

Ref No: HINK-GVDS7-COR-OV-5 Plan: 5 of 17

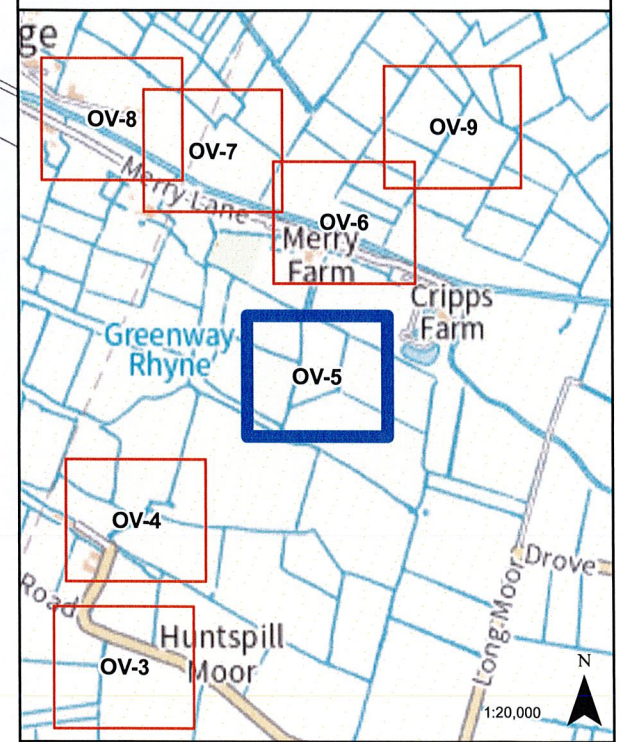

LEGEND

- GVD Plan Outlines
- Overhead Rights and Restrictions
- Access Rights and Restrictions
- Overhead Line
- Pylons

Coordinate System: British National Grid
Projection: Transverse Mercator
Datum: OSGB 1938
Units: Metre
Map Centre:
335693E 144939N

| Version: | Date: | Remarks: | Drawn: | Checked: |
|----------|------------|-----------|--------|----------|
| v2 | 10/08/2023 | Published | JK | SM |

SCALE: 1:1,250 PAPER SIZE: A3

Notes:
This drawing is scaled at paper size A3, therefore any prints taken at different sizes will affect the accuracy of the measurement units and should not be scaled against.



The design, scale and layout shown on this plan are indicative. The dimensions for the apparatus are typical dimensions, and the actual apparatus to be provided may differ in style, model and size.
BACKGROUND MAPPING INFORMATION HAS BEEN REPRODUCED FROM THE ORDNANCE SURVEY ON BEHALF OF THE CONTROLLER OF HER MAJESTY'S STATIONARY OFFICE. © CROWN COPYRIGHT ORDNANCE SURVEY NATIONAL GRID LICENSE NO. 100022488



MEMBER OF THE BOARD SEALING COMMITTEE
NIGEN 160
HINK-GVDS7-COR-01

nationalgrid

HINKLEY C CONNECTION PROJECT

Title
STAGE 7 - GVD B1 CoR OVERVIEW

Ref No: HINK-GVDS7-COR-OV-6 Plan: 6 of 17

HINK-GVDS7-COR-OV-9

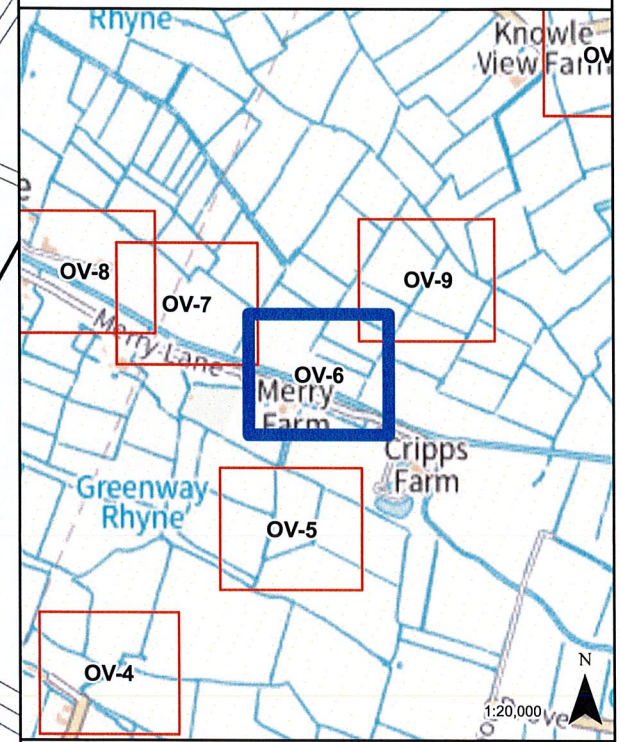

LEGEND

- GVD Plan Outlines
- Overhead Rights and Restrictions
- Access Rights and Restrictions
- Overhead Line
- Pylons

| | | | | |
|---|--------------------------------|--------------------|-----------|-------------|
| Coordinate System: British National Grid Projection: Transverse Mercator Datum: OSGB 1938 Units: Metre | Map Centre: 335770E 145373N | | | |
| Version: v2 | Date: 10/08/2023 | Remarks: Published | Drawn: JK | Checked: SM |

| | |
|--|----------------|
| SCALE: 1:1,250 | PAPER SIZE: A3 |
| Notes: This drawing is scaled at paper size A3, therefore any prints taken at different sizes will affect the accuracy of the measurement units and should not be scaled against. | |
| BK Bruton Knowles | |

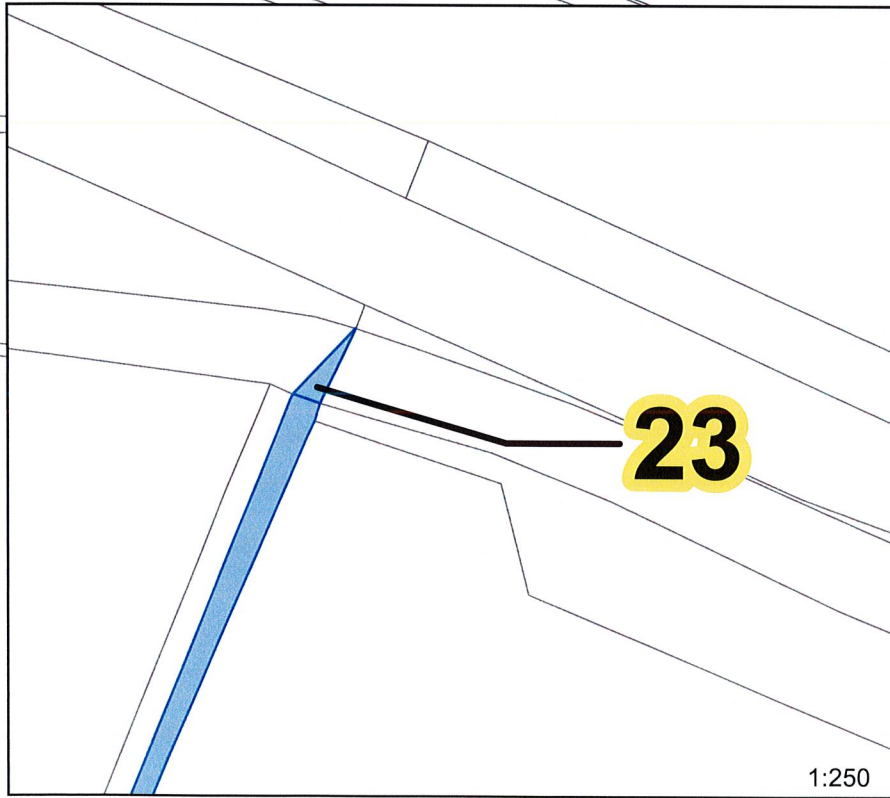
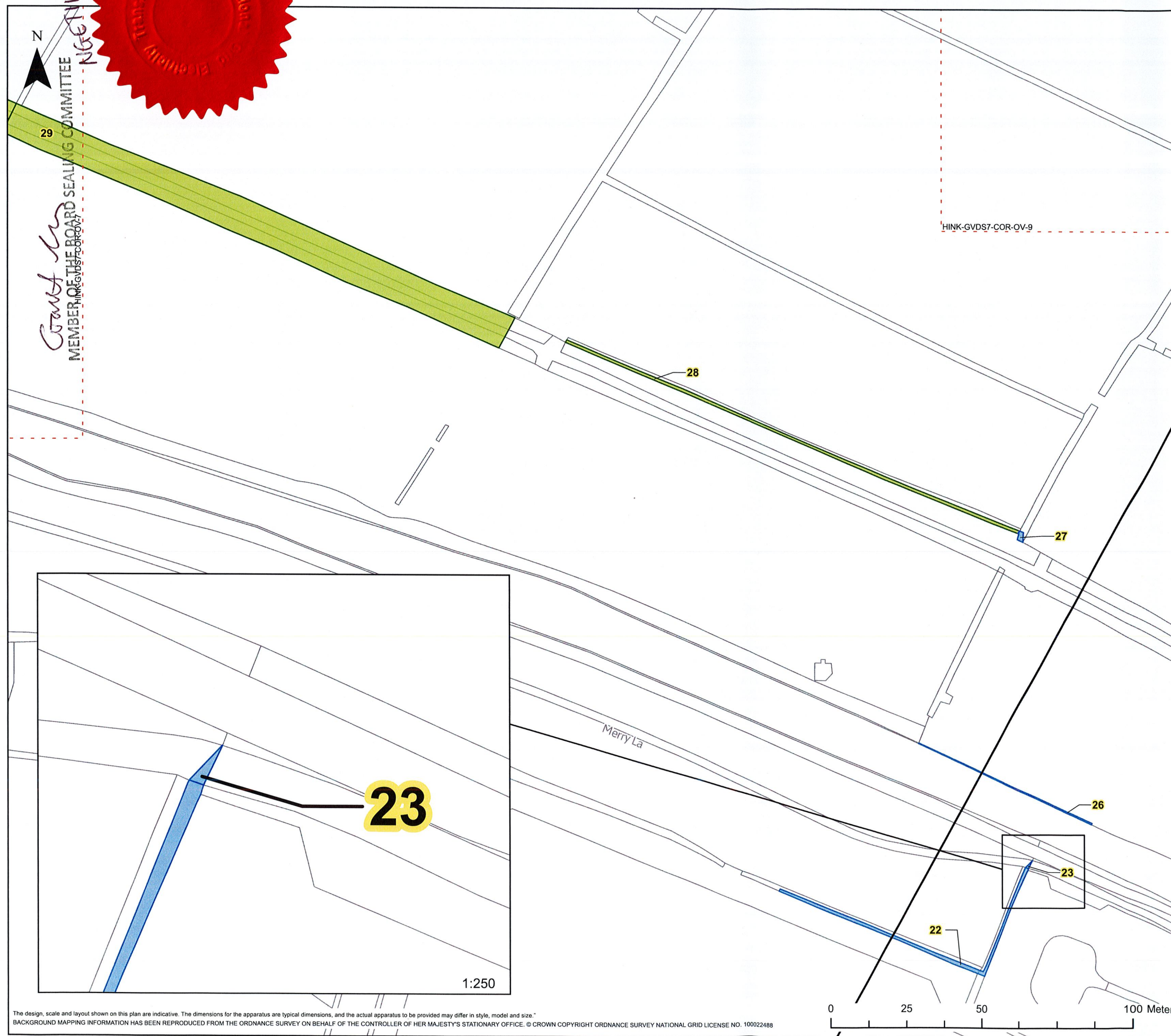

The design, scale and layout shown on this plan are indicative. The dimensions for the apparatus are typical dimensions, and the actual apparatus to be provided may differ in style, model and size.
BACKGROUND MAPPING INFORMATION HAS BEEN REPRODUCED FROM THE ORDNANCE SURVEY ON BEHALF OF THE CONTROLLER OF HER MAJESTY'S STATIONARY OFFICE. © CROWN COPYRIGHT ORDNANCE SURVEY NATIONAL GRID LICENSE NO. 100022488



Crane
MEMBER OF THE BOARD SEALING COMMITTEE
NGE T11620



nationalgrid

HINKLEY C CONNECTION PROJECT

Title
STAGE 7 - GVD B1 CoR OVERVIEW

Ref No: HINK-GVDS7-COR-OV-7 Plan: 7 of 17

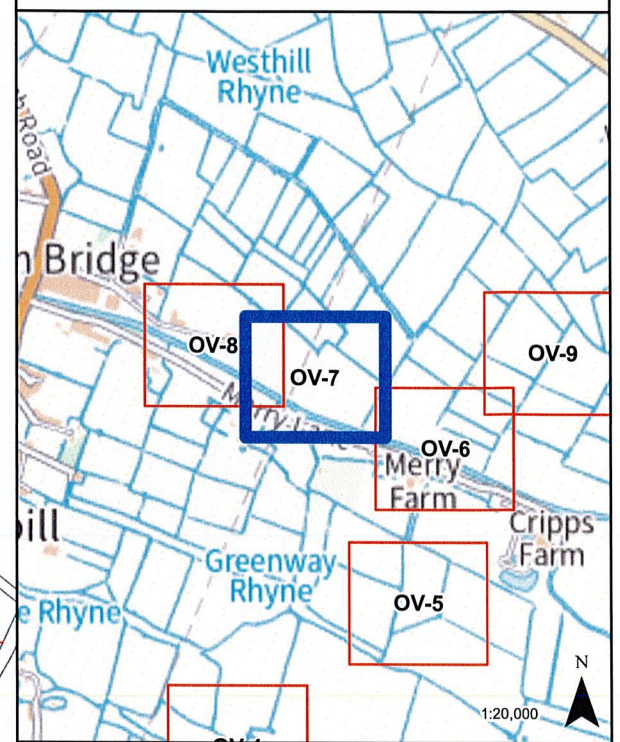

LEGEND

- GVD Plan Outlines
- Overhead Rights and Restrictions
- Access Rights and Restrictions
- Overhead Line
- Pylons

| | |
|---|--------------------------------|
| Coordinate System: British National Grid Projection: Transverse Mercator Datum: OSGB 1938 Units: Metre | Map Centre: 335403E 145571N |
|---|--------------------------------|

| Version: | Date: | Remarks: | Drawn: | Checked: |
|----------|------------|-----------|--------|----------|
| v2 | 10/08/2023 | Published | JK | SM |

| | |
|----------------|----------------|
| SCALE: 1:1,250 | PAPER SIZE: A3 |
|----------------|----------------|

Notes:
This drawing is scaled at paper size A3, therefore any prints taken at different sizes will affect the accuracy of the measurement units and should not be scaled against.



The design, scale and layout shown on this plan are indicative. The dimensions for the apparatus are typical dimensions, and the actual apparatus to be provided may differ in style, model and size.
BACKGROUND MAPPING INFORMATION HAS BEEN REPRODUCED FROM THE ORDNANCE SURVEY ON BEHALF OF THE CONTROLLER OF HER MAJESTY'S STATIONARY OFFICE. © CROWN COPYRIGHT ORDNANCE SURVEY NATIONAL GRID LICENSE NO. 100022488

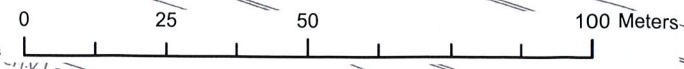

16/08/2023



MEMBER OF THE PUBLIC COMMITTEE
MEMBER OF THE PUBLIC CONSULTATION COMMITTEE

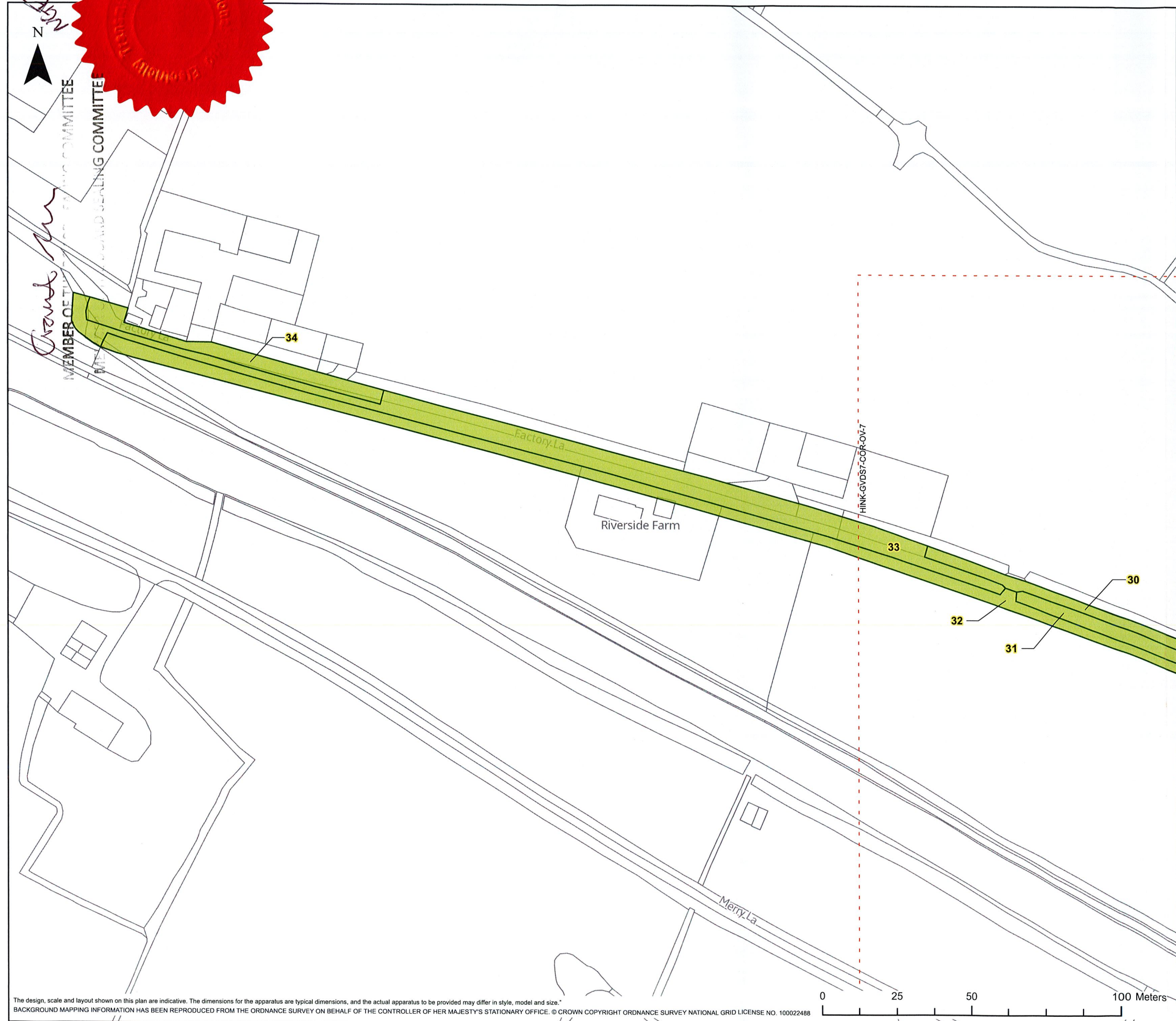

nationalgrid

HINKLEY C CONNECTION PROJECT

Title
STAGE 7 - GVD B1 CoR OVERVIEW

Ref No: HINK-GVDS7-COR-OV-8 Plan: 8 of 17

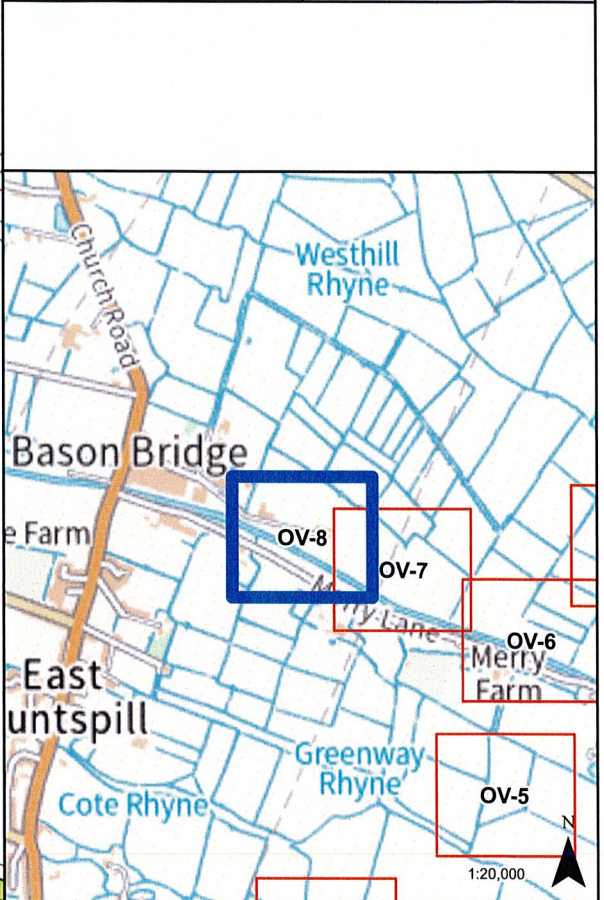

LEGEND

- GVD Plan Outlines
- Overhead Rights and Restrictions
- Access Rights and Restrictions
- Overhead Line
- Pylons

Coordinate System: British National Grid
 Projection: Transverse Mercator
 Datum: OSGB 1938
 Units: Metre

Map Centre:
 335118E 145661N

| Version: | Date: | Remarks: | Drawn: | Checked: |
|----------|------------|-----------|--------|----------|
| v2 | 10/08/2023 | Published | JK | SM |

SCALE: 1:1,250 PAPER SIZE: A3

Notes:
 This drawing is scaled at paper size A3, therefore any prints taken at different sizes will affect the accuracy of the measurement units and should not be scaled against.



The design, scale and layout shown on this plan are indicative. The dimensions for the apparatus are typical dimensions, and the actual apparatus to be provided may differ in style, model and size.
 BACKGROUND MAPPING INFORMATION HAS BEEN REPRODUCED FROM THE ORDNANCE SURVEY ON BEHALF OF THE CONTROLLER OF HER MAJESTY'S STATIONARY OFFICE. © CROWN COPYRIGHT ORDNANCE SURVEY NATIONAL GRID LICENSE NO. 100022488



029111629

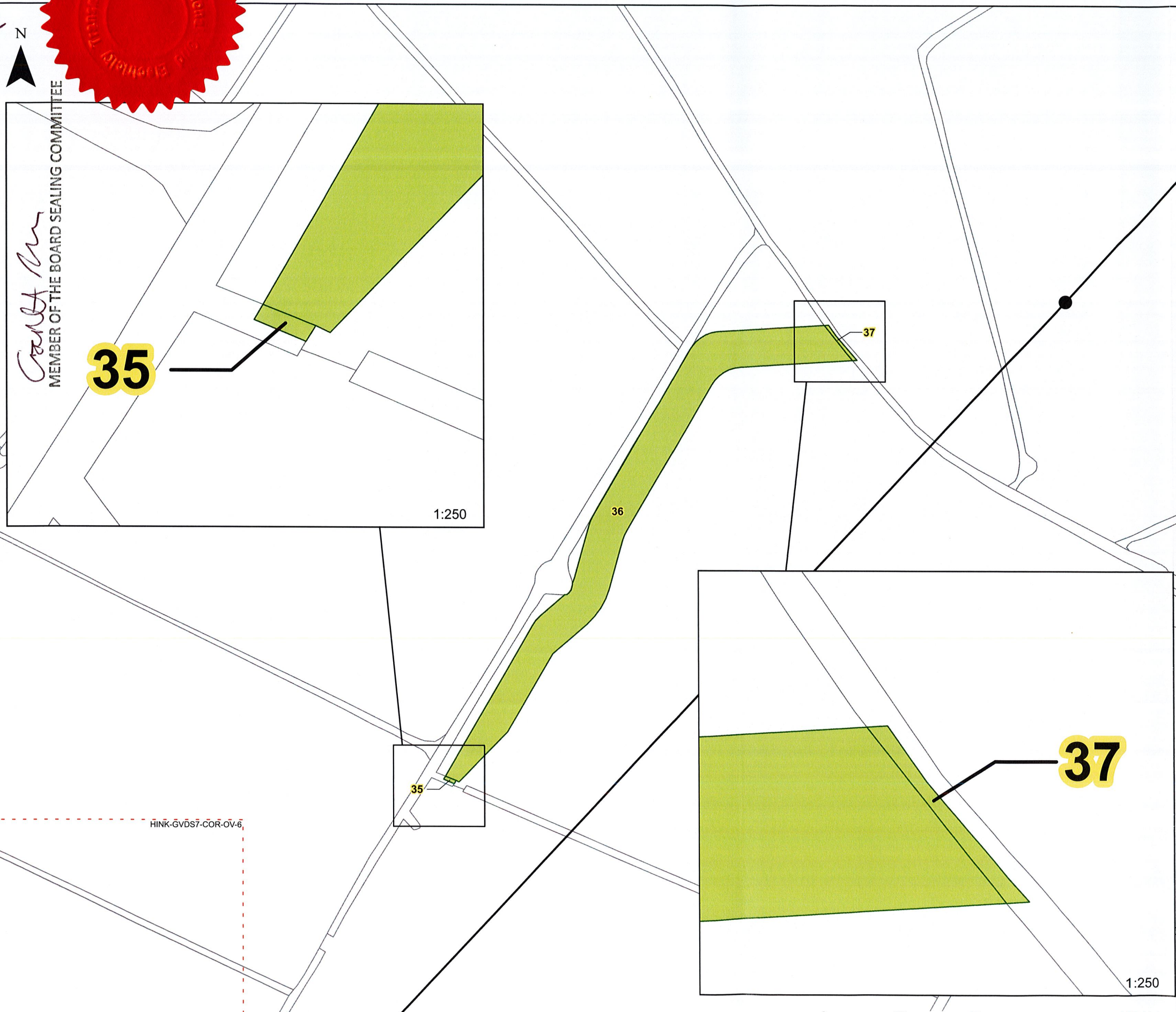

MEMBER OF THE BOARD SEALING COMMITTEE



nationalgrid

HINKLEY C CONNECTION PROJECT

Title: **STAGE 7 - GVD B1 CoR OVERVIEW**

Ref No: HINK-GVDS7-COR-OV-9 | Plan: 9 of 17

LEGEND

- GVD Plan Outlines
- Overhead Rights and Restrictions
- Access Rights and Restrictions
- Overhead Line
- Pylons

Coordinate System: British National Grid
 Projection: Transverse Mercator
 Datum: OSGB 1938
 Units: Metre

Map Centre: 336080E 145640N

| Version: | Date: | Remarks: | Drawn: | Checked: |
|----------|------------|-----------|--------|----------|
| v2 | 14/08/2023 | Published | JK | SM |

SCALE: 1:1,250 | PAPER SIZE: A3

Notes:
 This drawing is scaled at paper size A3, therefore any prints taken at different sizes will affect the accuracy of the measurement units and should not be scaled against.

BK Bruton Knowles

The design, scale and layout shown on this plan are indicative. The dimensions for the apparatus are typical dimensions, and the actual apparatus to be provided may differ in style, model and size.
 BACKGROUND MAPPING INFORMATION HAS BEEN REPRODUCED FROM THE ORDNANCE SURVEY ON BEHALF OF THE CONTROLLER OF HER MAJESTY'S STATIONARY OFFICE. © CROWN COPYRIGHT ORDNANCE SURVEY NATIONAL GRID LICENSE NO. 100022488

DALLAH

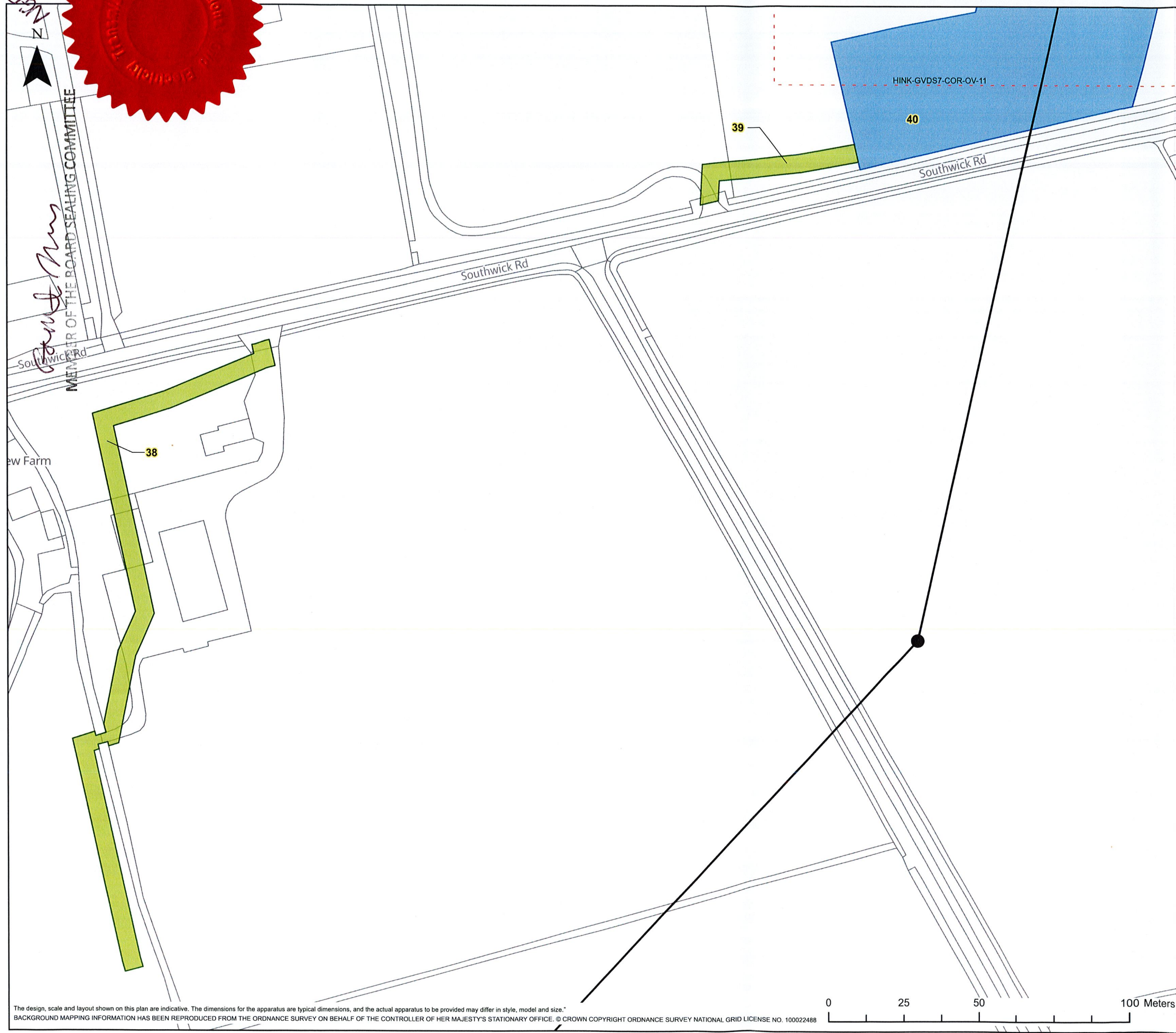

nationalgrid

HINKLEY C CONNECTION PROJECT

Title
STAGE 7 - GVD B1 CoR OVERVIEW

Ref No: HINK-GVDS7-COR-OV-10 Plan: 10 of 17

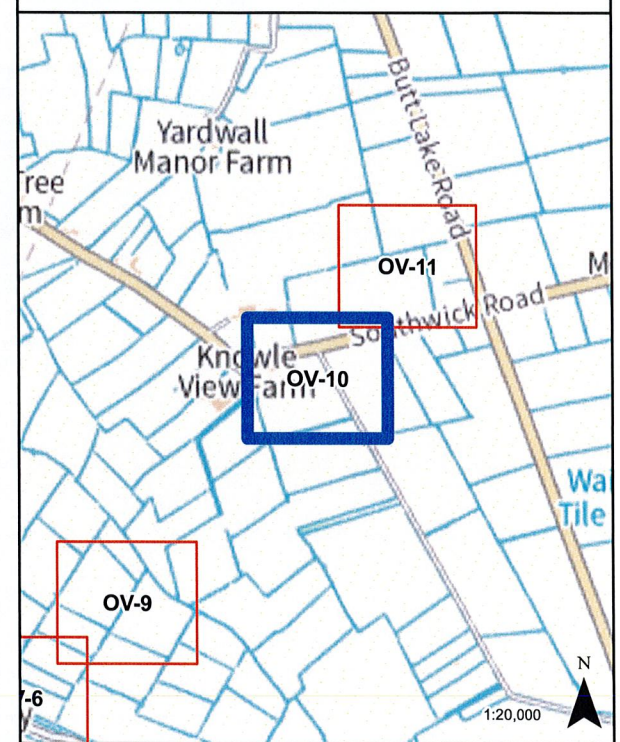

LEGEND

- GVD Plan Outlines
- Overhead Rights and Restrictions
- Access Rights and Restrictions
- Overhead Line
- Pylons

| | | | | |
|---|------------|--------------------------------|--------|----------|
| Coordinate System: British National Grid Projection: Transverse Mercator Datum: OSGB 1938 Units: Metre | | Map Centre: 336613E 146270N | | |
| Version: | Date: | Remarks: | Drawn: | Checked: |
| v2 | 10/08/2023 | Published | JK | SM |

| | | | |
|--------|---------|-------------|----|
| SCALE: | 1:1,250 | PAPER SIZE: | A3 |
| Notes: | | | |

The design, scale and layout shown on this plan are indicative. The dimensions for the apparatus are typical dimensions, and the actual apparatus to be provided may differ in style, model and size. BACKGROUND MAPPING INFORMATION HAS BEEN REPRODUCED FROM THE ORDNANCE SURVEY ON BEHALF OF THE CONTROLLER OF HER MAJESTY'S STATIONARY OFFICE. © CROWN COPYRIGHT ORDNANCE SURVEY NATIONAL GRID LICENSE NO. 100022488



27/11/23

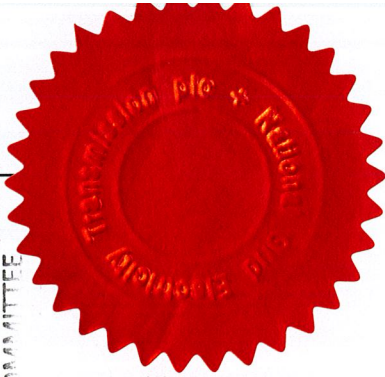

MEMBER OF THE BOARD SEALING COMMITTEE

MEMBER OF THE BOARD SEALING COMMITTEE

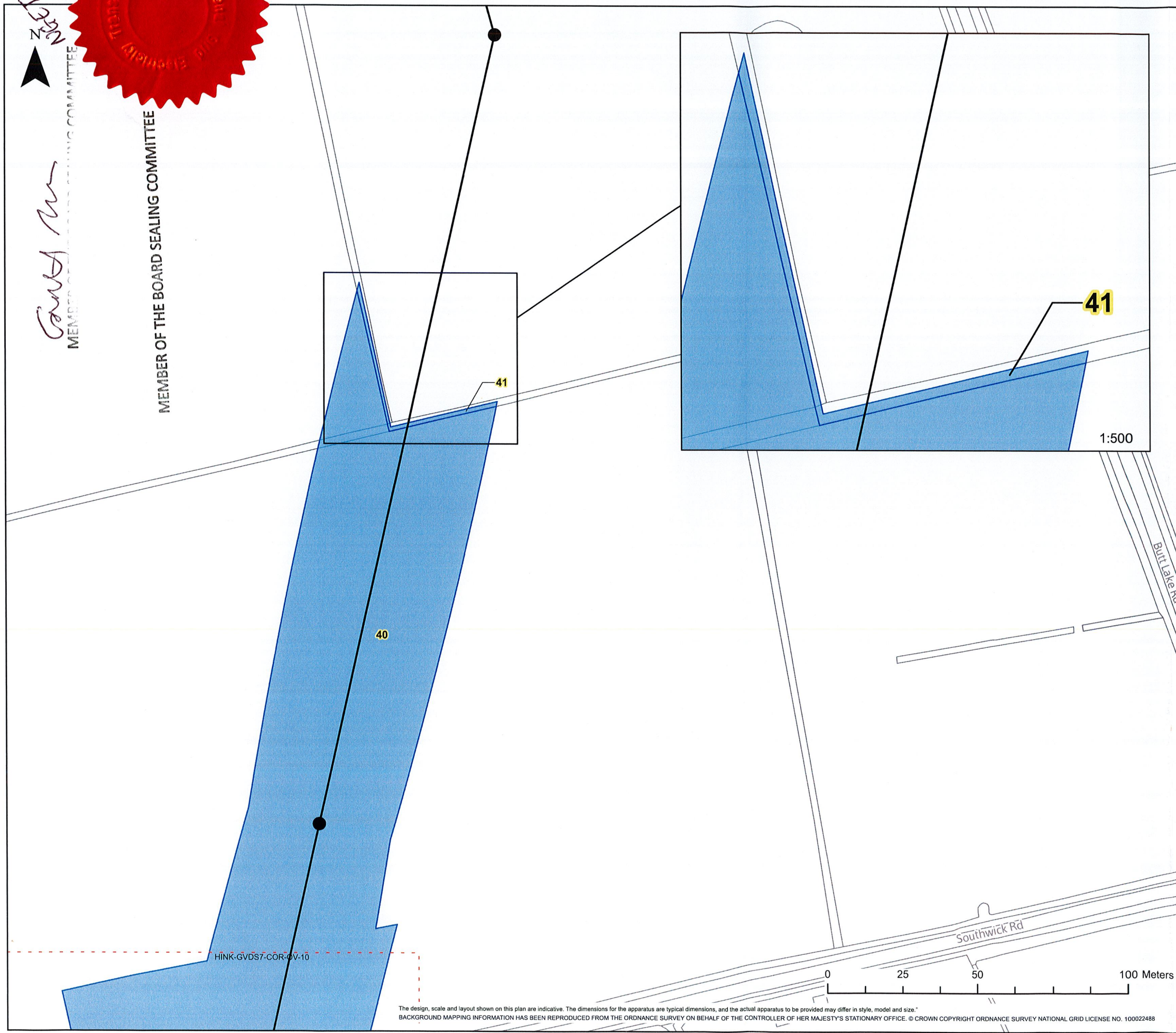

nationalgrid

HINKLEY C CONNECTION PROJECT

Title
STAGE 7 - GVD B1 CoR OVERVIEW

Ref No: HINK-GVDS7-COR-OV-11 Plan: 11 of 17

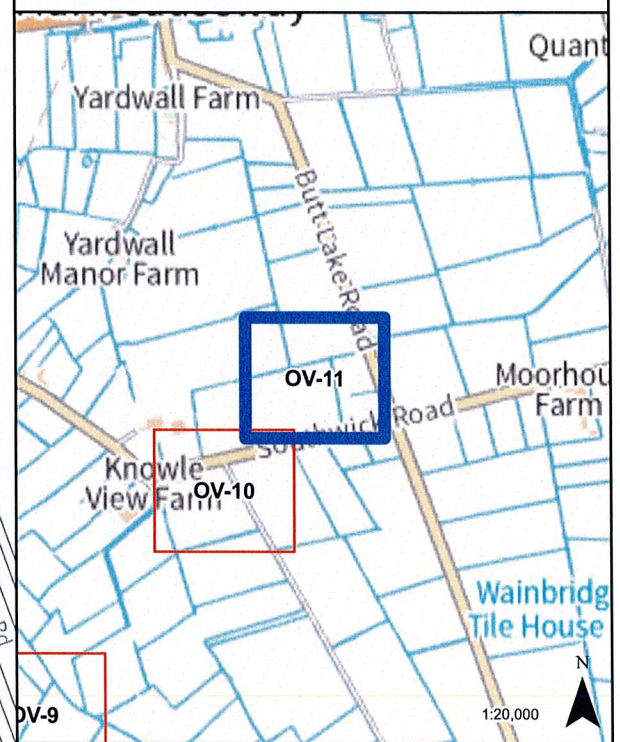

LEGEND

- GVD Plan Outlines
- Overhead Rights and Restrictions
- Access Rights and Restrictions
- Overhead Line
- Pylons

Coordinate System: British National Grid
 Projection: Transverse Mercator
 Datum: OSGB 1938
 Units: Metre

Map Centre:
 336869E 146585N

| Version: | Date: | Remarks: | Drawn: | Checked: |
|----------|------------|-----------|--------|----------|
| v2 | 10/08/2023 | Published | JK | SM |

SCALE: 1:1,250 PAPER SIZE: A3

Notes:
 This drawing is scaled at paper size A3, therefore any prints taken at different sizes will affect the accuracy of the measurement units and should not be scaled against.



The design, scale and layout shown on this plan are indicative. The dimensions for the apparatus are typical dimensions, and the actual apparatus to be provided may differ in style, model and size.
 BACKGROUND MAPPING INFORMATION HAS BEEN REPRODUCED FROM THE ORDNANCE SURVEY ON BEHALF OF THE CONTROLLER OF HER MAJESTY'S STATIONARY OFFICE. © CROWN COPYRIGHT ORDNANCE SURVEY NATIONAL GRID LICENSE NO. 100022488



North Arrow
N

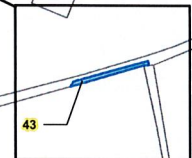
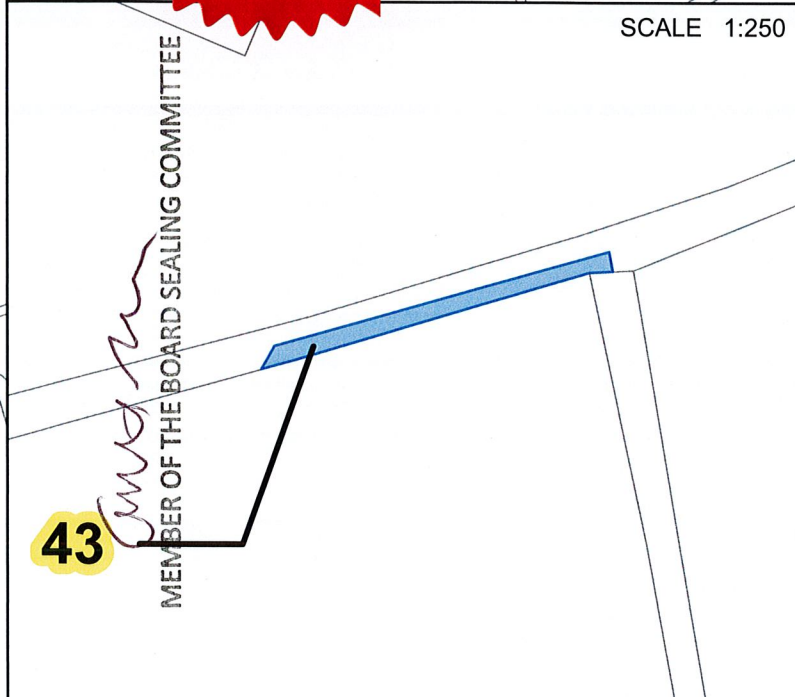

nationalgrid

HINKLEY C CONNECTION PROJECT

Title
STAGE 7 - GVD B1 CoR OVERVIEW

| | |
|-------------------------------|-------------------|
| Ref No: HINK-GVDS7B1-OV-12 | Plan: 12 of 17 |
|-------------------------------|-------------------|

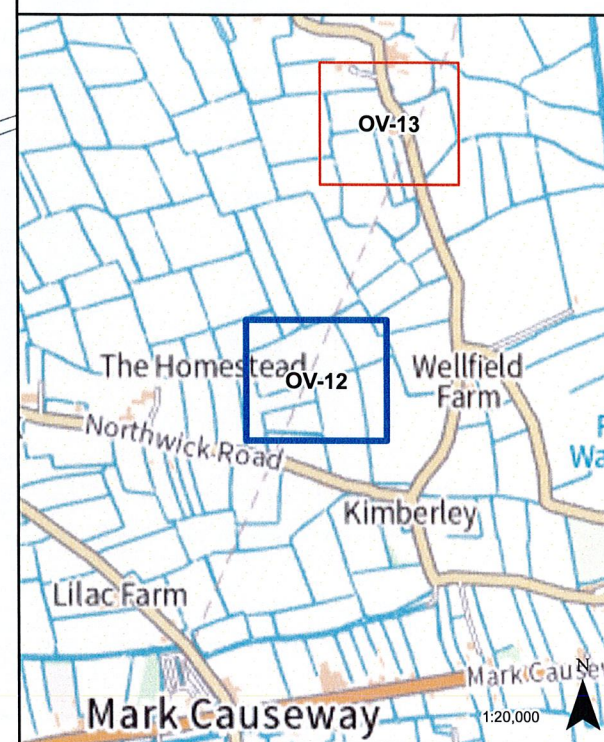

LEGEND

- GVD Plan Outlines
- Overhead Rights and Restrictions
- Access Rights and Restrictions
- Overhead Line
- Pylons

| | |
|---|--------------------------------|
| Coordinate System: British National Grid Projection: Transverse Mercator Datum: OSGB 1938 Units: Metre | Map Centre: 336681E 148578N |
|---|--------------------------------|

| Version: | Date: | Remarks: | Drawn: | Checked: |
|----------|------------|-----------|--------|----------|
| v2 | 10/10/2023 | Published | GM | SM |

| | |
|----------------|----------------|
| SCALE: 1:1,250 | PAPER SIZE: A3 |
|----------------|----------------|

Notes:
This drawing is scaled at paper size A3, therefore any prints taken at different sizes will affect the accuracy of the measurement units and should not be scaled against.



The design, scale and layout shown on this plan are indicative. The dimensions for the apparatus are typical dimensions, and the actual apparatus to be provided may differ in style, model and size.
BACKGROUND MAPPING INFORMATION HAS BEEN REPRODUCED FROM THE ORDNANCE SURVEY ON BEHALF OF THE CONTROLLER OF HER MAJESTY'S STATIONARY OFFICE. © CROWN COPYRIGHT ORDNANCE SURVEY NATIONAL GRID LICENSE NO. 100022488

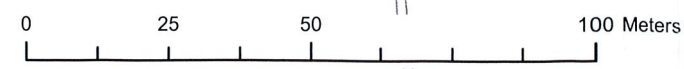

02/11/20



MEMBER OF THE BOARD SEALING COMMITTEE



nationalgrid

HINKLEY C CONNECTION PROJECT

Title
STAGE 7 - GVD B1 CoR OVERVIEW

Ref No: HINK-GVDS7-COR-OV-13 Plan: 13 of 17

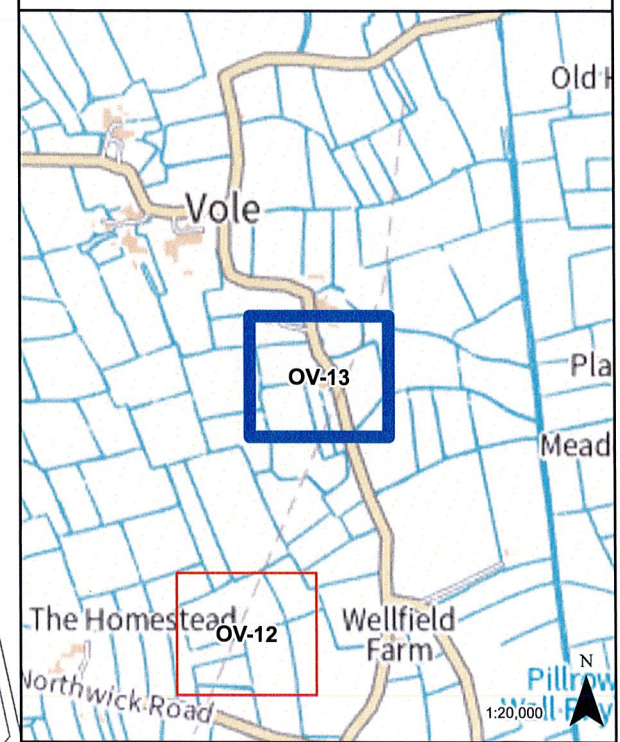

LEGEND

- GVD Plan Outlines
- Overhead Rights and Restrictions
- Access Rights and Restrictions
- Overhead Line
- Pylons

| | |
|---|--------------------------------|
| Coordinate System: British National Grid Projection: Transverse Mercator Datum: OSGB 1938 Units: Metre | Map Centre: 336888E 149299N |
|---|--------------------------------|

| Version: | Date: | Remarks: | Drawn: | Checked: |
|----------|------------|-----------|--------|----------|
| v2 | 10/08/2023 | Published | JK | SM |

| | |
|----------------|----------------|
| SCALE: 1:1,250 | PAPER SIZE: A3 |
|----------------|----------------|

Notes:
This drawing is scaled at paper size A3, therefore any prints taken at different sizes will affect the accuracy of the measurement units and should not be scaled against.



The design, scale and layout shown on this plan are indicative. The dimensions for the apparatus are typical dimensions, and the actual apparatus to be provided may differ in style, model and size.
BACKGROUND MAPPING INFORMATION HAS BEEN REPRODUCED FROM THE ORDNANCE SURVEY ON BEHALF OF THE CONTROLLER OF HER MAJESTY'S STATIONARY OFFICE. © CROWN COPYRIGHT ORDNANCE SURVEY NATIONAL GRID LICENSE NO. 100022488



MEMBER OF THE BOARD SEALING COMMITTEE

HINK-GVDS7-COR-OV-15

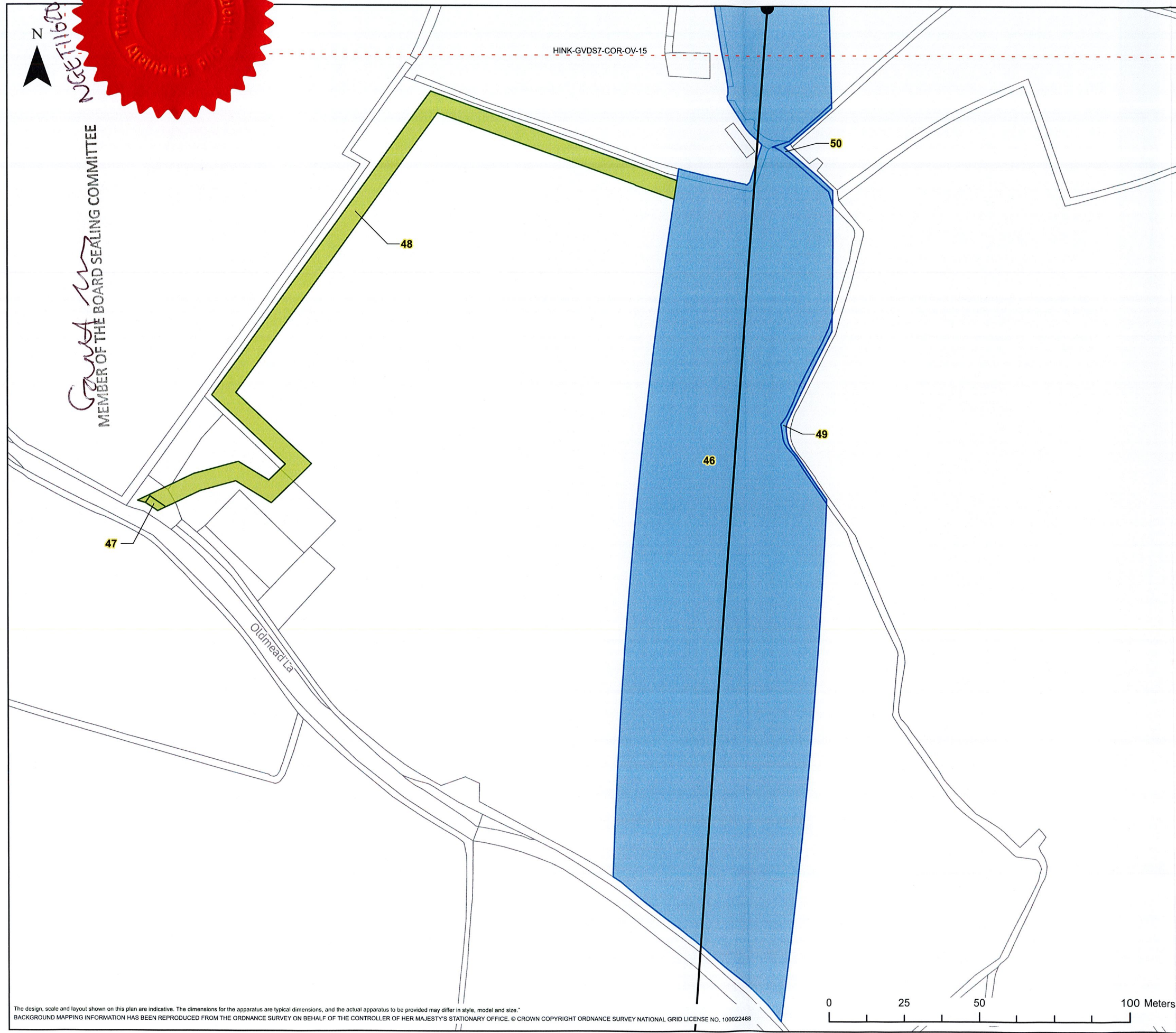

nationalgrid

HINKLEY C CONNECTION PROJECT

Title
STAGE 7 - GVD B1 CoR OVERVIEW

Ref No: HINK-GVDS7-COR-OV-14 Plan: 14 of 17

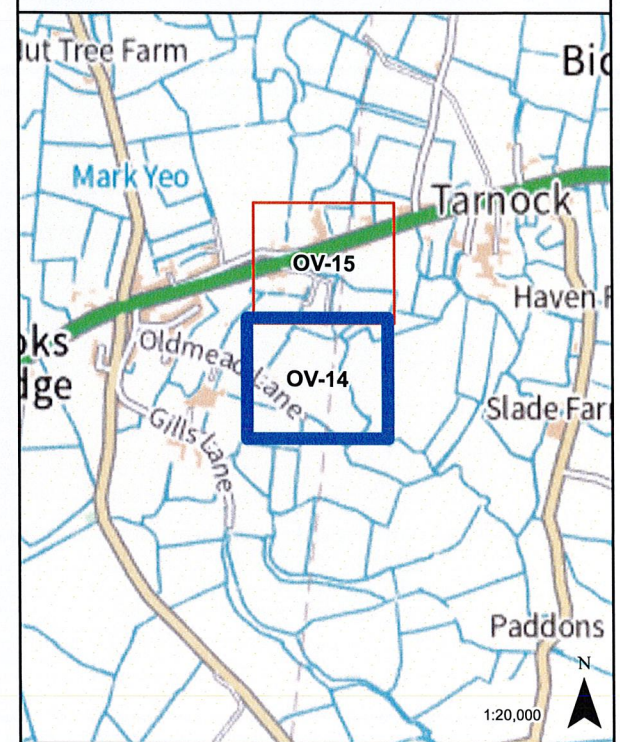

LEGEND

- GVD Plan Outlines
- Overhead Rights and Restrictions
- Access Rights and Restrictions
- Overhead Line
- Pylons

| | |
|---|--------------------------------|
| Coordinate System: British National Grid Projection: Transverse Mercator Datum: OSGB 1938 Units: Metre | Map Centre: 337328E 152118N |
|---|--------------------------------|

| Version: | Date: | Remarks: | Drawn: | Checked: |
|----------|------------|-----------|--------|----------|
| v2 | 10/08/2023 | Published | JK | SM |

| | |
|-----------------------|-----------------------|
| SCALE: 1:1,250 | PAPER SIZE: A3 |
|-----------------------|-----------------------|

Notes:
This drawing is scaled at paper size A3, therefore any prints taken at different sizes will affect the accuracy of the measurement units and should not be scaled against.



The design, scale and layout shown on this plan are indicative. The dimensions for the apparatus are typical dimensions, and the actual apparatus to be provided may differ in style, model and size.
BACKGROUND MAPPING INFORMATION HAS BEEN REPRODUCED FROM THE ORDNANCE SURVEY ON BEHALF OF THE CONTROLLER OF HER MAJESTY'S STATIONARY OFFICE. © CROWN COPYRIGHT ORDNANCE SURVEY NATIONAL GRID LICENSE NO. 100022488



NGET11600

MEMBER OF THE BOARD SEALING COMMITTEE



nationalgrid

HINKLEY C CONNECTION PROJECT

Title
STAGE 7 - GVD B1 CoR OVERVIEW

Ref No: HINK-GVDS7-COR-OV-15 Plan: 15 of 17

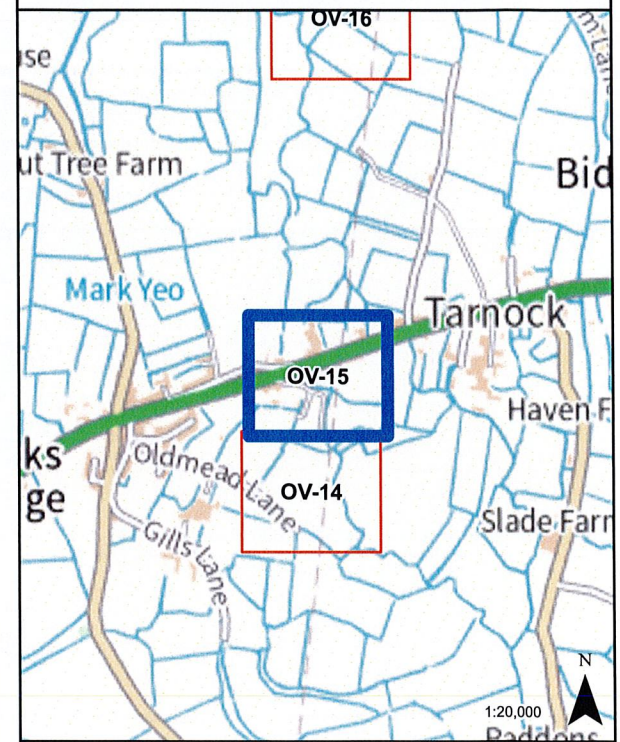

LEGEND

- GVD Plan Outlines
- Overhead Rights and Restrictions
- Access Rights and Restrictions
- Overhead Line
- Pylons

Coordinate System: British National Grid
Projection: Transverse Mercator
Datum: OSGB 1938
Units: Metre
Map Centre: 337348E 152442N

| Version: | Date: | Remarks: | Drawn: | Checked: |
|----------|------------|-----------|--------|----------|
| v2 | 10/08/2023 | Published | JK | SM |

SCALE: 1:1,250 PAPER SIZE: A3

Notes:
This drawing is scaled at paper size A3, therefore any prints taken at different sizes will affect the accuracy of the measurement units and should not be scaled against.



The design, scale and layout shown on this plan are indicative. The dimensions for the apparatus are typical dimensions, and the actual apparatus to be provided may differ in style, model and size.
BACKGROUND MAPPING INFORMATION HAS BEEN REPRODUCED FROM THE ORDNANCE SURVEY ON BEHALF OF THE CONTROLLER OF HER MAJESTY'S STATIONARY OFFICE. © CROWN COPYRIGHT ORDNANCE SURVEY NATIONAL GRID LICENSE NO. 100022488

NGET 11600



MEMBER OF THE BOARD SEALING COMMITTEE

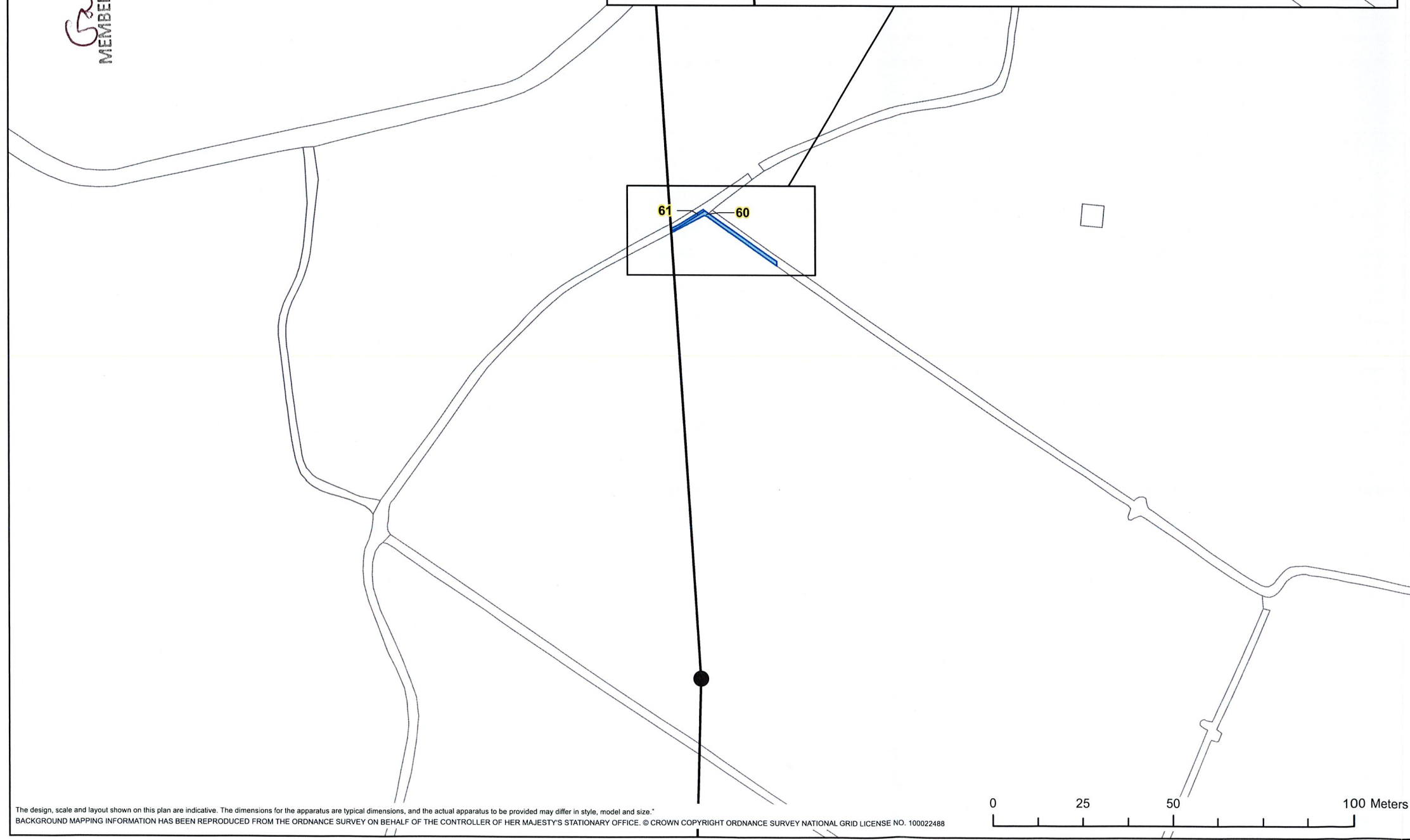
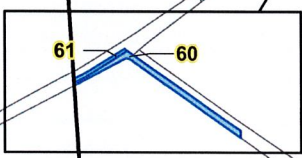
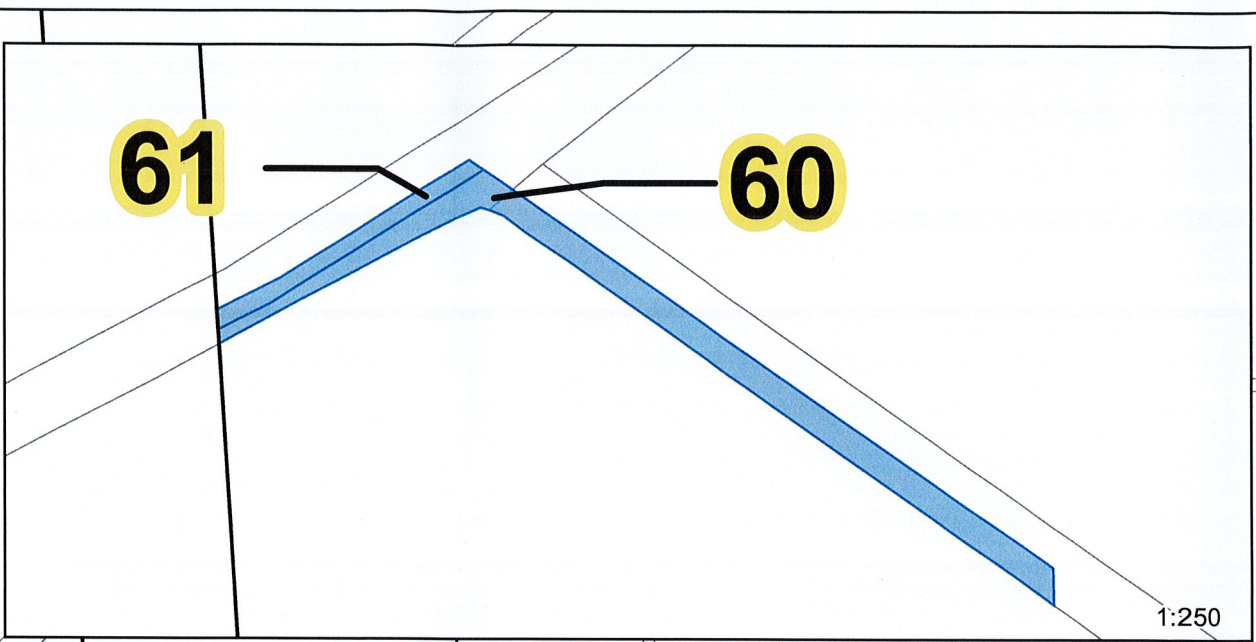

nationalgrid

HINKLEY C CONNECTION PROJECT

Title
STAGE 7 - GVD B1 CoR OVERVIEW

Ref No: HINK-GVDS7-COR-OV-16 Plan: 16 of 17

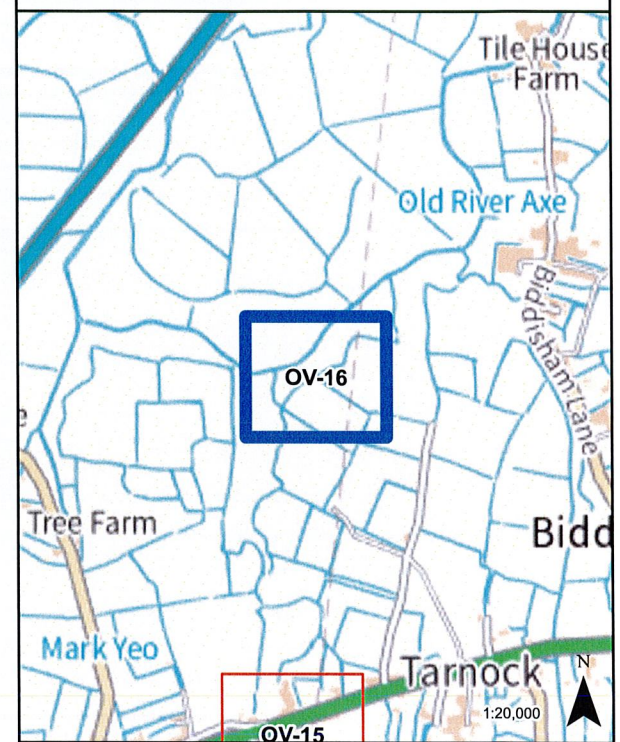

LEGEND

- GVD Plan Outlines
- Overhead Rights and Restrictions
- Access Rights and Restrictions
- Overhead Line
- Pylons

| | |
|---|--------------------------------|
| Coordinate System: British National Grid Projection: Transverse Mercator Datum: OSGB 1938 Units: Metre | Map Centre: 337418E 153446N |
|---|--------------------------------|

| Version: | Date: | Remarks: | Drawn: | Checked: |
|----------|------------|-----------|--------|----------|
| v2 | 10/08/2023 | Published | JK | SM |

| | |
|----------------|----------------|
| SCALE: 1:1,250 | PAPER SIZE: A3 |
|----------------|----------------|

Notes:
This drawing is scaled at paper size A3, therefore any prints taken at different sizes will affect the accuracy of the measurement units and should not be scaled against.



The design, scale and layout shown on this plan are indicative. The dimensions for the apparatus are typical dimensions, and the actual apparatus to be provided may differ in style, model and size. BACKGROUND MAPPING INFORMATION HAS BEEN REPRODUCED FROM THE ORDNANCE SURVEY ON BEHALF OF THE CONTROLLER OF HER MAJESTY'S STATIONARY OFFICE. © CROWN COPYRIGHT ORDNANCE SURVEY NATIONAL GRID LICENSE NO. 100022488

N
N 162° 10'



Gavin M
MEMBER OF THE BOARD SEALING COMMITTEE

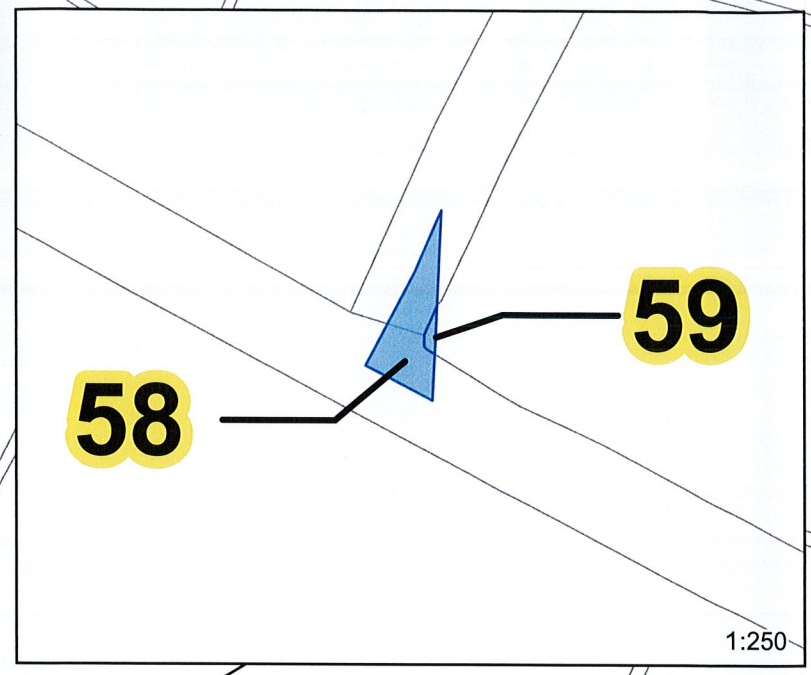
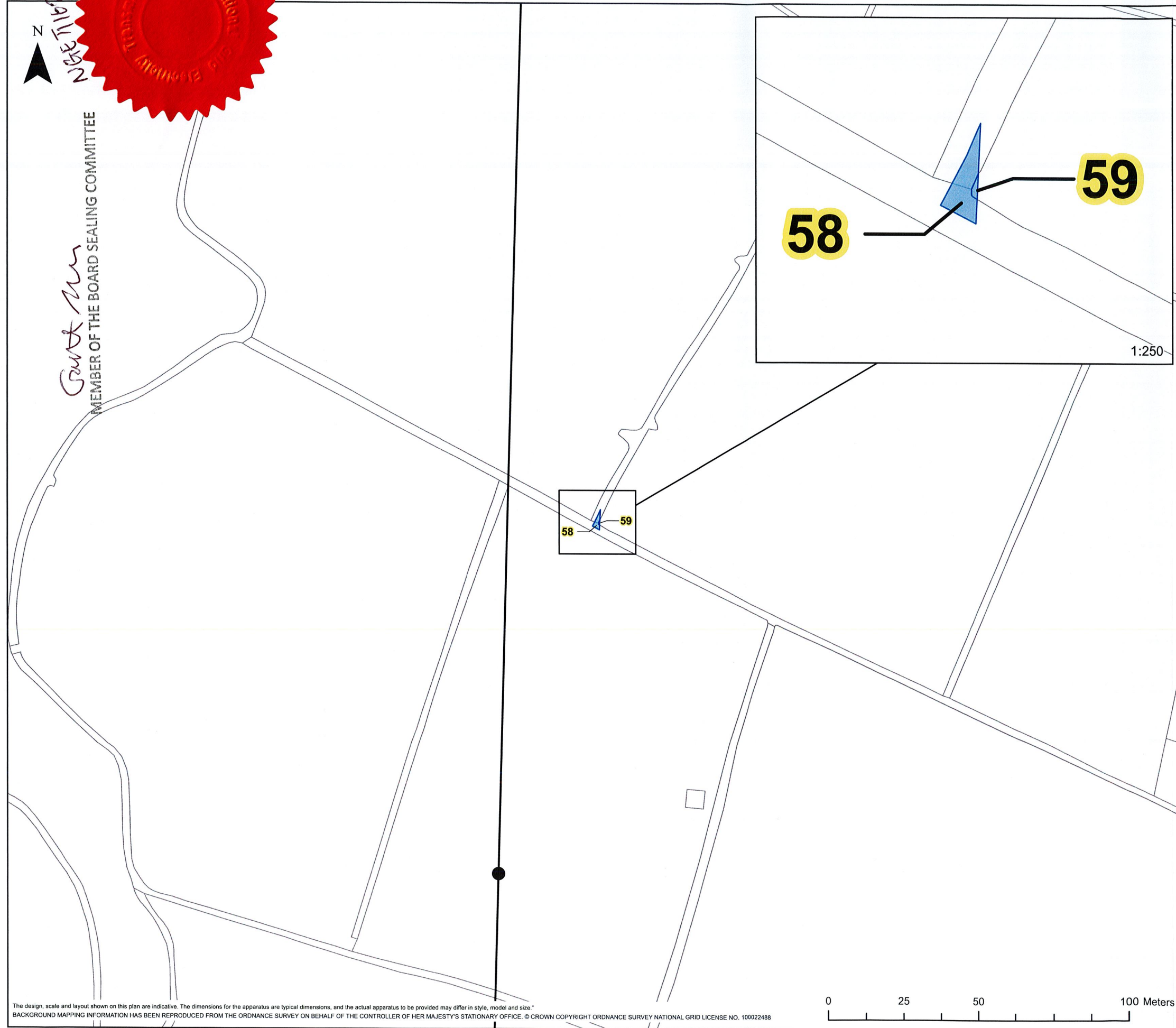

| | |
|--|--------------------------------|
| nationalgrid | |
| HINKLEY C CONNECTION PROJECT | |
| Title STAGE 7 - GVD B1 CoR OVERVIEW | |
| Ref No: HINK-GVDS7-COR-OV-17 | Plan: 17 of 17 |
| | |
| LEGEND | |
| Coordinate System: British National Grid Projection: Transverse Mercator Datum: OSGB 1938 Units: Metre | Map Centre: 337437E 153076N |
| Version: v2 | Date: 07/09/2023 |
| Remarks: Published | Drawn: JK |
| | Checked: SM |
| SCALE: 1:1,250 | PAPER SIZE: A3 |
| Notes: This drawing is scaled at paper size A3, therefore any prints taken at different sizes will affect the accuracy of the measurement units and should not be scaled against. | BK Bruton Knowles |

The design, scale and layout shown on this plan are indicative. The dimensions for the apparatus are typical dimensions, and the actual apparatus to be provided may differ in style, model and size.
BACKGROUND MAPPING INFORMATION HAS BEEN REPRODUCED FROM THE ORDNANCE SURVEY ON BEHALF OF THE CONTROLLER OF HER MAJESTY'S STATIONARY OFFICE. © CROWN COPYRIGHT ORDNANCE SURVEY NATIONAL GRID LICENSE NO. 100022488

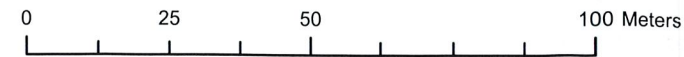

The common seal of NATIONAL GRID)
ELECTRICITY TRANSMISSION PLC was)
hereunto affixed in the presence of:)

Grant Ryan

.....
Authorised Signatory
Member of Board Sealing Committee

