

Issue number: BT-BB-020631-560-0004

Bramford to Twinstead Reinforcement

3.3.1 Typical Design and Layout Plans:
Grid Supply Point Substation

January 2022



nationalgrid

Page left blank for printing purposes

- NOTES**
1. All dimensions are in millimetres unless noted otherwise.
 2. All levels and chainages are in metres unless noted otherwise.
 3. Underground Services are not currently shown on this drawing but will be incorporated following the GPR survey.
 4. The precise position of above ground feature are indicative only and shall be verified following a topographical survey.

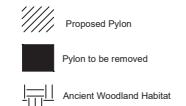

ISSUE	P03	Remarks:
DRAWN	CDW	ISSUED FOR STATUTORY CONSULTATION
DESIGN / D.C.	-	
CHKD	DA	
APPD	JE	
DATE	27/07/2021	
ISSUE	P02	Remarks:
DRAWN	CDW	ISSUE FOR COMMENT
DESIGN / D.C.	-	
CHKD	DA	
APPD	JE	
DATE	08/06/2021	
ISSUE	P01	Remarks:
DRAWN	CDW	DRAFT ISSUE FOR COMMENT
DESIGN / D.C.	-	
CHKD	DA	
APPD	JE	
DATE	10/05/2021	

Project
BRAMFORD TO TWINSTEAD

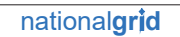

Title
3.3.1a Typical Design and Layout Plans: Grid Supply Point Substation Layout

Circuit / Site	Bramford - Pelham - Braintree - Rayleigh	ACAD
Originator Drawing No.	B31000F9-JAC-ZZ-XX-DR-E-0001	A1
NG Drawing No.	BT-BB-020631-560-0004	P03
Scale	AS STATED	
Sheet No.	1	No. of Sheets 1

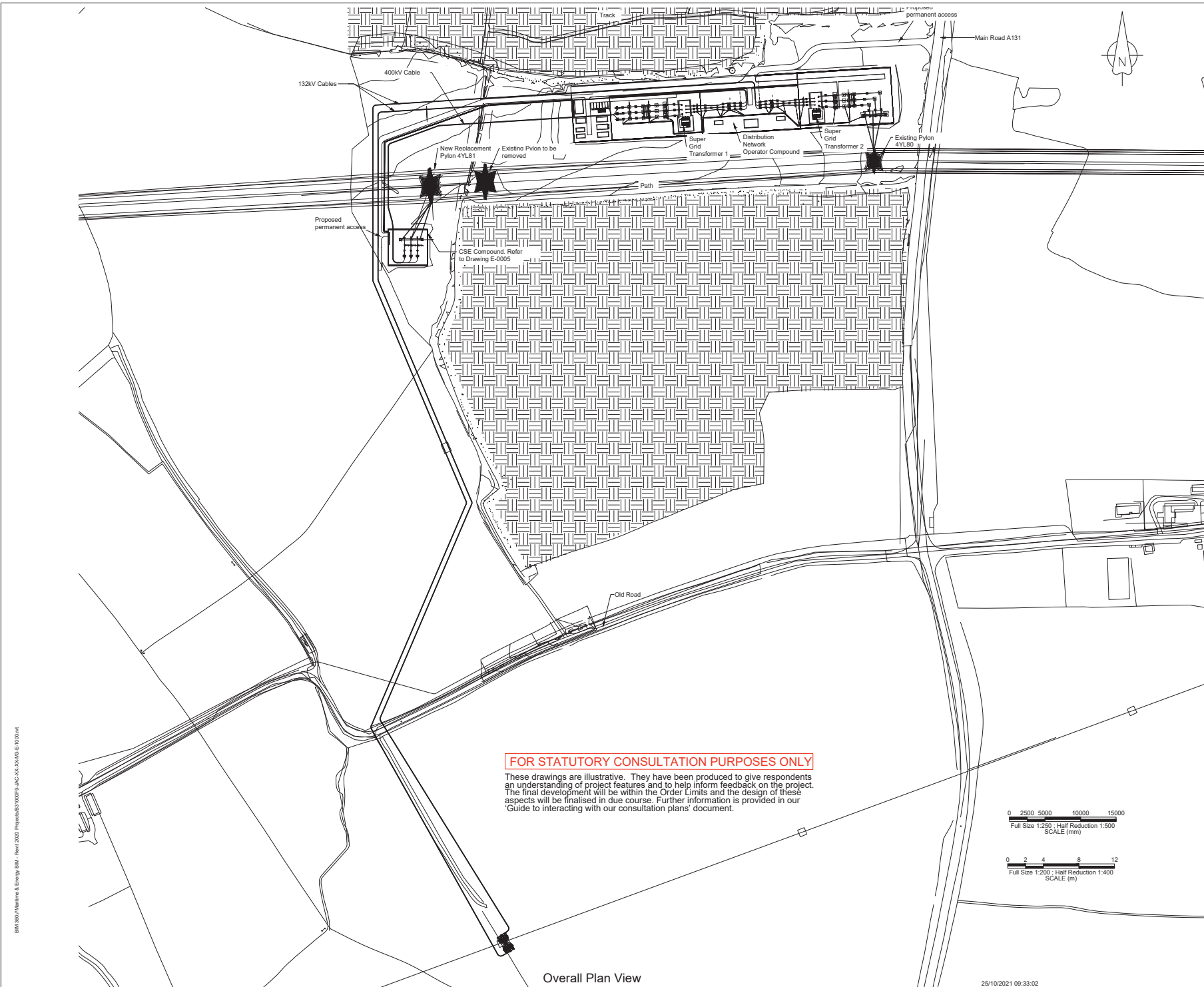

B31 3001/Maritime & Energy/B31 - Rev 2020 Project/B31000F9-JAC-ZZ-XX-DR-E-0001

Overall Plan View
SCALE: 1:500

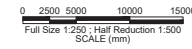

25/10/2021 09:33:02

NOTES

1. All dimensions are in millimetres unless noted otherwise.
2. All levels and chainages are in metres unless noted otherwise.
3. Underground Services are not currently shown on this drawing but will be incorporated following the GPR survey.
4. The precise position of above ground feature are indicative only and shall be verified following a topographical survey.

----- Existing ground level to be modified

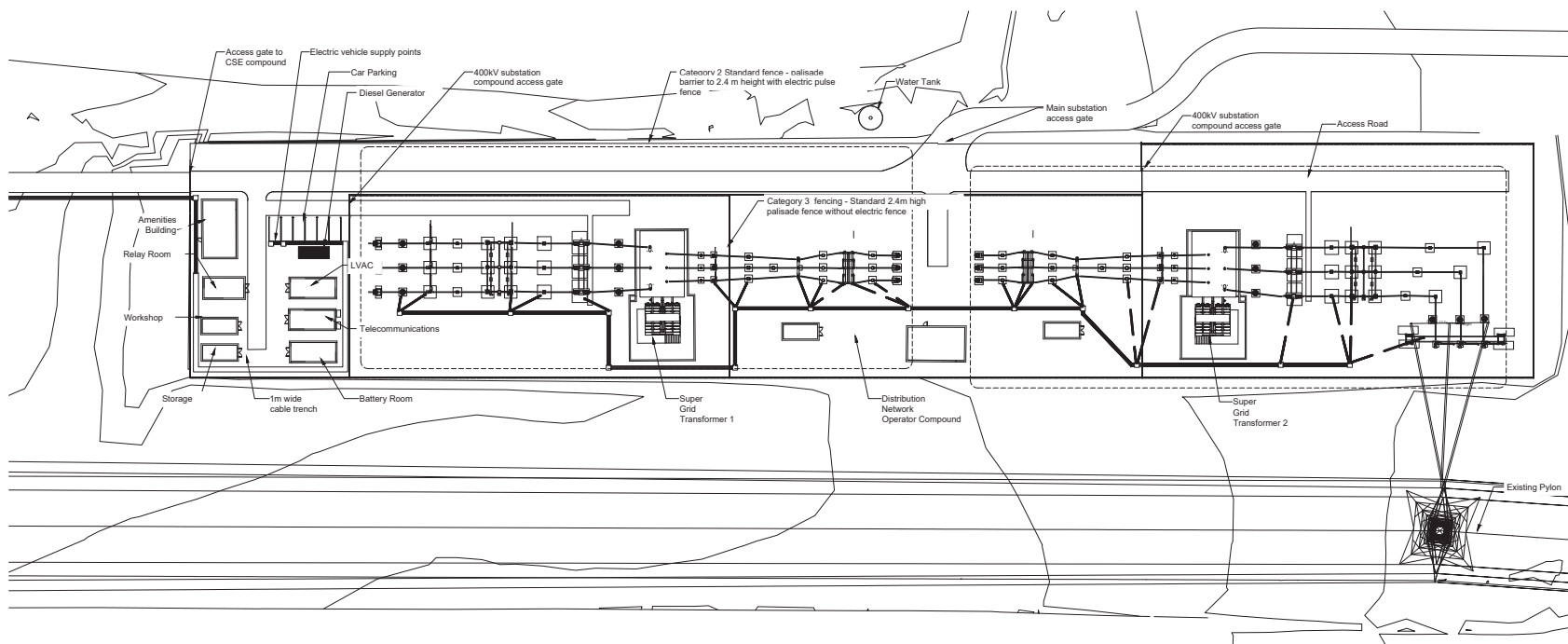

SUBSTATION PLAN VIEW

SCALE 1 : 500

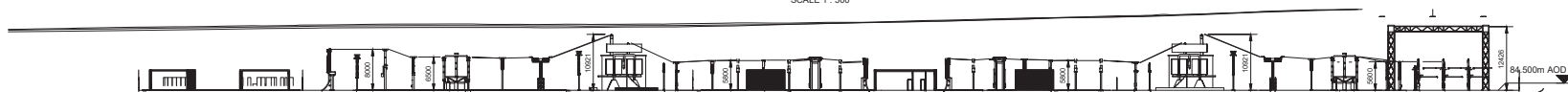

SECTION B-B

SCALE 1 : 500

FOR STATUTORY CONSULTATION PURPOSES ONLY

These drawings are illustrative. They have been produced to give respondents an understanding of project features and to help inform feedback on the project. The final development will be within the Order Limits and the design of these aspects will be finalised in due course. Further information is provided in our 'Guide to interacting with our consultation plans' document.



ISSUE	P04	Remarks:
DRAWN	CDW	DIMENSIONS ADDED
DESIGN / D.O.	-	
CHKD	DA	
APPD	JE	
DATE	16/11/2021	
ISSUE	P03	Remarks:
DRAWN	CDW	ISSUED FOR STATUTORY CONSULTATION
DESIGN / D.O.	-	
CHKD	DA	
APPD	JE	
DATE	27/07/2021	
ISSUE	P02	Remarks:
DRAWN	CDW	ISSUE FOR COMMENT
DESIGN / D.O.	-	
CHKD	DA	
APPD	JE	
DATE	08/06/2021	
ISSUE	P01	Remarks:
DRAWN	CDW	DRAFT ISSUE FOR COMMENT
DESIGN / D.O.	-	
CHKD	DA	
APPD	JE	
DATE	10/05/2021	

BRAMFORD TO TWINSTEAD



Title
3.3.1b Typical design and layout plans: grid supply point substation elevations

Client / Site	Bramford - Pelham - Braintree - Rayleigh	ACAD
Originator Drawing No.	B31000F9-JAC-ZZ-XX-DR-E-0002	A1
NG Drawing No.	BT-BB-020631-560-0005	P04
Scale	AS STATED	



NOTES

1. All dimensions are in millimetres unless noted otherwise.
2. All levels and chainages are in metres unless noted otherwise.
3. Underground Services are not currently shown on this drawing but will be incorporated following the GPR survey.
4. The precise position of above ground feature are indicative only and shall be verified following a topographical survey.

CB	Circuit Breaker
CT	Current Transformer
CVT	Capacitor Voltage Transformer
CSE	Cable Sealing End
DISC	Disconnector
ESW	Earth Switch
HAM	High Accuracy Metering Unit
PI	Post Insulator
SA	Surge Arrester
SST1 & 2	Supergrid Transformer

_____ - Existing ground level to be modified

ISSUE	P04	Remarks:
DRAWN	CDW	ADDED DIMENSIONS
DESIGN / D.O.	-	
CHKD	DA	
APPD	JE	
DATE	12/08/2021	NG Investment No. 21847

ISSUE	P03	Remarks:
DRAWN	CDW	ISSUED FOR STATUTORY CONSULTATION
DESIGN / D.O.	-	
CHKD	DA	
APPD	JE	
DATE	27/07/2021	NG Investment No. 21847

ISSUE	P02	Remarks:
DRAWN	CDW	ISSUED FOR COMMENT
DESIGN / D.O.	-	
CHKD	DA	
APPD	JE	
DATE	08/06/2021	NG Investment No. 21847

ISSUE	P01	Remarks:
DRAWN	CDW	FIRST ISSUE FOR COMMENT
DESIGN / D.O.	-	
CHKD	DA	
APPD	JE	
DATE	10/05/2021	NG Investment No. 21847

Project
BRAMFORD TO TWINSTEAD



Title
3.3.1c Typical design and layout plans: grid supply point substation single circuit cable sealing end compound

Circuit / Site	Bramford - Pelham - Braintree - Rayleigh	ACAD
Originator Drawing No.	B31000F9-JAC-ZZ-XX-DR-E-0005	A1
NG Drawing No.	BT-BB-020631-560-0006	P04
Scale	AS STATED	
Sheet No.	1	No. of Sheets

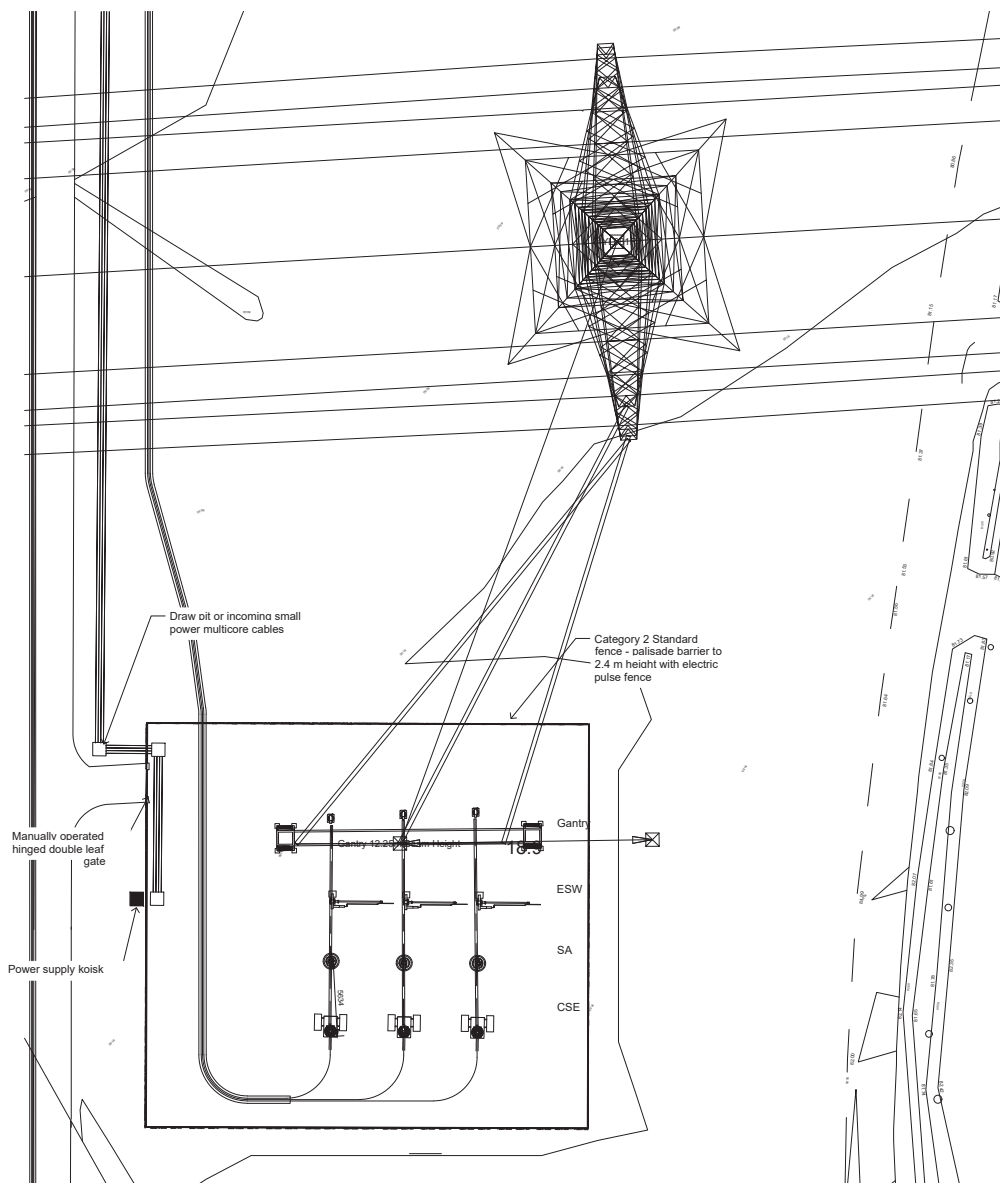

Single circuit cable sealing end compound plan view
SCALE 1:200

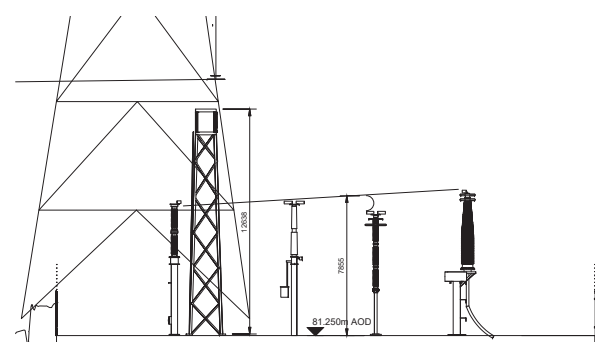

Single circuit cable sealing end compound elevation view
SCALE 1:150

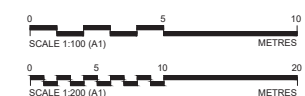

FOR STATUTORY CONSULTATION PURPOSES ONLY

These drawings are illustrative. They have been produced to give respondents an understanding of project features and to help inform feedback on the project. The final development will be within the Order Limits and the design of these aspects will be finalised in due course. Further information is provided in our 'Guide to interacting with our consultation plans' document.

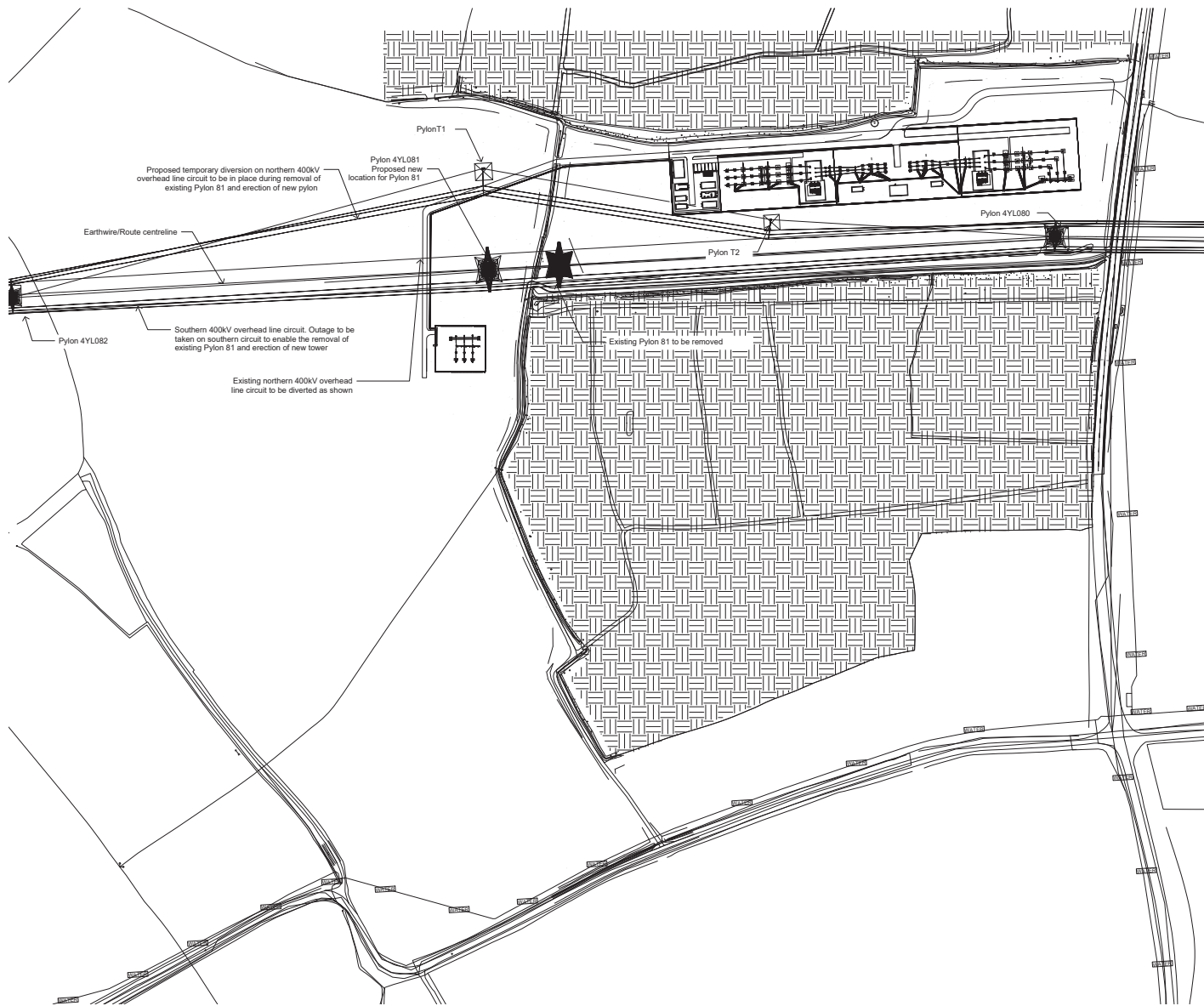





Plan
SCALE 1 : 1500

FOR STATUTORY CONSULTATION PURPOSES ONLY

These drawings are illustrative. They have been produced to give respondents an understanding of project features and to help inform feedback on the project. The final development will be within the Order Limits and the design of these aspects will be finalised in due course. Further information is provided in our 'Guide to interacting with our consultation plans' document.

NOTES

1. All dimensions are in millimetres unless noted otherwise.
2. All levels and chainages are in metres unless noted otherwise.
3. Underground Services are not currently shown on this drawing but will be incorporated following the GPR survey.
4. The precise position of above ground feature are indicative only and shall be verified following a topographical survey.

-  Proposed Pylon
-  Pylon to be removed
-  Ancient Woodland Habitat
-  Southern Circuit
-  Northern Circuit
-  Northern Circuit (Temporary Diversion)
-  Earthwire/Route Centreline

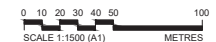

ISSUE	P01	Remarks:
DRAWN	CDW	ISSUED FOR STATUTORY CONSULTATION
DESIGN / D.C.	-	
CHKD	AH	
APPD	JE	
DATE	24/07/2021	NG Investment No. 21847

Project
BRAMFORD TO TWINSTEAD



Title
3.3.1d Typical design and layout plans: grid supply point substation 400kv temporary overhead line diversion

Circuit / Site Bramford - Pelham - Braintree - Rayleigh	ACAD
---	------

Originator Drawing No.
B31000F9-JAC-ZZ-XX-DR-E-0006

NG Drawing No. BT-BB-020631-560-0007	Sheet No. 1	No. of Sheets 1	Issue P01
--	-----------------------	---------------------------	---------------------

Scale: AS STATED

Page left blank for printing purposes

National Grid plc
National Grid House,
Warwick Technology Park,
Gallows Hill, Warwick.
CV34 6DA United Kingdom

Registered in England and Wales
No. 4031152
nationalgrid.com